



Planning Department Development Application Form

Complete Application

A complete development application consists of the following:

1. A properly completed and signed application form (signature must be original in planners file);
2. Supporting information adequate to illustrate your proposal as indicated in **Section H** of this application form (plans are required in paper copy and digital PDF format);
3. Written authorization from the registered owner of the subject lands where the applicant is not the owner as per Section N; and,
4. Cash, debit or cheque payable to Norfolk County in the amount set out in the user fees By-Law.

The above information is required to ensure that your application is given full consideration. An incomplete or improperly prepared application will not be accepted and may result in delays during the processing of the application. This application must be typed or printed in ink and completed in full.

Pre-Submission Consultation “Pre-consultation”:

A pre-consultation meeting with staff is required for all applications; however, minor applications may be exempted depending on the nature of the proposal, with approval from the Director of Planning or delegate. The purpose of a pre-consultation meeting is to provide the applicant with an opportunity to present the proposed application, discuss potential issues, and for the County and Agency staff to identify the required information and materials to be submitted with the application in order for it to be considered complete. The applicant has the opportunity to make revisions to the application prior to submission, without the additional costs of recirculation fees. It may be necessary to seek the assistance of independent professional help (for example, a planning consultant or engineer) for complex applications. If a pre-consultation meeting has been held to discuss your development, please **include a copy of the Pre-consultation minutes with your application** as part of the submission package. It should be noted that **pre-consultation minutes are valid for one year after the meeting date.**

Development Application Process

Once an application has been deemed complete by a planner, it will be circulated to public agencies and County departments for review and comments. Notice of the application is also provided to adjacent land owners. The comments received assist the planner with the review and recommendation/approval of your application. The time involved in processing an application varies depending upon its complexity and its



acceptability to the other agencies and is subject to statutory *Planning Act* decision timeframes.

An additional fee will be required if a review by the Long Point Region Conservation Authority or by the Grand River Conservation Authority is deemed necessary by planning staff and/or by the Authority. A separate cheque payable to the Long Point Region Conservation Authority or the Grand River Conservation Authority is required in accordance with their fee schedule at the same time your application is submitted.

Additional studies required as part of the complete application shall be at the sole expense of the applicant. It should also be noted that in some instances peer reviews may be necessary to review particular studies and that the cost shall be at the expense of the applicant. The company to complete the peer review shall be selected by the County.

If the application is withdrawn prior to the circulation to commenting agencies, the entire original fee will be refunded. If withdrawn after the circulation to agencies, half the original fee will be refunded. If your drawings are required to be recirculated there will be an additional fee. Also, please note that if your engineering drawings require more than three reviews due to revisions by the owner or failure to revise your engineering drawings as requested, an additional fee will be charged. No refund is available after the public meeting and/or after approval of application.

Notification Sign Requirements

For the purpose of public notification and in order for staff to locate your lands for appropriate applications (zoning, subdivision, condominium or official plan) you will be given a sign to indicate the intent and purpose of your development application. It is your responsibility to:

1. Post one sign per frontage in a conspicuous location on the subject lands;
2. Ensure one sign is posted at the front of the subject lands at least three feet above ground level, not on a tree;
3. Notify the Planner when the sign is in place in order to avoid processing delays; and
4. Maintain the sign until the development application is finalized and thereafter removed.

Contact Us

For additional information or assistance in completing this application, please contact a planner at 519-426-5870 or 519-875-4485 extension 1842 or planning@norfolkcounty.ca. Please submit the completed application and fees to the attention of the Planning Department at 185 Robinson Street, Suite 200, Simcoe, ON N3Y 5L6.

For Office Use Only:

File Number	_____	Public Notice Sign	_____
Related File Number	_____	Application Fee	_____
Pre-consultation Meeting	_____	Conservation Authority Fee	_____
Application Submitted	_____	Well & Septic Info Provided	_____
Complete Application	_____	Planner	_____

Check the type of planning application(s) you are submitting.

- ☐ Official Plan Amendment
- ☒ Zoning By-Law Amendment
- ☐ Temporary Use By-law
- ☒ Draft Plan of Subdivision/Vacant Land Condominium
- ☐ Condominium Exemption
- ☐ Site Plan Application
- ☐ Extension of a Temporary Use By-law
- ☐ Part Lot Control
- ☐ Cash-in-Lieu of Parking
- ☐ Renewable Energy Project or Radio Communication Tower

Please summarize the desired end result of this application (for example: a special zoning provision on the subject lands to include additional use(s), changing the zone and/or official plan designation of the subject lands, creating a certain number of lots, or similar)

Draft Plan of Subdivision and Zoning By-law Amendment Application proposed for a street townhouse and semi-detached development off of Nichol Street West, Waterford. Please see the attached Planning Justification Report for details.

Site Plan Application is to be submitted following a functional review by the County staff.

Property Assessment Roll Number: _____

A. Applicant Information

Name of Owner Berardi Construction (c/o Rob Berardi)

It is the responsibility of the owner or applicant to notify the planner of any changes in ownership within 30 days of such a change.

Address 222 Fairview Drive

Town and Postal Code Brantford, ON N3R 2W9

Phone Number 519-755-6205

Cell Number _____

Email berardiconstruction@hotmail.com

Name of Applicant IBI Group (c/o Douglas W. Stewart)

Address 410 Albert Street, Suite 101

Town and Postal Code Waterloo, ON N2L 3V3

Phone Number 519-585-2255 ext. 63212

Cell Number 519-577-5710

Email douglas.stewart@ibigroup.com

Name of Agent Same as Applicant

Address _____

Town and Postal Code _____

Phone Number _____

Cell Number _____

Email _____

Please specify to whom all communications should be sent. Unless otherwise directed, all correspondence and notices in respect of this application will be forwarded to both owner and agent noted above.

☐ Owner

☐ Agent

☒ Applicant

Names and addresses of any holder of any mortgagees, charges or other encumbrances on the subject lands:

B. Location, Legal Description and Property Information

1. Legal Description (include Geographic Township, Concession Number, Lot Number, Block Number and Urban Area or Hamlet):

Block 28, Registered Plan 19-B, Town of Waterford, Norfolk County.

Municipal Civic Address: The subject property does not have a municipal address.

Present Official Plan Designation(s): Urban Residential

Present Zoning: Development (D) Zone

2. Is there a special provision or site specific zone on the subject lands?

☐ Yes ☒ No If yes, please specify corresponding number:

3. Present use of the subject lands:

Vacant lands.

4. Please describe **all existing** buildings or structures on the subject lands and whether they are to be retained, demolished or removed. If retaining the buildings or structures, please describe the type of buildings or structures, and illustrate the setback, in metric units, from front, rear and side lot lines, ground floor area, gross floor area, lot coverage, number of storeys, width, length, and height on your attached sketch which must be included with your application:

Vacant lands, no existing buildings or structures.

5. If an addition to an existing building is being proposed, please explain what it will be used for (for example: bedroom, kitchen, or bathroom). If new fixtures are proposed, please describe.

N/A

6. Please describe **all proposed** buildings or structures/additions on the subject lands. Describe the type of buildings or structures/additions, and illustrate the setback, in metric units, from front, rear and side lot lines, ground floor area, gross floor area, lot coverage, number of storeys, width, length, and height on your attached sketch which must be included with your application:

25 street townhouses and 26 semi-detached dwellings. Please see Planning Justification Report for details.

7. Are any existing buildings on the subject lands designated under the *Ontario Heritage Act* as being architecturally and/or historically significant? Yes ☐ No ☒

If yes, identify and provide details of the building:

8. If known, the length of time the existing uses have continued on the subject lands:

N/A

9. Existing use of abutting properties:

North = vacant lands, East = Low-rise res. housing, South = low-rise res. housing, and West = Waterford Mini Storage

10. Are there any easements or restrictive covenants affecting the subject lands?

☐ Yes ☒ No If yes, describe the easement or restrictive covenant and its effect:

C. Purpose of Development Application

Note: Please complete all that apply.

1. Please explain what you propose to do on the subject lands/premises which makes this development application necessary:

Zoning By-law Amendment to permit the proposed Street Townhouse and Semi-detached Dwellings on the subject property. See the Planning Justification Report for details.

2. Please explain why it is not possible to comply with the provision(s) of the Zoning By-law/and or Official Plan:

Street Townhouse and Semi-detached Dwellings are currently not permitted within the D Zone, therefore, a Zoning By-law Amendment is required. Please see the Planning Justification Report for details.

3. Does the requested amendment alter all or any part of the boundary of an area of settlement in the municipality or implement a new area of settlement in the municipality? ☐ Yes ☒ No If yes, describe its effect:

4. Does the requested amendment remove the subject land from an area of employment? ☐ Yes ☒ No If yes, describe its effect:

5. Does the requested amendment alter, replace, or delete a policy of the Official Plan?
☐ Yes ☒ No If yes, identify the policy, and also include a proposed text of the policy amendment (if additional space is required, please attach a separate sheet):

6. Description of land intended to be severed in metric units:

Frontage: N/A, severance is not being proposed.

Depth:

Width:

Lot Area:

Present Use:

Proposed Use:

Proposed final lot size (if boundary adjustment):

If a boundary adjustment, identify the assessment roll number and property owner of the lands to which the parcel will be added:

Description of land intended to be retained in metric units:

Frontage: N/A

Depth:

Width:

Lot Area:

Present Use:

Proposed Use:

Buildings on retained land:

7. Description of proposed right-of-way/easement:

Frontage: N/A

Depth:

Width:

Area:

Proposed use:

8. Name of person(s), if known, to whom lands or interest in lands to be transferred, leased or charged (if known):

9. Site Information**Zoning****Proposed**

Please indicate unit of measurement, for example: m, m² or %

Lot frontage

Please see attached plans and Planning Justification Report

Lot depth

Lot width

Lot area

Lot coverage

Front yard

Rear yard

Left Interior side yard

Right Interior side yard

Exterior side yard (corner lot)

Landscaped open space

Entrance access width

Exit access width

Size of fencing or screening

Type of fencing

10. Building Size

Number of storeys

Building height

Total ground floor area

Total gross floor area

Total useable floor area

11. Off Street Parking and Loading Facilities

Number of off street parking spaces

Number of visitor parking spaces

Number of accessible parking spaces

Number of off street loading facilities

12. Residential (if applicable)

Number of buildings existing: 0

Number of buildings proposed: 51 (25 street townhouse, 26 semi-detached)

Is this a conversion or addition to an existing building? ☐ Yes ☒ No

If yes, describe: _____

Type	Number of Units	Floor Area per Unit in m2
Single Detached	_____	_____
Semi-Detached	<u>26</u>	_____
Duplex	_____	_____
Triplex	_____	_____
Four-plex	_____	_____
Street Townhouse	<u>25</u>	_____
Stacked Townhouse	_____	_____
Apartment - Bachelor	_____	_____
Apartment - One bedroom	_____	_____
Apartment - Two bedroom	_____	_____
Apartment - Three bedroom	_____	_____

Other facilities provided (for example: play facilities, underground parking, games room, or swimming pool):

13. Commercial/Industrial Uses (if applicable)

Number of buildings existing: N/A

Number of buildings proposed: _____

Is this a conversion or addition to an existing building? ☐ Yes ☐ No

If yes, describe: _____

Indicate the gross floor area by the type of use (for example: office, retail, or storage):

Seating Capacity (for assembly halls or similar): _____

Total number of fixed seats: _____

Describe the type of business(es) proposed: _____

Total number of staff proposed initially: _____

Total number of staff proposed in five years: _____

Maximum number of staff on the largest shift: _____

Is open storage required: ☐ Yes ☒ No

Is a residential use proposed as part of, or accessory to commercial/industrial use?

☐ Yes ☒ No If yes please describe:

14. Institutional (if applicable)

Describe the type of use proposed: N/A

Seating capacity (if applicable): _____

Number of beds (if applicable): _____

Total number of staff proposed initially: _____

Total number of staff proposed in five years: _____

Maximum number of staff on the largest shift: _____

Indicate the gross floor area by the type of use (for example: office, retail, or storage):

N/A

15. Describe Recreational or Other Use(s) (if applicable)

N/A

D. Previous Use of the Property

1. Has there been an industrial or commercial use on the subject lands or adjacent lands? ☒ Yes ☐ No ☐ Unknown

If yes, specify the uses (for example: gas station or petroleum storage):

Outdoor and indoor storage facility on the adjacent lands to the west. No industrial or commercial uses on the subject lands.

2. Is there reason to believe the subject lands may have been contaminated by former uses on the site or adjacent sites? ☐ Yes ☒ No ☐ Unknown

3. Provide the information you used to determine the answers to the above questions:
Lands have been historically vacant.

4. If you answered yes to any of the above questions in Section D, a previous use inventory showing all known former uses of the subject lands, or if appropriate, the adjacent lands, is needed. Is the previous use inventory attached? ☐ Yes ☒ No

E. Provincial Policy

1. Is the requested amendment consistent with the provincial policy statements issued under subsection 3(1) of the *Planning Act*, R.S.O. 1990, c. P. 13? ☒ Yes ☐ No

If no, please explain:

Please see the PJR for planning analysis regarding consistency with the PPS.

2. It is owner's responsibility to be aware of and comply with all relevant federal or provincial legislation, municipal by-laws or other agency approvals, including the Endangered Species Act, 2007. Have the subject lands been screened to ensure that development or site alteration will not have any impact on the habitat for endangered or threatened species further to the provincial policy statement subsection 2.1.7? ☒ Yes ☐ No

If no, please explain:

N/A, this does not apply to the subject lands and proposed development. Please see PJR.

3. Have the subject lands been screened to ensure that development or site alteration will not have any impact on source water protection? ☒ Yes ☐ No

If no, please explain:

Subject property not within source water protection area.

Note: If in an area of source water Wellhead Protection Area (WHPA) A, B or C please attach relevant information and approved mitigation measures from the Risk Manager Official.

4. Are any of the following uses or features on the subject lands or within 500 metres of the subject lands, unless otherwise specified? Please check boxes, if applicable.

Livestock facility or stockyard (submit MDS Calculation with application)

☐ On the subject lands or ☐ within 500 meters – distance _____

Wooded area

☐ On the subject lands or ☐ within 500 meters – distance _____

Municipal Landfill

☐ On the subject lands or ☐ within 500 meters – distance _____

Sewage treatment plant or waste stabilization plant

☐ On the subject lands or ☐ within 500 meters – distance _____

Provincially significant wetland (class 1, 2 or 3) or other environmental feature

☐ On the subject lands or ☒ within 500 meters – distance Northern property

Floodplain

☐ On the subject lands or ☒ within 500 meters – distance Northern property

Rehabilitated mine site

☐ On the subject lands or ☐ within 500 meters – distance _____

Non-operating mine site within one kilometre

☐ On the subject lands or ☐ within 500 meters – distance _____

Active mine site within one kilometre

☐ On the subject lands or ☐ within 500 meters – distance _____

Industrial or commercial use (specify the use(s))

☐ On the subject lands or ☒ within 500 meters – distance _____

Active railway line

☐ On the subject lands or ☐ within 500 meters – distance _____

Seasonal wetness of lands

☐ On the subject lands or ☒ within 500 meters – distance Northern Property

Erosion

☐ On the subject lands or ☐ within 500 meters – distance _____

Abandoned gas wells

☐ On the subject lands or ☐ within 500 meters – distance _____

F. Servicing and Access

1. Indicate what services are available or proposed:

Water Supply

- ☒ Municipal piped water ☐ Communal wells
☐ Individual wells ☐ Other (describe below)

Sewage Treatment

- ☒ Municipal sewers ☐ Communal system
☐ Septic tank and tile bed in good working order ☐ Other (describe below)

Storm Drainage

- ☒ Storm sewers ☐ Open ditches
☐ Other (describe below)

2. Existing or proposed access to subject lands:

- ☒ Municipal road ☐ Provincial highway
☐ Unopened road ☐ Other (describe below)

Name of road/street: _____

G. Other Information

1. Does the application involve a local business? ☐ Yes ☒ No

If yes, how many people are employed on the subject lands?

2. Is there any other information that you think may be useful in the review of this application? If so, explain below or attach on a separate page.

Please see the attached Planning Justification Report for details.

H. Supporting Material to be submitted by Applicant

In order for your application to be considered complete, **folded** hard copies (number of paper copies as directed by the planner) and an **electronic version (PDF) of the properly named site plan drawings, additional plans, studies and reports** will be required, including but not limited to the following details:

1. Concept/Layout Plan
2. All measurements in metric
3. Key map
4. Scale, legend and north arrow
5. Legal description and municipal address
6. Development name
7. Drawing title, number, original date and revision dates
8. Owner's name, address and telephone number
9. Engineer's name, address and telephone number
10. Professional engineer's stamp
11. Existing and proposed easements and right of ways
12. Zoning compliance table – required versus proposed
13. Parking space totals – required and proposed
14. All entrances to parking areas marked with directional arrows
15. Loading spaces, facilities and routes (for commercial developments)
16. All dimensions of the subject lands
17. Dimensions and setbacks of all buildings and structures
18. Location and setbacks of septic system and well from all existing and proposed lot lines, and all existing and proposed structures
19. Gross, ground and useable floor area
20. Lot coverage
21. Floor area ratio
22. Building entrances, building type, height, grades and extent of overhangs
23. Names, dimensions and location of adjacent streets including daylighting triangles
24. Driveways, curbs, drop curbs, pavement markings, widths, radii and traffic directional signs
25. All exterior stairways and ramps with dimensions and setbacks
26. Retaining walls including materials proposed
27. Fire access and routes
28. Location, dimensions and number of parking spaces (including visitor and accessible) and drive aisles
29. Location of mechanical room, and other building services (e.g. A/C, HRV)
30. Refuse disposal and storage areas including any related screening (if indoors, need notation on site plan)
31. Winter snow storage location

32. Landscape areas with dimensions
33. Natural features, watercourses and trees
34. Fire hydrants and utilities location
35. Fencing, screening and buffering – size, type and location
36. All hard surface materials
37. Light standards and wall mounted lights (plus a note on the site plan that all outdoor lighting is to be dark sky compliant)
38. Business signs (make sure they are not in sight lines)
39. Sidewalks and walkways with dimensions
40. Pedestrian access routes into site and around site
41. Bicycle parking
42. Architectural elevations of all building sides
43. All other requirements as per the pre-consultation meeting

In addition, the following additional plans, studies and reports, including but not limited to, **may** also be required as part of the complete application submission:

- ☐ Zoning Deficiency Form
- ☐ On-Site Sewage Disposal System Evaluation Form (to verify location and condition)
- ☐ Architectural Plan
- ☐ Buildings Elevation Plan
- ☐ Cut and Fill Plan
- ☐ Erosion and Sediment Control Plan
- ☒ Grading and Drainage Control Plan (around perimeter and within site) (existing and proposed)
- ☐ Landscape Plan
- ☐ Photometric (Lighting) Plan
- ☐ Plan and Profile Drawings
- ☒ Site Servicing Plan
- ☒ Storm water Management Plan
- ☐ Street Sign and Traffic Plan
- ☐ Street Tree Planting Plan
- ☐ Tree Preservation Plan
- ☒ Archaeological Assessment
- ☐ Environmental Impact Study

- ☒ Functional Servicing Report
- ☐ Geotechnical Study / Hydrogeological Review
- ☐ Minimum Distance Separation Schedule
- ☐ Noise or Vibration Study
- ☐ Record of Site Condition
- ☒ Storm water Management Report
- ☒ Traffic Impact Study – please contact the Planner to verify the scope required

Site Plan applications will require the following supporting materials:

1. Two (2) complete sets of the site plan drawings folded to 8½ x 11 and an electronic version in PDF format
2. Letter requesting that the Holding be removed (if applicable)
3. A cost estimate prepared by the applicant's engineer
4. An estimate for Parkland dedication by a certified land appraiser
5. Property Identification Number (PIN) printout

Standard condominium exemptions will require the following supporting materials:

- ☐ Plan of standard condominium (2 paper copies and 1 electronic copy)
- ☐ Draft condominium declaration
- ☐ Property Identification Number (PIN) printout

Your development approval might also be dependent on Ministry of Environment and Climate Change, Ministry of Transportation or other relevant federal or provincial legislation, municipal by-laws or other agency approvals.

All final plans must include the owner's signature as well as the engineer's signature and seal.

I. Development Agreements

A development agreement may be required prior to approval for site plan, subdivision and condominium applications. Should this be necessary for your development, you will be contacted by the agreement administrator with further details of the requirements including but not limited to insurance coverage, professional liability for your engineer, additional fees and securities.

J. Transfers, Easements and Postponement of Interest

The owner acknowledges and agrees that if required it is their solicitor's responsibility on behalf of the owner for the registration of all transfer(s) of land to the County, and/or transfer(s) of easement in favour of the County and/or utilities. Also, the owner further acknowledges and agrees that it is their solicitor's responsibility on behalf of the owner for the registration of postponements of any charges in favour of the County.

K. Permission to Enter Subject Lands

Permission is hereby granted to Norfolk County officers, employees or agents, to enter the premises subject to this application for the purposes of making inspections associated with this application, during normal and reasonable working hours.

L. Freedom of Information

For the purposes of the *Municipal Freedom of Information and Protection of Privacy Act*, I authorize and consent to the use by or the disclosure to any person or public body any information that is collected under the authority of the *Planning Act, R.S.O. 1990, c. P. 13* for the purposes of processing this application.

<div style="text-align: center;">  <u>Robert Berardi</u> <small>11/23/2021 4:05:18 PM EST</small> Owner/Applicant Signature </div>	<div style="text-align: center;"> <u>11/23/2021</u> Date </div>
--	--

M. Owner's Authorization

If the applicant/agent is not the registered owner of the lands that is the subject of this application, the owner(s) must complete the authorization set out below.

I/We 1391570 Ontario Inc. am/are the registered owner(s) of the lands that is the subject of this application.

I/We authorize IBI Group (c/o Douglas W. Stewart) to make this application on my/our behalf and to provide any of my/our personal information necessary for the processing of this application. Moreover, this shall be your good and sufficient authorization for so doing.

<div style="text-align: center;">  <u>Robert Berardi</u> <small>11/23/2021 4:05:20 PM EST</small> Owner </div>	<div style="text-align: center;"> <u>11/23/2021</u> Date </div>
Owner	Date

N. Declaration

I, DOUGLAS W. STEWART of CITY OF WATERLOO

solemnly declare that:

all of the above statements and the statements contained in all of the exhibits transmitted herewith are true and I make this solemn declaration conscientiously believing it to be true and knowing that it is of the same force and effect as if made under oath and by virtue of *The Canada Evidence Act*.

Declared before me at:

CITY OF WATERLOO

Douglas W Stewart

Owner/Applicant Signature

In REGION OF WATERLOO

This 17TH day of NOVEMBER

A.D., 2021

Betty Anne White

A Commissioner, etc.

Noted: Anne White, a Commissioner, etc.,
for the Province of Ontario, for IBI Group.
Expires June 2, 2024.

MAP A
CONTEXT MAP
 Urban Area of WATERFORD

28PL2022015
 ZNPL2022016



Legend

Subject Lands

2020 Air Photo

1/28/2022

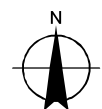



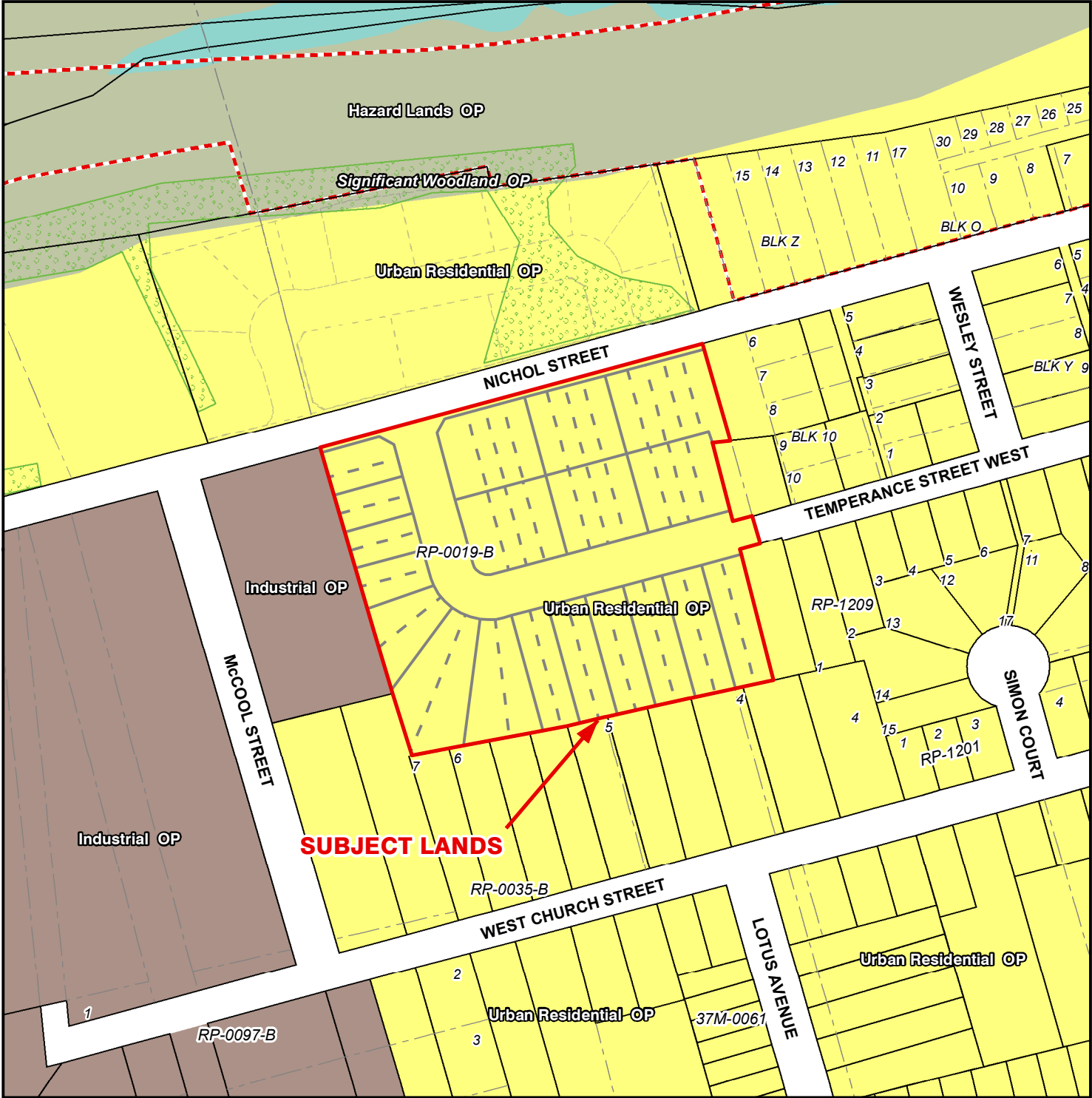



20 10 0 20 40 60 80
 Meters



Legend

 Subject Lands

Official Plan Designations

- | | |
|--|--|
|  Hazard Lands |  Special Policy Area |
|  Provincially Significant Wetland |  Urban Area Boundary |
|  Urban Residential |  Significant Woodland |
|  Industrial | |

1/28/2022

From: D
To: R2/R4

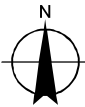

20 10 0 20 40 60 80 Meters

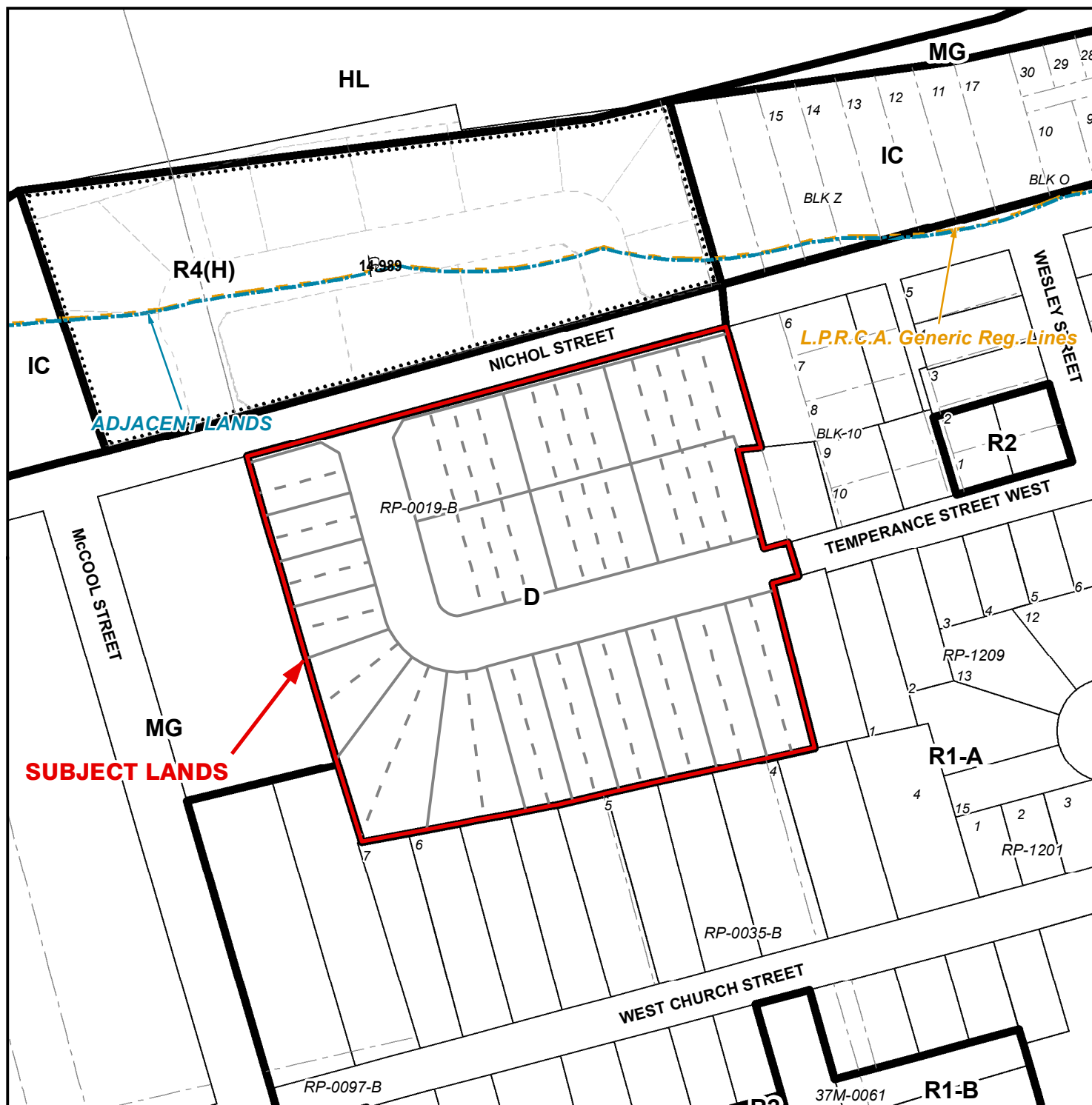

LEGEND

- Subject Lands
- Adjacent Lands
- LPRCA Generic RegLines

ZONING BY-LAW 1-Z-2014

1/28/2022

- (H) - Holding
- IC - Community Institutional Zone
- D - Development Zone
- MG - General Industrial Zone
- HL - Hazard Land Zone
- R1-A - Residential R1-A Zone
- R1-B - Residential R1-B Zone
- R2 - Residential R2 Zone
- R4 - Residential R4 Zone

From: D
To: R2/R4

10 5 0 10 20 30 40
 Meters

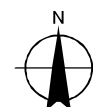

CONCEPTUAL PLAN

Urban Area of WATERFORD

28PL2022015
ZNPL2022016



☐ Subject Lands

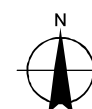

1/28/2022

