

For Office Use Only:

File Number ANPL2022114
Related File Number -
Pre-consultation Meeting March 23, 2022
Application Submitted May 3, 2022
Complete Application

Application Fee \$1599.00
Conservation Authority Fee \$514.15
Well & Septic Info Provided -
Planner Hanne Yager
Public Notice Sign -

Check the type of planning application(s) you are submitting.

- ☐ Consent/Severance/Boundary Adjustment
☐ Surplus Farm Dwelling Severance and Zoning By-law Amendment
☒ Minor Variance
☐ Easement/Right-of-Way

Property Assessment Roll Number: 3310-337-040-11605

A. Applicant Information

Name of Owner John Dertinger and Katherine McCall

It is the responsibility of the owner or applicant to notify the planner of any changes in ownership within 30 days of such a change.

Address 2303 Hoover Court
Town and Postal Code Burlington, ON L7P 4V2
Phone Number
Cell Number 905-609-4750
Email jcdertinger@sympatico.ca

Name of Applicant Agent
Address
Town and Postal Code
Phone Number
Cell Number
Email

Name of Agent David McPherson
Address 8 Culver Lane
Town and Postal Code Simcoe, ON N3Y 5C8
Phone Number 519-426-7295
Cell Number 519-427-6483
Email david-a-mcpherson@hotmail.com

Please specify to whom all communications should be sent. Unless otherwise directed, all correspondence and notices in respect of this application will be forwarded to the owner and agent noted above.

☒ Owner ☒ Agent ☐ Applicant

Names and addresses of any holder of any mortgagees, charges or other encumbrances on the subject lands:

n/a

B. Location, Legal Description and Property Information

1. Legal Description (include Geographic Township, Concession Number, Lot Number, Block Number and Urban Area or Hamlet):

Lot 14 Concession 1 Woodhouse

Parts 1 & 2 of Plan 37R-9753

Municipal Civic Address: 51 Woodhouse Avenue, Port Dover

Present Official Plan Designation(s): Urban Residential

Present Zoning: R1-A

2. Is there a special provision or site specific zone on the subject lands?

☒ Yes ☐ No If yes, please specify:

Special Provision 14.584

3. Present use of the subject lands:

Vacant land

4. Please describe **all existing** buildings or structures on the subject lands and whether they are to be retained, demolished or removed. If retaining the buildings or structures, please describe the type of buildings or structures, and illustrate the setback, in metric units, from front, rear and side lot lines, ground floor area, gross floor area, lot coverage, number of storeys, width, length, and height on your attached sketch which must be included with your application:

Vacant land

5. If an addition to an existing building is being proposed, please explain what it will be used for (for example a bedroom, kitchen, or bathroom). If new fixtures are proposed, please describe.

n/a

6. Please describe **all proposed** buildings or structures/additions on the subject lands. Describe the type of buildings or structures/additions, and illustrate the setback, in metric units, from front, rear and side lot lines, ground floor area, gross floor area, lot coverage, number of storeys, width, length, and height on your attached sketch which must be included with your application:

Propose a 2 storey house with a footprint of 418 sq.m. which will include all decks, porches and steps along with an additional 140 sq.m. attached garage

7. Are any existing buildings on the subject lands designated under the *Ontario Heritage Act* as being architecturally and/or historically significant? Yes ☐ No ☒

If yes, identify and provide details of the building:

8. If known, the length of time the existing uses have continued on the subject lands:

been vacant land for in excess of 60 years

9. Existing use of abutting properties:

Residential

10. Are there any easements or restrictive covenants affecting the subject lands?

☐ Yes ☒ No If yes, describe the easement or restrictive covenant and its effect:

C. Purpose of Development Application

Note: Please complete all that apply. **Failure to complete this section will result in an incomplete application.**

1. Site Information (Please refer to Zoning By-law to confirm permitted dimensions)

	Existing	Permitted	Provision	Proposed	Deficiency
Lot frontage	15.24	15			
Lot depth	45.7				
Lot width					
Lot area	2279	450			
Lot coverage					
Front yard		6		6	
Rear yard		1.2	14.584(b)	3	1.8
Height					
Left Interior side yard		1.2		3	
Right Interior side yard		7.5	14.584(a)	1.2	6.3
Exterior side yard (corner lot)					
Parking Spaces (number)					
Aisle width					
Stall size					
Loading Spaces					
Other					

2. Please explain why it is not possible to comply with the provision(s) of the Zoning By-law:

The right side yard (north) as required by special provision 14.584 (a) is in excess of county minimums on any other R1-A property. We are applying for relief of the 7.5m side yard in order to align the garage doors for direct entry off of Woodhouse Ave.

3. **Consent/Severance/Boundary Adjustment:** Description of land intended to be severed in metric units:

Frontage: _____

Depth: _____

Width: _____

Lot Area: _____

Present Use: _____

Proposed Use: _____

Proposed final lot size (if boundary adjustment): _____

If a boundary adjustment, identify the assessment roll number and property owner of the lands to which the parcel will be added: _____

Description of land intended to be retained in metric units:

Frontage: _____

Depth: _____

Width: _____

Lot Area: _____

Present Use: _____

Proposed Use: _____

Buildings on retained land: _____

4. **Easement/Right-of-Way:** Description of proposed right-of-way/easement in metric units:

Frontage: _____

Depth: _____

Width: _____
Area: _____
Proposed Use: _____

5. Surplus Farm Dwelling Severances Only: List all properties in Norfolk County, which are owned and farmed by the applicant and involved in the farm operation

Owners Name: _____
Roll Number: _____
Total Acreage: _____
Workable Acreage: _____
Existing Farm Type: (for example: corn, orchard, livestock) _____
Dwelling Present?: ☐ Yes ☐ No If yes, year dwelling built _____
Date of Land Purchase: _____

Owners Name: _____
Roll Number: _____
Total Acreage: _____
Workable Acreage: _____
Existing Farm Type: (for example: corn, orchard, livestock) _____
Dwelling Present?: ☐ Yes ☐ No If yes, year dwelling built _____
Date of Land Purchase: _____

Owners Name: _____
Roll Number: _____
Total Acreage: _____
Workable Acreage: _____
Existing Farm Type: (for example: corn, orchard, livestock) _____
Dwelling Present?: ☐ Yes ☐ No If yes, year dwelling built _____
Date of Land Purchase: _____

Owners Name: _____
Roll Number: _____
Total Acreage: _____
Workable Acreage: _____
Existing Farm Type: (for example: corn, orchard, livestock) _____
Dwelling Present?: ☐ Yes ☐ No If yes, year dwelling built _____
Date of Land Purchase: _____

Owners Name: _____
Roll Number: _____
Total Acreage: _____
Workable Acreage: _____
Existing Farm Type: (for example: corn, orchard, livestock) _____
Dwelling Present?: ☐ Yes ☐ No If yes, year dwelling built _____
Date of Land Purchase: _____

Note: If additional space is needed please attach a separate sheet.

D. All Applications: Previous Use of the Property

1. Has there been an industrial or commercial use on the subject lands or adjacent lands? ☐ Yes ☒ No ☐ Unknown
If yes, specify the uses (for example: gas station, or petroleum storage):

2. Is there reason to believe the subject lands may have been contaminated by former uses on the site or adjacent sites? ☐ Yes ☒ No ☐ Unknown
3. Provide the information you used to determine the answers to the above questions:
Property has been vacant land for over 60 years

4. If you answered yes to any of the above questions in Section D, a previous use inventory showing all known former uses of the subject lands, or if appropriate, the adjacent lands, is needed. Is the previous use inventory attached? ☐ Yes ☐ No

E. All Applications: Provincial Policy

1. Is the requested amendment consistent with the provincial policy statements issued under subsection 3(1) of the *Planning Act*, R.S.O. 1990, c. P. 13? ☒ Yes ☐ No

If no, please explain:

2. It is owner's responsibility to be aware of and comply with all relevant federal or provincial legislation, municipal by-laws or other agency approvals, including the Endangered Species Act, 2007. Have the subject lands been screened to ensure that development or site alteration will not have any impact on the habitat for endangered or threatened species further to the provincial policy statement subsection 2.1.7? ☒ Yes ☐ No

If no, please explain:

3. Have the subject lands been screened to ensure that development or site alteration will not have any impact on source water protection? ☒ Yes ☐ No

If no, please explain:

Note: If in an area of source water Wellhead Protection Area (WHPA) A, B or C please attach relevant information and approved mitigation measures from the Risk Manager Official.

4. All Applications: Are any of the following uses or features on the subject lands or within 500 metres of the subject lands, unless otherwise specified? Please check boxes, if applicable.

Livestock facility or stockyard (submit MDS Calculation with application)

☐ On the subject lands or ☐ within 500 meters – distance _____

Wooded area

☐ On the subject lands or ☐ within 500 meters – distance _____

Municipal Landfill

☐ On the subject lands or ☐ within 500 meters – distance _____

Sewage treatment plant or waste stabilization plant

☐ On the subject lands or ☒ within 500 meters – distance 300m

Provincially significant wetland (class 1, 2 or 3) or other environmental feature

☐ On the subject lands or ☐ within 500 meters – distance _____

Floodplain

☐ On the subject lands or ☒ within 500 meters – distance 60m

Rehabilitated mine site

☐ On the subject lands or ☐ within 500 meters – distance _____

Non-operating mine site within one kilometre

☐ On the subject lands or ☐ within 500 meters – distance _____

Active mine site within one kilometre

☐ On the subject lands or ☐ within 500 meters – distance _____

Industrial or commercial use (specify the use(s))

☐ On the subject lands or ☐ within 500 meters – distance _____

Active railway line

☐ On the subject lands or ☐ within 500 meters – distance _____

Seasonal wetness of lands

☐ On the subject lands or ☐ within 500 meters – distance _____

Erosion

☐ On the subject lands or ☐ within 500 meters – distance _____

Abandoned gas wells

☐ On the subject lands or ☐ within 500 meters – distance _____

F. All Applications: Servicing and Access

1. Indicate what services are available or proposed:

Water Supply

- | | |
|---|---|
| <input checked="" type="checkbox"/> Municipal piped water | <input type="checkbox"/> Communal wells |
| <input type="checkbox"/> Individual wells | <input type="checkbox"/> Other (describe below) |
-

Sewage Treatment

- | | |
|---|---|
| <input checked="" type="checkbox"/> Municipal sewers | <input type="checkbox"/> Communal system |
| <input type="checkbox"/> Septic tank and tile bed in good working order | <input type="checkbox"/> Other (describe below) |
-

Storm Drainage

- | | |
|--|---------------------------------------|
| <input checked="" type="checkbox"/> Storm sewers | <input type="checkbox"/> Open ditches |
| <input type="checkbox"/> Other (describe below) | |
-

2. Existing or proposed access to subject lands:

- | | |
|--|---|
| <input checked="" type="checkbox"/> Municipal road | <input type="checkbox"/> Provincial highway |
| <input type="checkbox"/> Unopened road | <input type="checkbox"/> Other (describe below) |

Name of road/street:

G. All Applications: Other Information

1. Does the application involve a local business? ☐ Yes ☒ No

If yes, how many people are employed on the subject lands?

2. Is there any other information that you think may be useful in the review of this application? If so, explain below or attach on a separate page.

The neighbouring property known as 53 Woodhouse Ave applied for and was granted similar relief for their north (right) side yard to allow for construction of their new home built in 2020.

H. Supporting Material to be submitted by Applicant

In order for your application to be considered complete, folded hard copies (number of paper copies as directed by the planner) and an **electronic version (PDF) of the site plan drawings, additional plans, studies and reports** will be required, including but not limited to the following details:

1. Concept/Layout Plan
2. All measurements in metric
3. Existing and proposed easements and right of ways
4. Parking space totals – required and proposed
5. All dimensions of the subject lands
6. Dimensions and setbacks of all buildings and structures
7. Location and setbacks of septic system and well from all existing and proposed lot lines, and all existing and proposed structures
8. Names of adjacent streets
9. Natural features, watercourses and trees

In addition, the following additional plans, studies and reports, including but not limited to, **may** also be required as part of the complete application submission:

- ☐ On-Site Sewage Disposal System Evaluation Form (to verify location and condition)
- ☐ Environmental Impact Study
- ☒ Geotechnical Study / Hydrogeological Review
- ☐ Minimum Distance Separation Schedule
- ☐ Record of Site Condition

Your development approval might also be dependent on Ministry of Environment Conservation and Parks, Ministry of Transportation or other relevant federal or provincial legislation, municipal by-laws or other agency approvals.

All final plans must include the owner's signature as well as the engineer's signature and seal.

I. Transfers, Easements and Postponement of Interest

The owner acknowledges and agrees that if required it is their solicitor's responsibility on behalf of the owner for the registration of all transfer(s) of land to the County, and/or transfer(s) of easement in favour of the County and/or utilities. Also, the owner further acknowledges and agrees that it is their solicitor's responsibility on behalf of the owner for the registration of postponements of any charges in favour of the County.

Permission to Enter Subject Lands

Permission is hereby granted to Norfolk County officers, employees or agents, to enter the premises subject to this application for the purposes of making inspections associated with this application, during normal and reasonable working hours.

Freedom of Information

For the purposes of the *Municipal Freedom of Information and Protection of Privacy Act*, I authorize and consent to the use by or the disclosure to any person or public body any information that is collected under the authority of the *Planning Act, R.S.O. 1990, c. P. 13* for the purposes of processing this application.



Owner/Applicant/Agent Signature



Date

J. Owner's Authorization

If the applicant/agent is not the registered owner of the lands that is the subject of this application, the owner must complete the authorization set out below.

I/We John Dertinger & Katherine McCall am/are the registered owner(s) of the lands that is the subject of this application.

I/We authorize David McPherson to make this application on my/our behalf and to provide any of my/our personal information necessary for the processing of this application. Moreover, this shall be your good and sufficient authorization for so doing.





Owner

March 3/2022

Date

March 3/2022

Date

***Note:** If property is owned by an Ontario Ltd. Corporation, Articles of Incorporation are required to be attached to the application.

K. Declaration

I, David McPherson of Simcoe

solemnly declare that:

all of the above statements and the statements contained in all of the exhibits transmitted herewith are true and I make this solemn declaration conscientiously believing it to be true and knowing that it is of the same force and effect as if made under oath and by virtue of *The Canada Evidence Act*.

Declared before me at:

Simcoe RAB building



~~Owner/Applicant~~/Agent Signature

In Norfolk County

This 16th day of March

A.D., 2022

A Commissioner, etc.

CONTEXT MAP

Geographic Township of WOODHOUSE



Legend

 Subject Lands

2020 Air Photo

7/7/2022

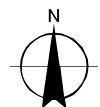

20 10 0 20 40 60 80 Meters

MAP B

ZONING BY-LAW MAP

Geographic Township of WOODHOUSE

ANPL2022114

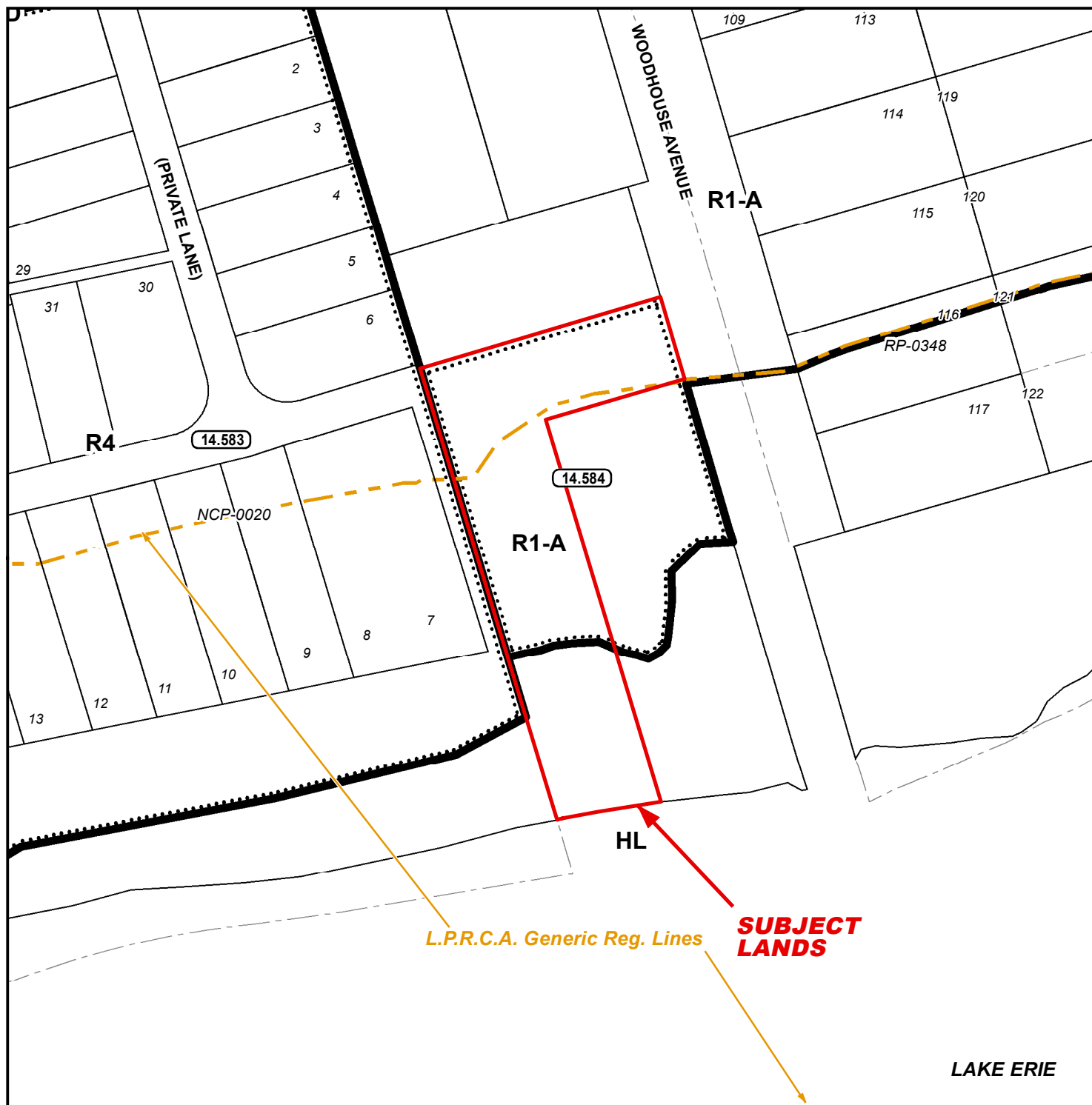

LEGEND

- Subject Lands
- LPRCA Generic RegLines

ZONING BY-LAW 1-Z-2014

7/7/2022

- (H) - Holding
- D - Development Zone
- HL - Hazard Land Zone
- R1-A - Residential R1-A Zone
- R4 - Residential R4 Zone

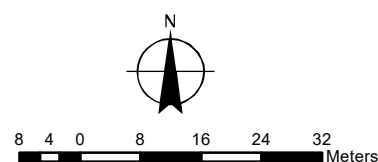

CONCEPTUAL PLAN

Geographic Township of WOODHOUSE

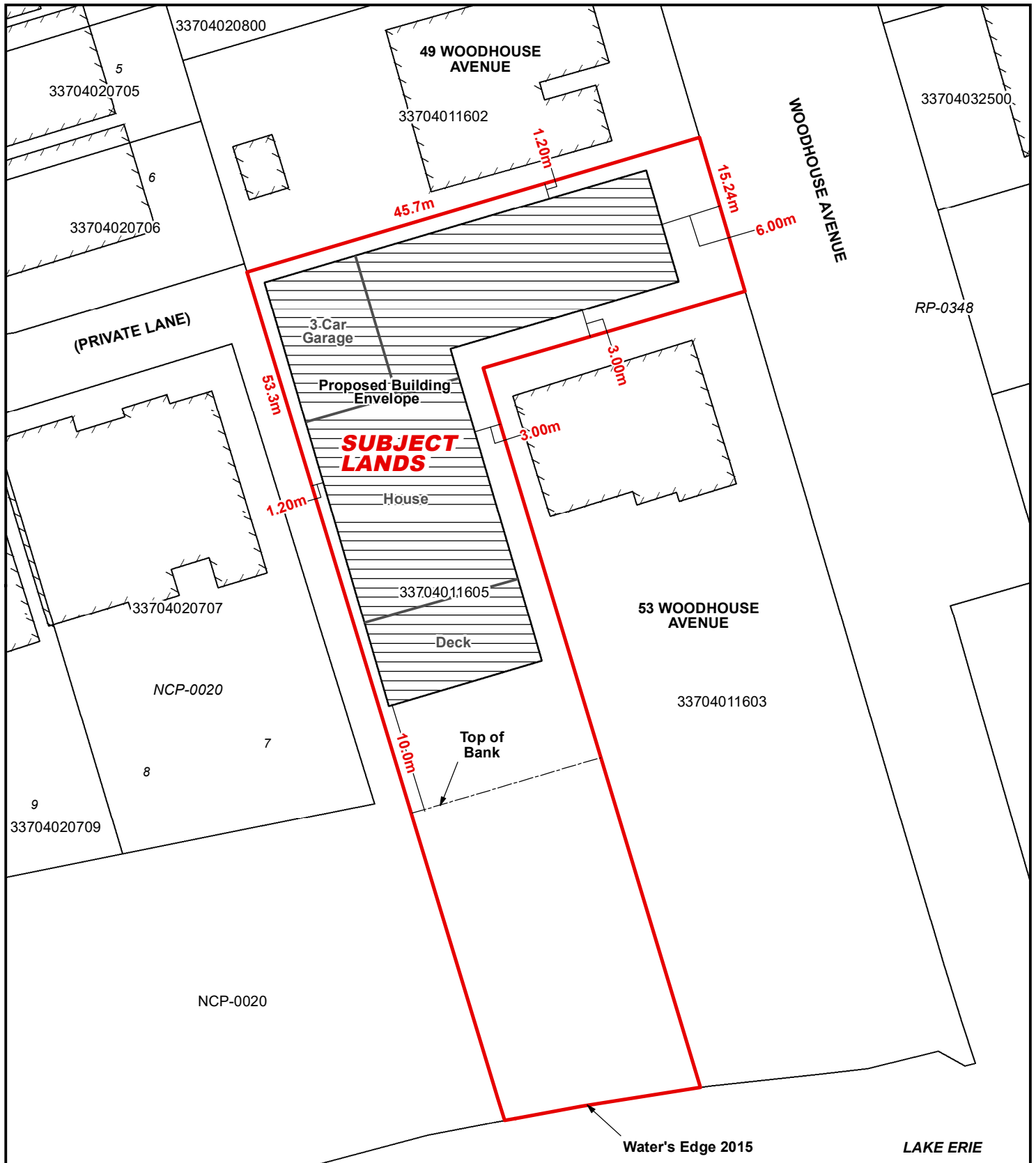

Legend

Subject Lands

7/7/2022

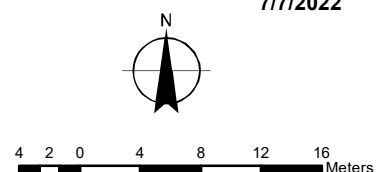

CONCEPTUAL PLAN

Geographic Township of WOODHOUSE

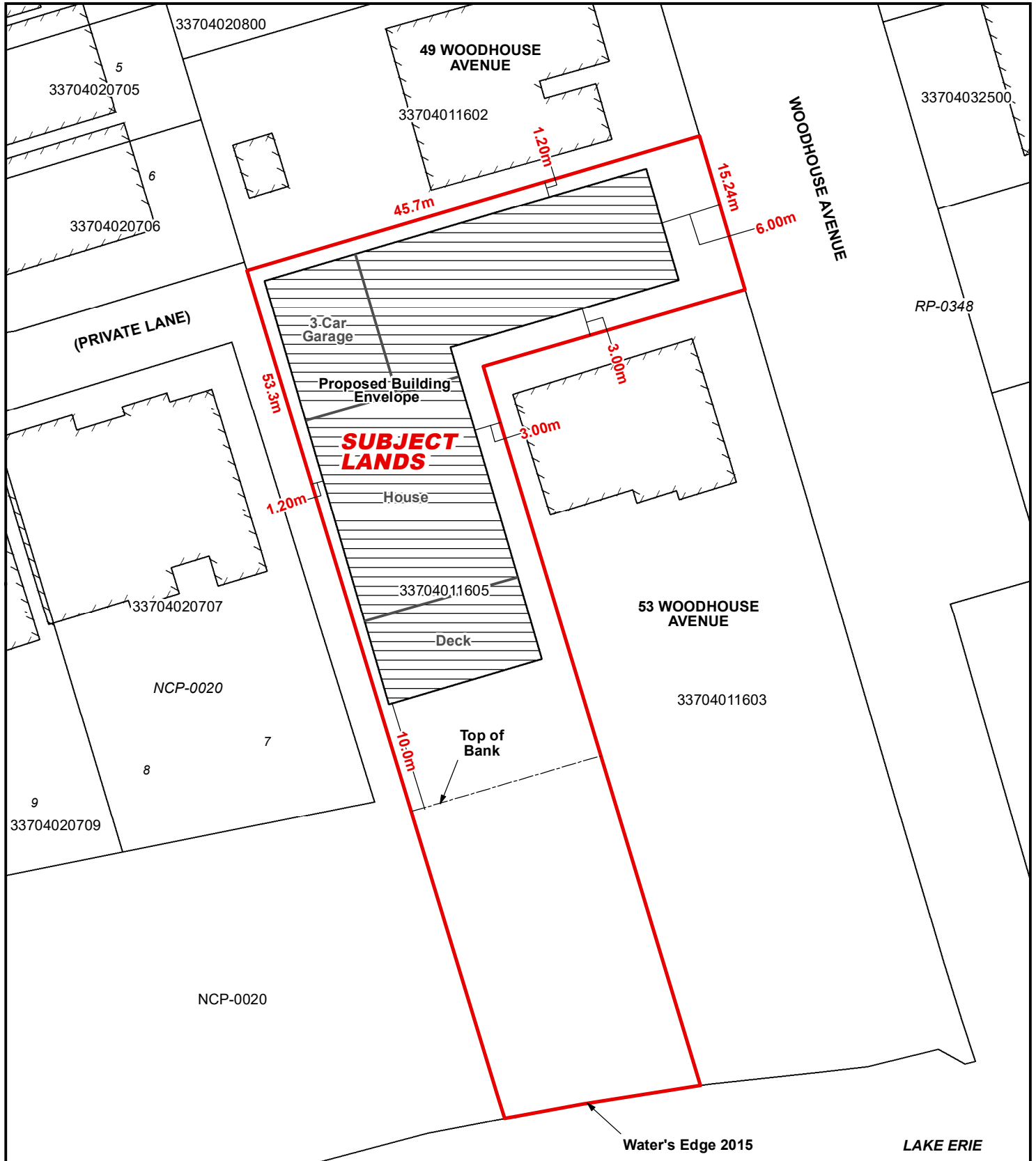

Legend

Subject Lands

