

For Office Use Only:

File Number	_____	Application Fee	_____
Related File Number	_____	Conservation Authority Fee	_____
Pre-consultation Meeting	_____	Well & Septic Info Provided	_____
Application Submitted	_____	Planner	_____
Complete Application	_____	Public Notice Sign	_____

Check the type of planning application(s) you are submitting.

- Consent/Severance/Boundary Adjustment
- Surplus Farm Dwelling Severance and Zoning By-law Amendment
- Minor Variance
- Easement/Right-of-Way

Property Assessment Roll Number: 3310-493-110-12300

A. Applicant Information

Name of Owner Vijaykumar Parekh

It is the responsibility of the owner or applicant to notify the planner of any changes in ownership within 30 days of such a change.

Address 231 Cedar Drive

Town and Postal Code Turkey Point ON N0E 1T0

Phone Number _____

Cell Number 647-991-9729

Email vijay1066@gmail.com

Name of Applicant Agent

Address _____

Town and Postal Code _____

Phone Number _____

Cell Number _____

Email _____



Name of Agent David McPherson

Address 8 Culver Lane

Town and Postal Code Simcoe, ON N3Y 5C8

Phone Number _____

Cell Number 519-427-6483

Email david-a-mcpherson@hotmail.com

Please specify to whom all communications should be sent. Unless otherwise directed, all correspondence and notices in respect of this application will be forwarded to the owner and agent noted above.

Owner Agent Applicant

Names and addresses of any holder of any mortgagees, charges or other encumbrances on the subject lands:

n/a

B. Location, Legal Description and Property Information

1. Legal Description (include Geographic Township, Concession Number, Lot Number, Block Number and Urban Area or Hamlet):

Lot 143 Plan 190 Charlotteville

Municipal Civic Address: 231 Cedar Drive

Present Official Plan Designation(s): Resort Residential

Present Zoning: Resort Residential

2. Is there a special provision or site specific zone on the subject lands?

Yes No If yes, please specify:

3. Present use of the subject lands:

Residential

4. Please describe **all existing** buildings or structures on the subject lands and whether they are to be retained, demolished or removed. If retaining the buildings or structures, please describe the type of buildings or structures, and illustrate the setback, in metric units, from front, rear and side lot lines, ground floor area, gross floor area, lot coverage, number of storeys, width, length, and height on your attached sketch which must be included with your application:

The existing dwelling shown on the attached survey is to be demolished.

5. If an addition to an existing building is being proposed, please explain what it will be used for (for example a bedroom, kitchen, or bathroom). If new fixtures are proposed, please describe.

n/a

6. Please describe **all proposed** buildings or structures/additions on the subject lands. Describe the type of buildings or structures/additions, and illustrate the setback, in metric units, from front, rear and side lot lines, ground floor area, gross floor area, lot coverage, number of storeys, width, length, and height on your attached sketch which must be included with your application:

The attached surveyor's sketch shows the proposed 2 storey dwelling.

7. Are any existing buildings on the subject lands designated under the *Ontario Heritage Act* as being architecturally and/or historically significant? Yes No

If yes, identify and provide details of the building:

8. If known, the length of time the existing uses have continued on the subject lands:

The existing dwelling dates from the 1950's.

9. Existing use of abutting properties:

Residential

10. Are there any easements or restrictive covenants affecting the subject lands?

Yes No If yes, describe the easement or restrictive covenant and its effect:

C. Purpose of Development Application

Note: Please complete all that apply. **Failure to complete this section will result in an incomplete application.**

1. Site Information (Please refer to Zoning By-law to confirm permitted dimensions)

	Existing	Permitted	Provision	Proposed	Deficiency
Lot frontage	12.619m			12.619m	
Lot depth	23.165m			23.165m	
Lot width	12.619m			12.619m	
Lot area	292.3sqm			292.3sqm	
Lot coverage	35.6%	15%		53.9%	38.9%
Front yard	1.23m	6m		1.23m	4.77m
Rear yard	6.52m	9m		6.52m	2.48m
Height	5m	9.1m		9m	
Left Interior side yard	4.18m	1.2m		0.84m	0.36m
Right Interior side yard	1.65m	1.2m		0.84m	0.36m
Exterior side yard (corner lot)					
Parking Spaces (number)	1	2		1	1
Aisle width					
Stall size					
Loading Spaces					
Other					

2. Please explain why it is not possible to comply with the provision(s) of the Zoning By-law:

The existing lot is undersized.

3. **Consent/Severance/Boundary Adjustment:** Description of land intended to be severed in metric units:

Frontage: n/a

Depth:

Width:

Lot Area:

Present Use:

Proposed Use:

Proposed final lot size (if boundary adjustment): _____

If a boundary adjustment, identify the assessment roll number and property owner of the lands to which the parcel will be added: _____

Description of land intended to be retained in metric units:

Frontage:

Depth:

Width:

Lot Area:

Present Use:

Proposed Use:

Buildings on retained land: _____

4. **Easement/Right-of-Way:** Description of proposed right-of-way/easement in metric units:

Frontage: n/a

Depth:

Width: _____
Area: _____
Proposed Use: _____

5. Surplus Farm Dwelling Severances Only: List all properties in Norfolk County, which are owned and farmed by the applicant and involved in the farm operation

Owners Name: n/a
Roll Number: _____
Total Acreage: _____
Workable Acreage: _____
Existing Farm Type: (for example: corn, orchard, livestock) _____
Dwelling Present?: Yes No If yes, year dwelling built _____
Date of Land Purchase: _____

Owners Name: _____
Roll Number: _____
Total Acreage: _____
Workable Acreage: _____
Existing Farm Type: (for example: corn, orchard, livestock) _____
Dwelling Present?: Yes No If yes, year dwelling built _____
Date of Land Purchase: _____

Owners Name: _____
Roll Number: _____
Total Acreage: _____
Workable Acreage: _____
Existing Farm Type: (for example: corn, orchard, livestock) _____
Dwelling Present?: Yes No If yes, year dwelling built _____
Date of Land Purchase: _____

Owners Name: _____
Roll Number: _____
Total Acreage: _____
Workable Acreage: _____
Existing Farm Type: (for example: corn, orchard, livestock) _____
Dwelling Present?: Yes No If yes, year dwelling built _____
Date of Land Purchase: _____

Owners Name: _____
Roll Number: _____
Total Acreage: _____
Workable Acreage: _____
Existing Farm Type: (for example: corn, orchard, livestock) _____
Dwelling Present?: Yes No If yes, year dwelling built _____
Date of Land Purchase: _____

Note: If additional space is needed please attach a separate sheet.

D. All Applications: Previous Use of the Property

1. Has there been an industrial or commercial use on the subject lands or adjacent lands? Yes No Unknown

If yes, specify the uses (for example: gas station, or petroleum storage):

2. Is there reason to believe the subject lands may have been contaminated by former uses on the site or adjacent sites? Yes No Unknown

3. Provide the information you used to determine the answers to the above questions:
Information provided by owner.

4. If you answered yes to any of the above questions in Section D, a previous use inventory showing all known former uses of the subject lands, or if appropriate, the adjacent lands, is needed. Is the previous use inventory attached? Yes No

E. All Applications: Provincial Policy

1. Is the requested amendment consistent with the provincial policy statements issued under subsection 3(1) of the *Planning Act, R.S.O. 1990, c. P. 13*? Yes No

If no, please explain:

2. It is owner's responsibility to be aware of and comply with all relevant federal or provincial legislation, municipal by-laws or other agency approvals, including the Endangered Species Act, 2007. Have the subject lands been screened to ensure that development or site alteration will not have any impact on the habitat for endangered or threatened species further to the provincial policy statement subsection 2.1.7? Yes No

If no, please explain:

3. Have the subject lands been screened to ensure that development or site alteration will not have any impact on source water protection? Yes No

If no, please explain:

Property is not within a WHPA

Note: If in an area of source water Wellhead Protection Area (WHPA) A, B or C please attach relevant information and approved mitigation measures from the Risk Manager Official.

4. All Applications: Are any of the following uses or features on the subject lands or within 500 metres of the subject lands, unless otherwise specified? Please check boxes, if applicable.

Livestock facility or stockyard (submit MDS Calculation with application)

On the subject lands or within 500 meters – distance _____

Wooded area

On the subject lands or within 500 meters – distance 44m

Municipal Landfill

On the subject lands or within 500 meters – distance _____

Sewage treatment plant or waste stabilization plant

On the subject lands or within 500 meters – distance _____

Provincially significant wetland (class 1, 2 or 3) or other environmental feature

On the subject lands or within 500 meters – distance 44m

Floodplain

On the subject lands or within 500 meters – distance _____

Rehabilitated mine site

On the subject lands or within 500 meters – distance _____

Non-operating mine site within one kilometre

On the subject lands or within 500 meters – distance _____

Active mine site within one kilometre

On the subject lands or within 500 meters – distance _____

Industrial or commercial use (specify the use(s))

On the subject lands or within 500 meters – distance _____

Active railway line

On the subject lands or within 500 meters – distance _____

Seasonal wetness of lands

On the subject lands or within 500 meters – distance _____

Erosion

On the subject lands or within 500 meters – distance _____

Abandoned gas wells

On the subject lands or within 500 meters – distance _____

F. All Applications: Servicing and Access

1. Indicate what services are available or proposed:

Water Supply

- Municipal piped water
- Individual wells
- Communal wells
- Other (describe below)

Bowen water system.

Sewage Treatment

- Municipal sewers
 - Septic tank and tile bed in good working order
 - Communal system
 - Other (describe below)
-

Storm Drainage

- Storm sewers
 - Other (describe below)
 - Open ditches
-

2. Existing or proposed access to subject lands:

- Municipal road
- Unopened road
- Provincial highway
- Other (describe below)

Name of road/street:

Cedar Drive

G. All Applications: Other Information

1. Does the application involve a local business? Yes No

If yes, how many people are employed on the subject lands?

2. Is there any other information that you think may be useful in the review of this application? If so, explain below or attach on a separate page.

Premise and Justification report is attached

I. Transfers, Easements and Postponement of Interest

The owner acknowledges and agrees that if required it is their solicitor's responsibility on behalf of the owner for the registration of all transfer(s) of land to the County, and/or transfer(s) of easement in favour of the County and/or utilities. Also, the owner further acknowledges and agrees that it is their solicitor's responsibility on behalf of the owner for the registration of postponements of any charges in favour of the County.

Permission to Enter Subject Lands

Permission is hereby granted to Norfolk County officers, employees or agents, to enter the premises subject to this application for the purposes of making inspections associated with this application, during normal and reasonable working hours.

Freedom of Information

For the purposes of the *Municipal Freedom of Information and Protection of Privacy Act*, I authorize and consent to the use by or the disclosure to any person or public body any information that is collected under the authority of the *Planning Act, R.S.O. 1990, c. P. 13* for the purposes of processing this application.

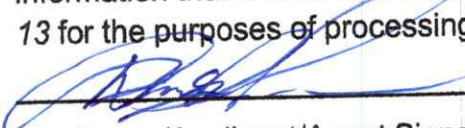

Owner/Applicant/Agent Signature



Date

J. Owner's Authorization

If the applicant/agent is not the registered owner of the lands that is the subject of this application, the owner must complete the authorization set out below.

I/We Vijay Kumar Pareek/Rushmita Pareek am/are the registered owner(s) of the lands that is the subject of this application.

I/We authorize David McPherson to make this application on my/our behalf and to provide any of my/our personal information necessary for the processing of this application. Moreover, this shall be your good and sufficient authorization for so doing.



Owner

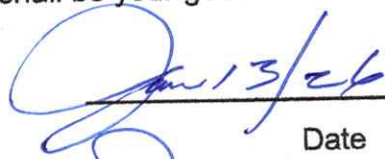

Date



Owner

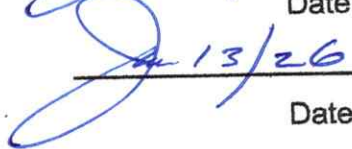

Date

***Note:** If property is owned by an Ontario Ltd. Corporation, Articles of Incorporation are required to be attached to the application.



K. Declaration

I, David McPherson of Simcoe

solemnly declare that:

all of the above statements and the statements contained in all of the exhibits transmitted herewith are true and I make this solemn declaration conscientiously believing it to be true and knowing that it is of the same force and effect as if made under oath and by virtue of *The Canada Evidence Act*.

Declared before me at:

Norfolk County



~~Owner/Applicant/Agent~~ Signature

In Simcoe

This 24 day of February

A.D., 2026

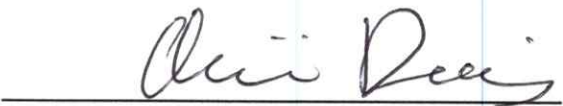

A Commissioner, etc.

Olivia Catherine Davies, a
Commissioner, etc., Province of Ontario,
for the Corporation of Norfolk County.
Expires May 23, 2027.

**Premise and Justification of
Minor Variance Application
for 231 Cedar Drive, Turkey Point**

This application is for the demolition of an existing single storey dwelling and the construction of a new 2-storey dwelling in its place.

Existing now, on the subject lands, as shown in the photo below, is a single storey dwelling, dating from the 1950's, of some 77.5 sq. m. in building area.



Proposed is a 2-storey dwelling of 124 sq. m., which includes an attached garage and front and rear decking. Attached are architectural plans of the proposed dwelling.

The property owner, Vijaykumar Parekh, is the proprietor of the Turkey Point Food Market, directly across the street at 230 Cedar Drive.

The application seeks relief of 4.77 m. of front yard setback, 2.48 m. of rear yard setback, 0.36 m. of left side yard setback, 0.36 m. of right side yard setback, 38.9% in lot coverage, and relief of 1 parking space.

The proposed cottage has been sited to sit directly upon the footprint of the existing cottage, with the exception that the front porch, encroaching onto the road allowance, is to be removed such that the new dwelling will be wholly contained on the lot.

The proposed new dwelling is not overly large, with the exception of the attached garage, it sits on the current dwelling's footprint.

Attached are copies of the architectural plans for the new dwelling, the existing survey, and the lot grading plan/site plan for the new dwelling.

This is a very small lot, even for Turkey Point, and that lot size constraint is what precipitates the requested reliefs in setback and lot coverage. The lots directly across the street adjacent the Turkey Point Food Market are all in the 1,000 sq. m. lot size range. On one of those lots, this dwelling would only amount to 12% lot coverage, smaller than the 15% permitted. It's only on account of the small lot size that coverage seems dramatic. However, in reality it is not.

Lot coverages in this area of Turkey Point are typically in the 45% range. On a similar sized lot on Ordnance Ave. is a cottage having 90% lot coverage, approved during an OMB hearing.

This proposal conforms to the Provincial Policy Statement 2024.

Under Section 45(1) of the Planning Act there are four tests a minor variance must meet. In order to be considered the application must meet all four tests:

- Does the application conform to the general intent and purpose of the Official Plan.
- Does the application conform to the general intent and purpose of the Zoning Bylaw.
- Is the application desirable for the appropriate development of the lands in question.
- Is the application minor.

Norfolk County Official Plan

The subject property is designated as Resort Residential in the Norfolk County Official Plan. Permitted uses within this designation include cottages. The application enables the continued use of a cottage in the Resort Residential designation and therefore conforms to the general intent and purpose of the Official Plan, including the Lakeshore Special Policy Area Secondary Plan.

Norfolk County Zoning By-law 1-Z-2014

Zoning By-law 1-Z-2014 zones the property Resort Residential. Article 5.8.1a) permits a dwelling, complete with an attached garage, within the Resort Residential Zone.

The general intent and purpose of the Norfolk County Zoning By-law is to maintain the character of the neighborhood. Turkey Point is a large, established cottage node within Norfolk County. The neighboring properties to 231 Cedar Drive, are all vacation homes. The proposed dwelling, with its attached garage, maintains the general large scale cottage character of the neighborhood, conforms to the established building line, and is compatible with the established streetscape. The requested variance will maintain the general intent and purpose of the Zoning By-law and will promote continued and better use of the subject property.

Is the Variance Desirable and Appropriate

The continued use of this property, with a modern up-to-date dwelling, is compatible with and fits within the existing neighborhood. Small, old, outdated cottages in Turkey Point have been demolished and rebuilt over the past 40 years. This proposal is an improvement of the property in that the new up-to-date dwelling, with its attached garage, is desirable and an appropriate reflection of the Cedar Drive streetscape.

Is the Variance Minor in Nature

The application is minor in nature, considering the lot size constraints, compared to the neighbourhood lot sizes. The requested decrease of front yard setback and side yard setbacks, along with the requested relief in lot coverage, is compatible with and fits within the existing neighbourhood. This proposal is an improvement of the property in that the proposed dwelling remedies an existing encroachment, and is a desirable and an appropriate reflection of the Cedar Drive streetscape. Further, the proposed dwelling impacts no other cottages in the neighbourhood.

Conclusion

The proposed redevelopment of an existing 75 year old dwelling meets the overall intent and purpose of the Planning Act, the Provincial Policy Statement, the Norfolk County Official Plan and the Norfolk County Zoning By-law. The application is a desirable and appropriate redevelopment of the subject lands.

David McPherson

SKETCH SHOWING PROPOSED DWELLING LOCATION

FOR:

VIJAY PAREKH
#231 CEDAR DRIVE
TURKEY POINT

PIN 50267 - 0240 (LT)

SCALE 1 : 100

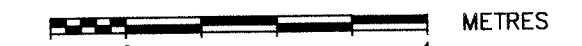

JEWITT AND DIXON LTD.

METRIC NOTE:

DISTANCES AND COORDINATES ARE METRIC AND CAN BE CONVERTED TO IMPERIAL BY DIVIDING BY 0.3048

UTILITY NOTE:

THE VARIOUS UTILITY LOCATIONS SHOWN ON THIS PLAN ARE BASED ON PHYSICAL LOCATES OF ABOVE GROUND SERVICES.

PRIOR TO ANY ON SITE CONSTRUCTION ACTIVITY A VERIFICATION LOCATE OF UNDERGROUND SERVICES IS BOTH RECOMMENDED AND ADVISED.

SITE B.M.#1
 SPIKE IN FACE OF WOOD HYDRO POLE
 ELEV = 176.80
 (GEODETIC)

LOT 141

LOT

142

128

PART 1, PLAN 37R-9762

EXISTING COVERAGE
35.6 %

PROPOSED COVERAGE
53.9 %

PLAN

LOT

PROPOSED DWELLING
124.2 sq.m

PROPOSED DECK
23.4 sq.m

PIN 50267 - 0240 (LT)
 PARCEL AREA = 292.3 sq.m

143
3.76

PROPOSED DRIVEWAY

PROPOSED GARAGE

CEDAR DRIVE

REGISTERED

144

LOT

NOTES

- (1) - A SURVEY OF THE SUBJECT PROPERTY WAS COMPLETED ON DECEMBER 28, 2024 (24-54-097-00)
- (4) - T.F.W. DENOTES TOP OF FOUNDATION WALL
- (5) - U.S.S. DENOTES UNDERSIDE OF SIDING
- (6) - F.F. DENOTES FINISHED FLOOR
- (9) - IT IS THE RESPONSIBILITY OF THE CONTRACTOR TO VERIFY THE SITE BENCH MARK PRIOR TO EXCAVATION
- (10) - ELEVATIONS ARE REFERRED TO CANADIAN GEODETIC DATUM, NAD83 (CSRS) HTv2.0 (2010) (CGVD28)
- (11) - THIS SKETCH WAS COMPLETED FROM FIELD WORK COMPLETED ON THE 10TH DAY OF DECEMBER, 2024

LEGEND

BELL BOX	SHOWN	BBX	□
BENCH MARK	SHOWN	BM	⊙
CATCH BASIN	SHOWN	CB	■
DOOR SILL	SHOWN	SILL	—
OVERHEAD HYDRO LINE	SHOWN	O/H	—
WATER VALVE	SHOWN	WV	⚙
HYDRO POLE	SHOWN	HP	⊙
GAS METER	SHOWN	GM	⊙
MANHOLE	SHOWN	MH	⊙

PROPERTY DESCRIPTION:
 PART LOT 143, REGISTERED PLAN 128
 GEOGRAPHIC TOWNSHIP OF CHARLOTTEVILLE
 TOGETHER WITH RIGHT-OF-WAY AS IN NR481922
 NORFOLK COUNTY

CAUTION
 THIS IS NOT A PLAN OF SURVEY OR SURVEYOR'S REPORT AND SHALL NOT BE USED FOR TRANSACTION OR FINANCING PURPOSES

© COPYRIGHT JEWITT AND DIXON LTD. 2026
 THE REPRODUCTION, ALTERATION, OR USE OF THIS REPORT IN WHOLE OR IN PART, WITHOUT THE WRITTEN PERMISSION OF JEWITT AND DIXON LTD. IS STRICTLY PROHIBITED

JANUARY 20, 2026

KIM HUSTED, O.L.S.
THIS COPY IS NOT VALID UNLESS EMBOSSED WITH THE SURVEYOR'S SEAL.

JEWITT AND DIXON SURVEYING
 ONTARIO LAND SURVEYORS MAPPING
 A Division of Kim Husted Surveying Ltd. GIS

650 Ireland Rd., Simcoe, ON N3Y 4K2
 T: (519) 426-0842 www.jdbarnes.com

DRAWN BY: JLM	CHECKED BY: KH	REFERENCE NO.: 24-54-097-00
		DATED: JANUARY 20, 2026

SITE B.M.#1
176.80



Evaluation of On-Site Sewage Systems

INSTRUCTIONS

1. Please complete the following form by checking appropriate lines and filling in blanks.
2. This Evaluation Form must be completed by a "Qualified" person engaged in the business of constructing on site, installing, repairing, servicing, cleaning or emptying sewage systems.
3. If sewage system malfunctions are found during an evaluation (surfacing or discharge of improperly treated sewage effluent) which indicate a possible health hazard or nuisance, orders may be issued for correction.
4. Evaluations should be scheduled accordingly so as not to delay the application process.
5. Completed Forms **MUST** be submitted as part of a "complete" Planning Application. Failure to meet this date may cause the application to be deferred.
6. Evaluation Forms will become part of the property records of Norfolk County Building Department.
7. No On-Site Sewage System Evaluation will be conducted where:
 - a. snow depth exceeds two (2) inches, or
 - b. grass and brush exceeds twelve (12) inches
8. The comments that are given as a result of this evaluation are rendered without complete knowledge or observation of some of the individual components of the sewage system and applies only to the date and time the evaluation is conducted.

Collection of Personal Information.

Personal information submitted in this form is collected under the authority with the Municipal Freedom of Information and Protection Act, or for the purpose stated on the specific form being submitted. The information will be used by the Building Department administration for its intended submitted purpose.

Questions about the collection of personal information through this form may be directed to:

Norfolk County's Chief Building Official,
185 Robinson Street, Simcoe, ON N3Y 5L6, 519-426-5870 ext. 2218,

Information and Privacy Coordinator,
50 Colborne Street South, Simcoe ON N3Y 4H3, 519-426-5870 ext. 1261,

Community Development Division- Building Department

185 Robinson Street, Suite 200, Simcoe, ON N3Y 5L6 • 519-426-5870 Ext. 6016

Property Information	
Municipal Address	231 Cedar Dr, Turkey point
Assessment Roll Number	
Date of Evaluation	March, 27, 2026

Evaluators Information	
Evaluators Name:	Gerald Livingston
Company Name:	L. Livingston Excavating Inc
Address:	638 Norfolk St S, Simcoe
Phone:	519 416 0333
Email	ethangl@livingstonexc.com
BCIN #	16633
Purpose of Evaluation	<input type="checkbox"/> Consent <input type="checkbox"/> Zoning <input checked="" type="checkbox"/> Minor Variance <input type="checkbox"/> Site Plan <input type="checkbox"/> Building Permit Application <input type="checkbox"/> Other _____
Building Information	<input checked="" type="checkbox"/> Residential <input type="checkbox"/> Commercial <input type="checkbox"/> Industrial <input type="checkbox"/> Agricultural

Gross building area: (m ²):	75
Number of bedrooms:	1
Number of fixture units:	10
Daily Design Flow: (Litres)	750
Is the building currently occupied?	<input checked="" type="checkbox"/> Yes <input type="checkbox"/> No If No, how long?

Site Evaluation	
Soil type, percolation time (T)	8 (Estimated)
Site slope	<input checked="" type="checkbox"/> Flat <input type="checkbox"/> Moderate <input type="checkbox"/> Steep
Soil condition:	<input type="checkbox"/> Wet <input checked="" type="checkbox"/> Dry
Surface discharge observed	<input type="checkbox"/> Yes <input checked="" type="checkbox"/> No
Odour detected:	<input type="checkbox"/> Yes <input checked="" type="checkbox"/> No
Weather at time of evaluation:	Windy/Sunny

System Description	
<input type="checkbox"/> Class 1 - Privy <input type="checkbox"/> Class 2- Greywater <input type="checkbox"/> Class 3 - Cesspool <input checked="" type="checkbox"/> Class 4 - Leaching Bed <input type="checkbox"/> Class 5 - Holding Tank	
Type of leaching bed. Class 4 –Leaching Bed only – Complete & attach Worksheet E	
<input type="checkbox"/> A. Absorption Trench	<input checked="" type="checkbox"/> B. Filter Bed
<input type="checkbox"/> C. Shallow Buried Trench	<input type="checkbox"/> D. Advance Treatment System
<input type="checkbox"/> E. Type A Dispersal Bed	<input type="checkbox"/> F. Type B Dispersal Bed

Existing Tank Size (litres):	
<input checked="" type="checkbox"/> Pre-cast Concrete	<input type="checkbox"/> Plastic
<input type="checkbox"/> Wood	<input type="checkbox"/> Fibreglass
<input checked="" type="checkbox"/> In ground system	<input type="checkbox"/> Other (specify):
<input type="checkbox"/> Raised Bed system	Pump: <input type="checkbox"/> Yes <input type="checkbox"/> No
Height raised above original grade (metres)	

Setbacks (metres)	Tank	Distribution Pipe
Distance to buildings & structures	2m	4m
Distance to bodies of water	N/A	N/A
Distance to nearest well	N/A	N/A
Distance to proposed property lines	Front: 40 Rear: 40	Left: 23 Right: 7
		Front: 5.5 Rear: 5.5
		Left: 11.5 Right: 7

Worksheet A: Dwellings - Daily Design Flow Calculations (Q)

A) Residential Occupancy		(Q) Litres	Total
Number of Bedrooms	1 Bedroom	750	1
	2 Bedrooms	1100	
	3 Bedrooms	1600	
	4 Bedrooms	2000	
	5 Bedrooms	2500	
		Subtotal (A)	750

B) Plus Additional Flow for:		Quantity	(Q) Litres	Total
Note: Use the largest additional flow calculation to determine Daily Design Flow (Q). If none apply Subtotal (B) is zero.				
Either	Each bedroom over 5		500	
Or	Floor space for each 10m ² over 200m ² up to 400m ²		100	
	Floor space for each 10m ² over 400m ² up to 600m ²		75	
	Floor space for each 10m ² over 600m ²		50	
Or	Each Fixture Unit over 20 fixture Units (Total of Worksheet B - 20 = Quantity)		50	
			Subtotal (B)	
Subtotal A+B=Daily Design Flow (Q)				750

Worksheet B: Dwellings Fixture Unit Count

Fixtures	Units		How Many?	Total
Bath group (toilet, sink, tub or shower) with flush tank	6.0	X	1	= 6
Bathtub only(with or without shower)	1.5	X		=
Shower stall	1.5	X		=
Wash basin / Lavatory (1.5 inch trap)	1.5	X		=
Water closet (toilet) tank operated	4.0	X		=
Bidet	1.0	X		=
Dishwasher	1.0	X	1	= 1
Floor Drain (3 inch trap)	3.0	X		=
Sink (with/without garbage grinder, domestic and other small type single, double or 2 single with a common trap)	1.5	X	1	= 1.5
Domestic washing machine	1.5	X	1	= 1.5
Combination sink and laundry tray single or double (installed on 1.5 inch trap)	1.5	X		=
Other:				
Total Number of Fixture Units:				10

1. Refer to Ontario Building Code Division B Table 7.4.9.3 for a complete listing of fixture types and units.
2. Where the laundry waste is not more than 20% of the total daily design flow, it may discharge to the sewage system. OBC 8.1.3.1(2)
3. Sump pumps are not to be connected to the sewage system. Connection to sewage system may lead to a hydraulic failure of the system.

Worksheet C: Other occupancies types

Camp for the Housing of Workers	Number of Employees	(Q) Litres	Total
Note: building size, number of bedrooms and fixture count are not required for a Camp for the Housing of Workers		250	
Daily Design Flow (Q)			

Other Occupancy Daily Design Flow Calculation (Q)

To calculate the daily design flow for occupancies, please refer to Ontario Building Code Division B – Part 8 Table 8.2.1.3.B

Establishment	Operator Example: number of seats, per floor area, number of employees/students	Volume Litres	Total
Daily Design Flow (Q)			

Work Sheet D: Septic Tank Size

Minimum septic tank size permitted by the Ontario Building Code is 3600 litres.

Minimum holding tank size permitted by the Ontario Building Code is 9000 litres.

Occupancy type	Daily Design Flow (Q)	Minimum tank size (L)
Residential Occupancy house, apartment, camp for housing of workers	750	X 2 = 1500L
All Other Occupancies		X 3 =
Holding Tank		X 7 =

Worksheet E: Leaching Bed Calculations (Class 4)

Complete One of A, B, C, D, E, F		
<input type="checkbox"/> A. Absorption Trench		
Total length of distribution pipe	Conventional $(Q \times T) \div 200 =$ _____ m Type I leaching chambers $(Q \times T) \div 200 =$ _____ m Type II leaching chambers $(Q \times T) \div 300 =$ _____ m Configured as: _____ runs of _____ m Total: _____ m	
<input type="checkbox"/> B. Filter Bed		
Effective Area If $Q \leq 3000$ litres per day use $Q \div 75$ If $Q > 3000$ litres per day use $Q \div 50$ Level II-IV treatment units, use $Q \div 100$ Distribution Pipe Contact Area = $(Q \times T) \div 850$ Mantel (see Part 1)	Effective area: $\frac{750}{4.2}$ (Q) \div $\frac{75}{2.38}$ (75, 50, or 100) = <u>10</u> m ² Configured as: _____ m x _____ m Number of beds _____ Number of runs: <u>3</u> Spacing of runs: <u>.6</u> m Contact Area: $(\frac{750}{m^2} (Q) \times 8 (T)) \div 850 =$ <u>7</u> m ²	
<input type="checkbox"/> C. Shallow Buried Trench		
Percolation time (T) of soil in minutes:	Length of distribution pipe (metres)	$(L) =$ _____ (Q) \div _____ (75, 50, 30) = _____ m Configured as: _____ runs of _____ m Total: _____ m
1 < T ≤ 20	Q ÷ 75 metres	
20 < T ≤ 50	Q ÷ 50 metres	
50 < T < 125	Q ÷ 30 metres	
<input type="checkbox"/> D. Advance Treatment System		
Provide description of system.		
<input type="checkbox"/> E. Type A Dispersal Bed		
Stone Layer If $Q \leq 3000$ litres per day, use $Q \div 75$ If $Q > 3000$ litres per day, use $Q \div 50$ Sand Layer 1 < T ≤ 15 use $(Q \times T) \div 850$ T > 15 use $(Q \times T) \div 400$	Stone Layer = _____ (Q) \div _____ (75 or 50) = _____ m ² Sand Layer = (_____ (Q) x _____ (T)) \div (850 or 400) = _____ m ²	
<input type="checkbox"/> F. Type B Dispersal Bed		
Area = $(Q \times T) \div 400$ Linear Loading Rate (LLR) T < 24 minutes, use 50 L/min If T ≥ 24 minutes, use 40 L/min Distribution Pipe	Area = (_____ (Q) x _____ (T)) \div 400 = _____ m ² Pump chamber capacity = _____ L Length (Q ÷ LLR) = _____ m Bed configuration = _____ m x _____ m = _____ m ² Number of Beds = _____ Configured as: _____ runs of _____ m Total: _____ m	

Worksheet F: Cross Sectional Drawings

Subsoil Investigation – Test pit

1. Soil sample to be taken at a depth of
2. Test pit to be a minimum 0.9m

Indicate level of rock and ground water level below original grade.

	Original grade
Topsoil	0.5m
Sand	1.0m
Water Table	1.5m

Soil and subgrade investigation. Indicate soil types

- Sand

Cross sectional drawings are required for all septic systems

1. Location of existing grade.
2. Measurements to each component, distances to water table
3. Label each septic component.

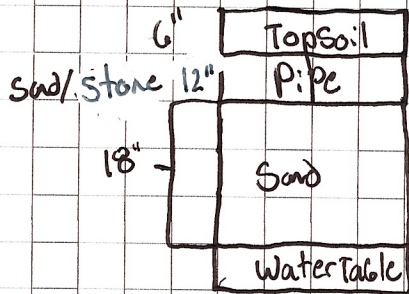

Overall System Rating

- System working properly / no work required.
- System functioning / Maintenance required.
- System functioning / Minor repairs required
- System failure / Replacement required.

Additional Comments:

Note: Any repair or replacement of an on-site sewage system requires a building permit.

Contact the Norfolk County Building Department at (519) 426-5870 ext. 6016 for more information.

Verification

Owner:

The owner is responsible for having a site evaluation conducted of the above mentioned property. Neither the evaluation nor the approval thereof shall exempt the owner(s) from complying with the Ontario Building Code or any other applicable law.

Vijaykumar Parekh

I, _____ (the owner of the subject property) hereby authorize the above mentioned evaluator to act on my behalf with respects to all matters pertaining to the existing onsite sewage system evaluation.

Owners Signature: 

Date: March 27, 2026

Evaluator:

I, Gerald H. Kingston declare that this site evaluation is accurate as of the date of inspection. No determination of future performance can be made due to unknown conditions, future water usage over the life of the system, abuse of the system and/or inadequate maintenance, all of which can affect the life of the system. This evaluation does not grant or imply any guarantee or warranty of the future performance of the sewage system. The undersigned takes no responsibility for the accuracy of existing or proposed property lines, whether measured or implied.

Evaluator Signature: 

Date: March, 27, 2026

Building Department Review

Comments: *Septic is in good working condition and functioning properly*

Building Inspectors Name:

Building Inspector Signature:

Date:

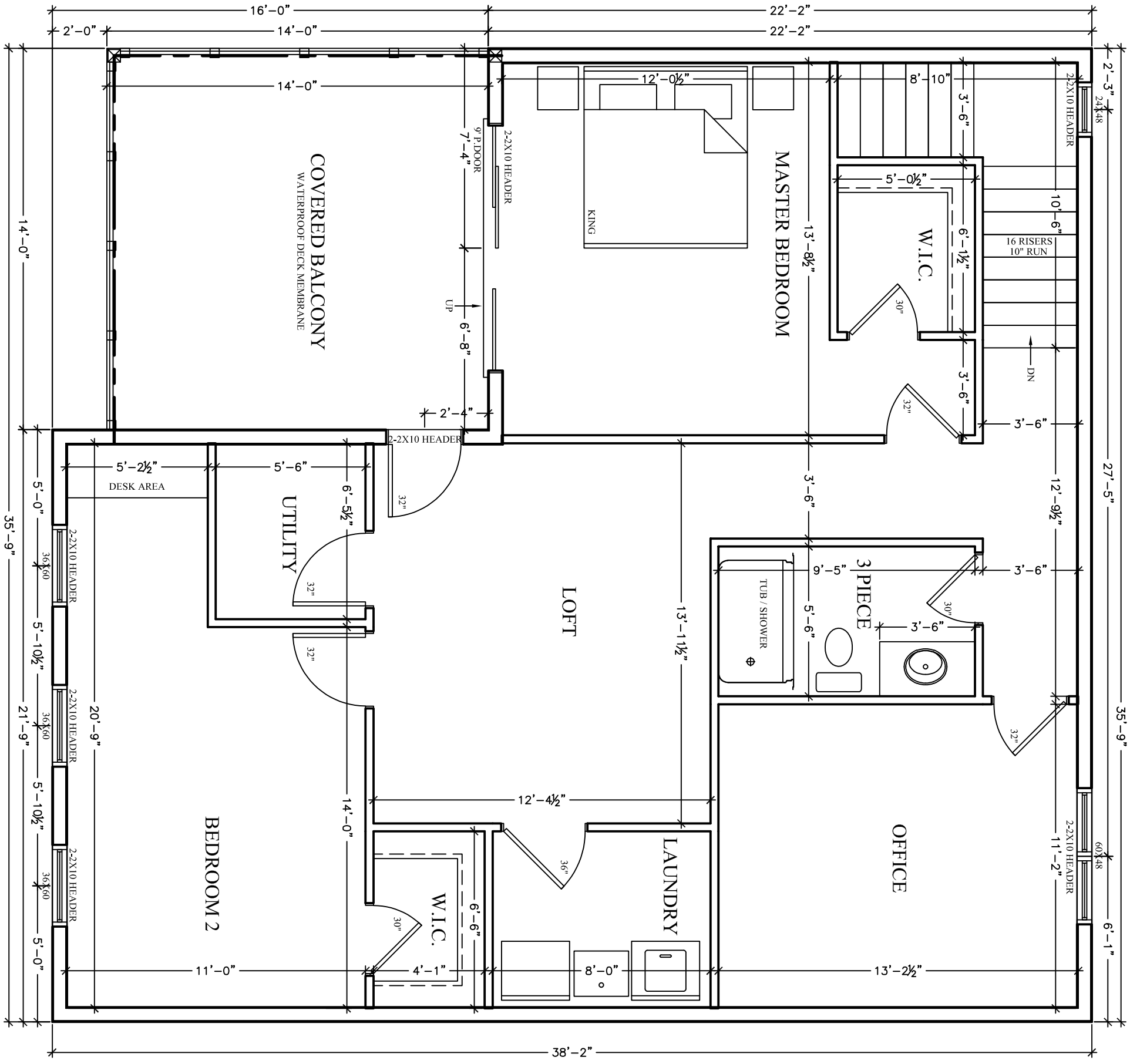









MAP A
CONTEXT MAP
Geographic Township of CHARLOTTEVILLE

ANPL2026054



Legend

 Subject Lands

5/5/2026

2025 Air Photo

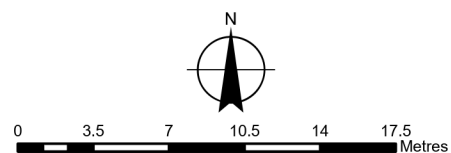

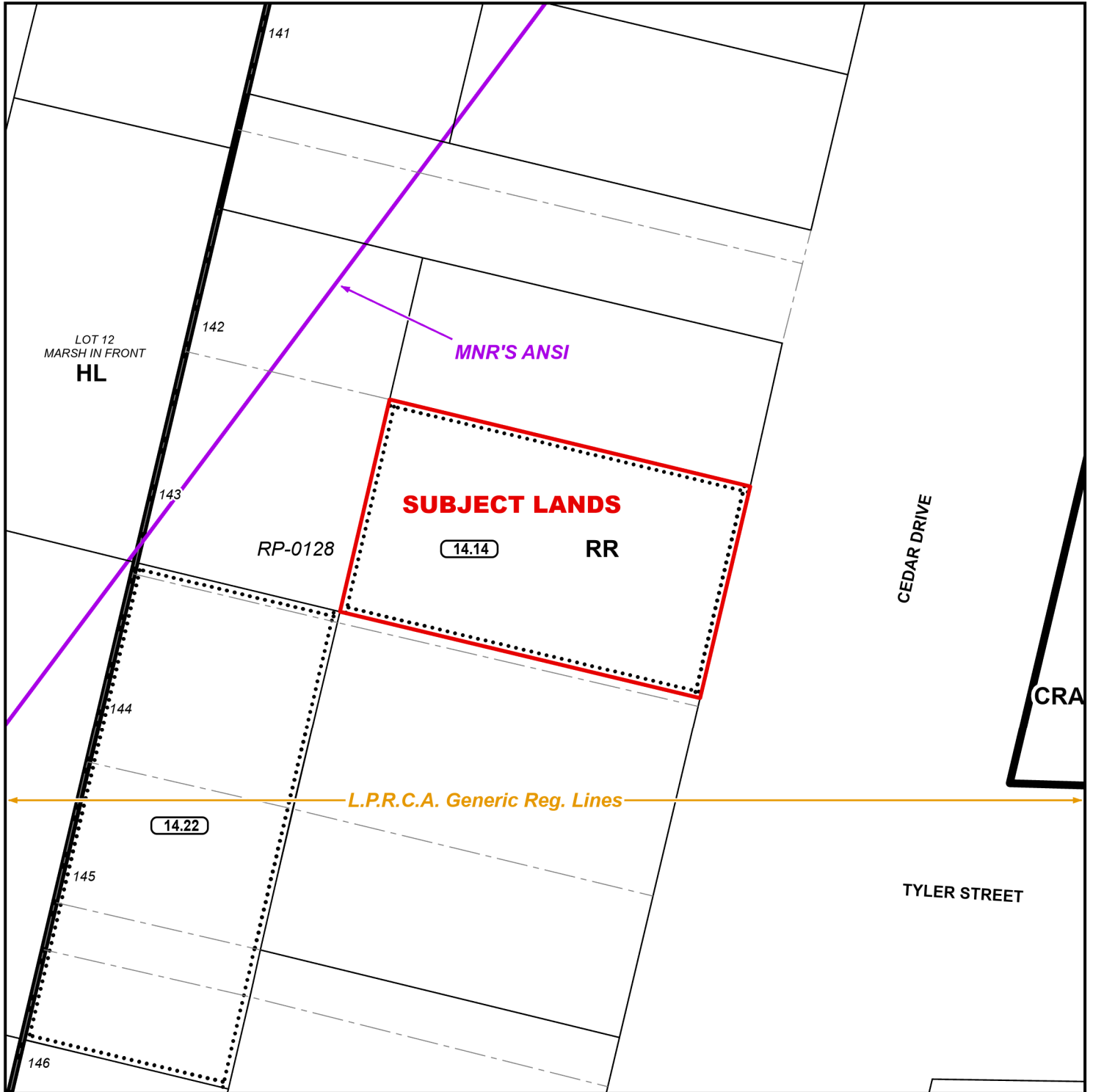

LEGEND

- Subject Lands
- Adjacent Lands
- MNR ANSI
- LPRCA Generic RegLines

ZONING BY-LAW 1-Z-2014

5/5/2026

- (H) - Holding
- CRA - Resort Area Commercial Zone
- HL - Hazard Land Zone
- RR - Resort Residential Zone

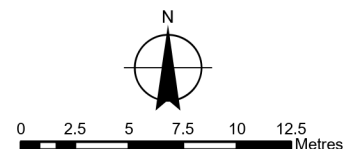

CONCEPTUAL PLAN

Geographic Township of CHARLOTTEVILLE

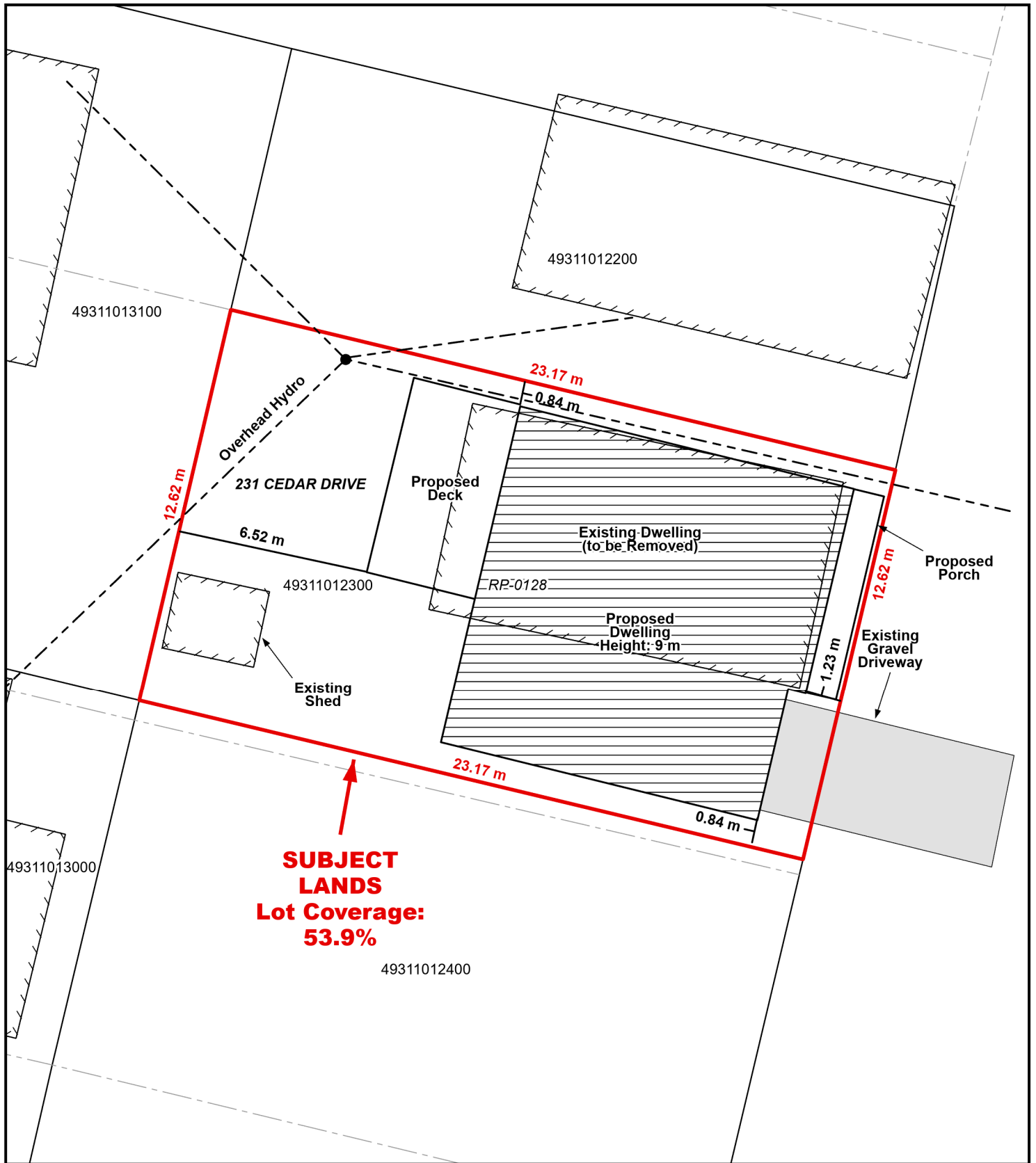

Legend

 Subject Lands

5/5/2026

