

**For Office Use Only:**

File Number

Related File Number

Pre-consultation Meeting

Application Submitted

Complete Application

BNPL2017140  
BNPL2017139  
June 29/17  
July 5/17  
July 5/17

Application Fee

Conservation Authority Fee

OSSD Form Provided

Planner

Public Notice Sign

\$1842

with related app.

Alison

**Check the type of planning application(s) you are submitting.**



Consent/Severance



Surplus Farm Dwelling Severance and Zoning By-law Amendment



Minor Variance

**Property Assessment Roll Number:** 33-10-336-080-237-10-0000

**A. Applicant Information**

**Name of Owner**

Jose F. Vaz, Leri-Ann Vaz

It is the responsibility of the owner or applicant to notify the planner of any changes in ownership within 30 days of such a change.

**Address**

1366 Cocksfoot Rd

**Town and Postal Code**

Simcoe N3Y 4K3

**Phone Number**

519 427-3549

**Cell Number**

519 427-3549

**Email**

sales@vazdrywall.com

**Name of Agent**

**Address**

**Town and Postal Code**

**Phone Number**

**Cell Number**

**Email**

Please specify to whom all communications should be sent. Unless otherwise directed, all correspondence, notices, etc., in respect of this application will be forwarded to the agent noted above



Owner



Agent



NORFOLK COUNTY  
COMMUNITY  
PLANNING  
DEVELOPMENT AND CULTURAL SERVICES

Names and addresses of any holder of any mortgagees, charges or other encumbrances on the subject lands:

The Royal Bank of Canada

**B. Location, Legal Description and Property Information**

1. Legal Description (include Geographic Township, Concession Number, Lot Number, Block Number and Urban Area or Hamlet): Lot 13, Concession 12, Townsenc Township - Norfolk County

Municipal Civic Address: 1366 Cockshutt Road, Simcoe ON

Present Official Plan Designation(s): Agricultural

Present Zoning: Agricultural

2. Is there a special provision or site specific zone on the subject lands?

☐ Yes ☒ No If yes, please specify:

3. The date the subject lands was acquired by the current owner: 06/2001

4. Present use of the subject lands: residential

5. Please describe **all existing** buildings or structures on the subject lands and whether they are to be retained, demolished or removed. If retaining the buildings or structures, please describe the type of buildings or structures, and illustrate the setback, in metric units, from front, rear and side lot lines, ground floor area, gross floor area, lot coverage, number of storeys, width, length, height, etc. on your attached sketch which must be included with your application: house, shed on retained lands - being kept one shed on severed being moved.
6. If known, the date existing buildings or structures were constructed on the subject lands: 2002
7. If an addition to an existing building is being proposed, please explain what will it be used for (e.g. bedroom, kitchen, bathroom, etc.). If new fixtures are proposed, please describe.

8. Please describe **all proposed** buildings or structures/additions on the subject lands. Describe the type of buildings or structures/additions, and illustrate the setback, in metric units, from front, rear and side lot lines, ground floor area, gross floor area, lot coverage, number of storeys, width, length, height, etc. on your attached sketch which must be included with your application: None

9. If known, the date the proposed buildings or structures will be constructed on the subject lands:

NA

10. Are any existing buildings on the subject lands designated under the *Ontario Heritage Act* as being architecturally and/or historically significant? Yes ☐ No ☐

If yes, identify and provide details of the building:

11. If known, the length of time the existing uses have continued on the subject lands:

15 yrs

12. Existing use of abutting properties:

agricultural, residential

13. Are there any easements or restrictive covenants affecting the subject lands?

☐ Yes ☒ No If yes, describe the easement or restrictive covenant and its effect:

### C. Purpose of Development Application

Note: Please complete all that apply.

#### 1. Site Information

#### Existing

#### Proposed

Please indicate unit of measurement, i.e. m, m<sup>2</sup> or %, etc.

Lot frontage

\_\_\_\_\_

\_\_\_\_\_

Lot depth

\_\_\_\_\_

\_\_\_\_\_

Lot width

\_\_\_\_\_

\_\_\_\_\_

Lot area

\_\_\_\_\_

\_\_\_\_\_

Lot coverage

\_\_\_\_\_

\_\_\_\_\_

Front yard	_____	_____
Rear yard	_____	_____
Left Interior side yard	_____	_____
Right Interior side yard	_____	_____
Exterior side yard (corner lot)	_____	_____

2. Please outline the relief requested (assistance is available):

3. Please explain why it is not possible to comply with the provision(s) of the Zoning By-law:

4. Description of land intended to be severed in metric units:

Frontage: none

Depth: 36.17m (irregular)

Width: 11.278 m (irregular)

Lot Area: 360.46 m<sup>2</sup>

Present Use: residential

Proposed Use: residential

Proposed final lot size (if boundary adjustment): 1817.33 m<sup>2</sup>

Description of land intended to be retained in metric units:

Frontage: 57.27 m

Depth: 50.24m (irregular)

Width: 57.27 m (irregular)

Lot Area: 2838 m<sup>2</sup>

Present Use: residential

Proposed Use: residential

5. Description of proposed right-of-way/easement in metric units:

Frontage: \_\_\_\_\_

Depth: \_\_\_\_\_

Width: \_\_\_\_\_

Area: \_\_\_\_\_

Proposed use: \_\_\_\_\_

6. Name of person(s), if known, to whom lands or interest in lands to be transferred, leased or charged (if known):

7. List all properties in Norfolk County, which are owned and farmed by the applicant and involved in the farm operation:

Owners Name: \_\_\_\_\_

Roll Number: \_\_\_\_\_

Total Acreage: \_\_\_\_\_

Workable Acreage: \_\_\_\_\_

Existing Farm Type: (i.e., corn, orchard etc) \_\_\_\_\_

Dwelling Present?: ☐ Yes ☐ No If yes, year dwelling built \_\_\_\_\_

Owners Name: \_\_\_\_\_

Roll Number: \_\_\_\_\_

Total Acreage: \_\_\_\_\_

Workable Acreage: \_\_\_\_\_

Existing Farm Type: (i.e., corn, orchard etc) \_\_\_\_\_

Dwelling Present?: ☐ Yes ☐ No If yes, year dwelling built \_\_\_\_\_

Owners Name: \_\_\_\_\_

Roll Number: \_\_\_\_\_

Total Acreage: \_\_\_\_\_

Workable Acreage: \_\_\_\_\_

Existing Farm Type: (i.e., corn, orchard etc) \_\_\_\_\_

Dwelling Present?: ☐ Yes ☐ No If yes, year dwelling built \_\_\_\_\_



Owners Name: \_\_\_\_\_  
Roll Number: \_\_\_\_\_  
Total Acreage: \_\_\_\_\_  
Workable Acreage: \_\_\_\_\_  
Existing Farm Type: (i.e., corn, orchard etc) \_\_\_\_\_  
Dwelling Present?: ☐ Yes ☒ No If yes, year dwelling built \_\_\_\_\_

**Note: If additional space is needed please attach a separate sheet.**

#### **D. Previous Use of the Property**

1. Has there been an industrial or commercial use on the subject lands or adjacent lands? ☐ Yes ☒ No ☐ Unknown  
If yes, specify the uses (example: gas station, petroleum storage, etc.): \_\_\_\_\_
2. Has the grading of the subject lands been changed through excavation or the addition of earth or other material? ☐ Yes ☒ No ☐ Unknown
3. Is there reason to believe the subject lands may have been contaminated by former uses on the site or adjacent sites? ☐ Yes ☒ No ☐ Unknown
4. Provide the information you used to determine the answers to the above questions:  
*personal knowledge*
5. If you answered yes to any of the above questions in Section D, a previous use inventory showing all known former uses of the subject lands, or if appropriate, the adjacent lands, is needed. Is the previous use inventory attached? ☐ Yes ☒ No

#### **E. Provincial Policy**

1. Is the requested amendment consistent with the provincial policy statements issued under subsection 3(1) of the *Planning Act*, R.S.O. 1990, c. P. 13? ☒ Yes ☐ No  
If no, please explain: \_\_\_\_\_

2. It is owner's responsibility to be aware of and comply with all relevant federal or provincial legislation, municipal by-laws or other agency approvals, including the Endangered Species Act, 2007. Have the subject lands been screened to ensure that development or site alteration will not have any impact on the habitat for endangered or threatened species further to the provincial policy statement subsection 2.1.7? ☒ Yes ☐ No

If no, please explain:

3. Have the subject lands been screened to ensure that development or site alteration will not have any impact on source water protection? ☒ Yes ☐ No

If no, please explain:

Note: If in an area of source water WHPA A, B or C please attach relevant information and approved mitigation measures from the Risk Manager Official.

4. Are any of the following uses or features on the subject lands or within 500 metres of the subject lands, unless otherwise specified? Please check boxes, if applicable.

**Livestock facility or stockyard** (submit MDS Calculation with application)

☐ On the subject lands or ☐ within 500 meters – distance \_\_\_\_\_

**Wooded area**

☐ On the subject lands or ☒ within 500 meters – distance 28 m

**Municipal Landfill**

☐ On the subject lands or ☐ within 500 meters – distance \_\_\_\_\_

**Sewage treatment plant or waste stabilization plant**

☐ On the subject lands or ☐ within 500 meters – distance \_\_\_\_\_

**Provincially significant wetland (class 1, 2 or 3) or other environmental feature**

☐ On the subject lands or ☐ within 500 meters – distance \_\_\_\_\_

**Floodplain**

☐ On the subject lands or ☐ within 500 meters – distance \_\_\_\_\_

**Rehabilitated mine site**

☐ On the subject lands or ☐ within 500 meters – distance \_\_\_\_\_

**Non-operating mine site within one kilometre**

☐ On the subject lands or ☐ within 500 meters – distance \_\_\_\_\_

**Active mine site within one kilometre**

☐ On the subject lands or ☐ within 500 meters – distance \_\_\_\_\_

**Industrial or commercial use (specify the use(s))**

☐ On the subject lands or ☐ within 500 meters – distance \_\_\_\_\_

**Active railway line**

☐ On the subject lands or ☐ within 500 meters – distance \_\_\_\_\_

**Seasonal wetness of lands**

☐ On the subject lands or ☐ within 500 meters – distance \_\_\_\_\_

**Erosion**

☐ On the subject lands or ☐ within 500 meters – distance \_\_\_\_\_

**Abandoned gas wells**

☐ On the subject lands or ☐ within 500 meters – distance \_\_\_\_\_

**F. Servicing and Access**

1. Indicate what services are available or proposed:

**Water Supply**

☐ Municipal piped water

☐ Communal wells

☒ Individual wells

☐ Other (describe below)

**Sewage Treatment**

☐ Municipal sewers

☐ Communal system

☒ Septic tank and tile bed

☐ Other (describe below)



Storm Drainage

☐ Storm sewers

☐ Open ditches

☒ Other (describe below)

natural drainage

2. Have you consulted with Public Works & Environmental Services concerning storm water management?

☐ Yes ☒ No

3. Has the existing drainage on the subject lands been altered?

☐ Yes ☒ No

4. Does a legal and adequate outlet for storm drainage exist?

☒ Yes ☐ No

5. Existing or proposed access to subject lands:

☒ Municipal road

☐ Provincial highway

☐ Unopened road

☐ Other (describe below)

Name of road/street:

Cockshutt Rd, Concession 13 Townsend

**G. Other Information**

1. Does the application involve a local business? ☐ Yes ☒ No

If yes, how many people are employed on the subject lands?

2. Is there any other information that you think may be useful in the review of this application? If so, explain below or attach on a separate page.

additional land for an accessory building

## **H. Supporting Material to be submitted by Applicant**

In order for your application to be considered complete, folded hard copies (number of paper copies as directed by the planner) and an **electronic version (PDF) of the site plan drawings, additional plans, studies and reports** will be required, including but not limited to the following details:

1. Concept/Layout Plan
2. All measurements in metric
3. Existing and proposed easements and right of ways
4. Parking space totals – required and proposed
5. All dimensions of the subject lands
6. Dimensions and setbacks of all buildings and structures
7. Names of adjacent streets
8. Natural features, watercourses and trees

In addition, the following additional plans, studies and reports, including but not limited to, **may** also be required as part of the complete application submission:

- ☐ Zoning Deficiency Form
- ☐ On-Site Sewage Disposal System Evaluation Form
- ☐ Environmental Impact Study
- ☐ Geotechnical Study / Hydrogeological Review
- ☐ Minimum Distance Separation Schedule
- ☐ Record of Site Condition

Your development approval might also be dependent on Ministry of Environment and Climate Change, Ministry of Transportation or other relevant federal or provincial legislation, municipal by-laws or other agency approvals.

**All final plans must include the owner's signature as well as the engineer's signature and seal.**

### I. Transfers, Easements and Postponement of Interest

The owner acknowledges and agrees that if required it is their solicitor's responsibility on behalf of the owner for the registration of all transfer(s) of land to the County, and/or transfer(s) of easement in favour of the County and/or utilities. Also, the owner further acknowledges and agrees that it is their solicitor's responsibility on behalf of the owner for the registration of postponements of any charges in favour of the County.

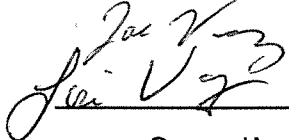
  
\_\_\_\_\_  
Owner/Applicant Signature

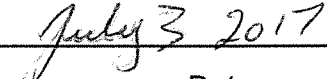
  
\_\_\_\_\_  
Date

### J. Permission to Enter Subject Lands

Permission is hereby granted to Norfolk County officers, employees or agents, to enter the premises subject to this application for the purposes of making inspections associated with this application, during normal and reasonable working hours.

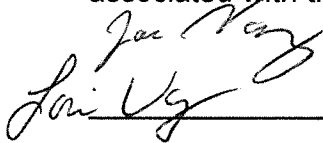
  
\_\_\_\_\_  
Owner/Applicant Signature

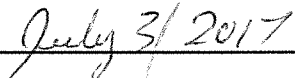
  
\_\_\_\_\_  
Date

### K. Freedom of Information

For the purposes of the *Municipal Freedom of Information and Protection of Privacy Act*, I authorize and consent to the use by or the disclosure to any person or public body any information that is collected under the authority of the *Planning Act*, R.S.O. 1990, c. P. 13 for the purposes of processing this application.

  
\_\_\_\_\_  
Owner/Applicant Signature

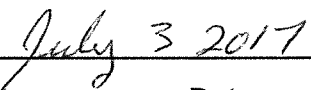
  
\_\_\_\_\_  
Date

#### L. Owner's Authorization

If the applicant/agent is not the registered owner of the lands that is the subject of this application, the owner must complete the authorization set out below.

I/We Lori-Ann Vaz am/are the registered owner(s) of the lands that is the subject of this application for site plan approval.

I/We authorize Jose Vaz to make this application on my/our behalf and to provide any of my/our personal information necessary for the processing of this application. Moreover, this shall be your good and sufficient authorization for so doing.

Jos Vaz  
Owner

July 4/2017  
Date

\_\_\_\_\_  
Owner

\_\_\_\_\_  
Date

#### M. Declaration of Applicant and Agent

I hereby apply for development approval and declare that all of the above statements and the statements contained in all of the exhibits transmitted herewith are accurate and true. I understand that site plan approval is required before a building permit can be issued.

Jos Vaz  
Applicant Signature

July 4/2017  
Date

\_\_\_\_\_  
Agent Signature

\_\_\_\_\_  
Date

**N. Declaration**

I, Joe Vaz of Norfolk County

solemnly declare that:

all of the above statements and the statements contained in all of the exhibits transmitted herewith are true and I make this solemn declaration conscientiously believing it to be true and knowing that it is of the same force and effect as if made under oath and by virtue of *The Canada Evidence Act*.

Declared before me at:

185 Robinson St.

  
Owner/Applicant Signature

In Simcoe, ON

This 5<sup>th</sup> day of July

A.D., 20 17

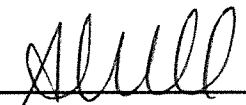

A Commissioner, etc.

# Farm land

Cock shutt rd

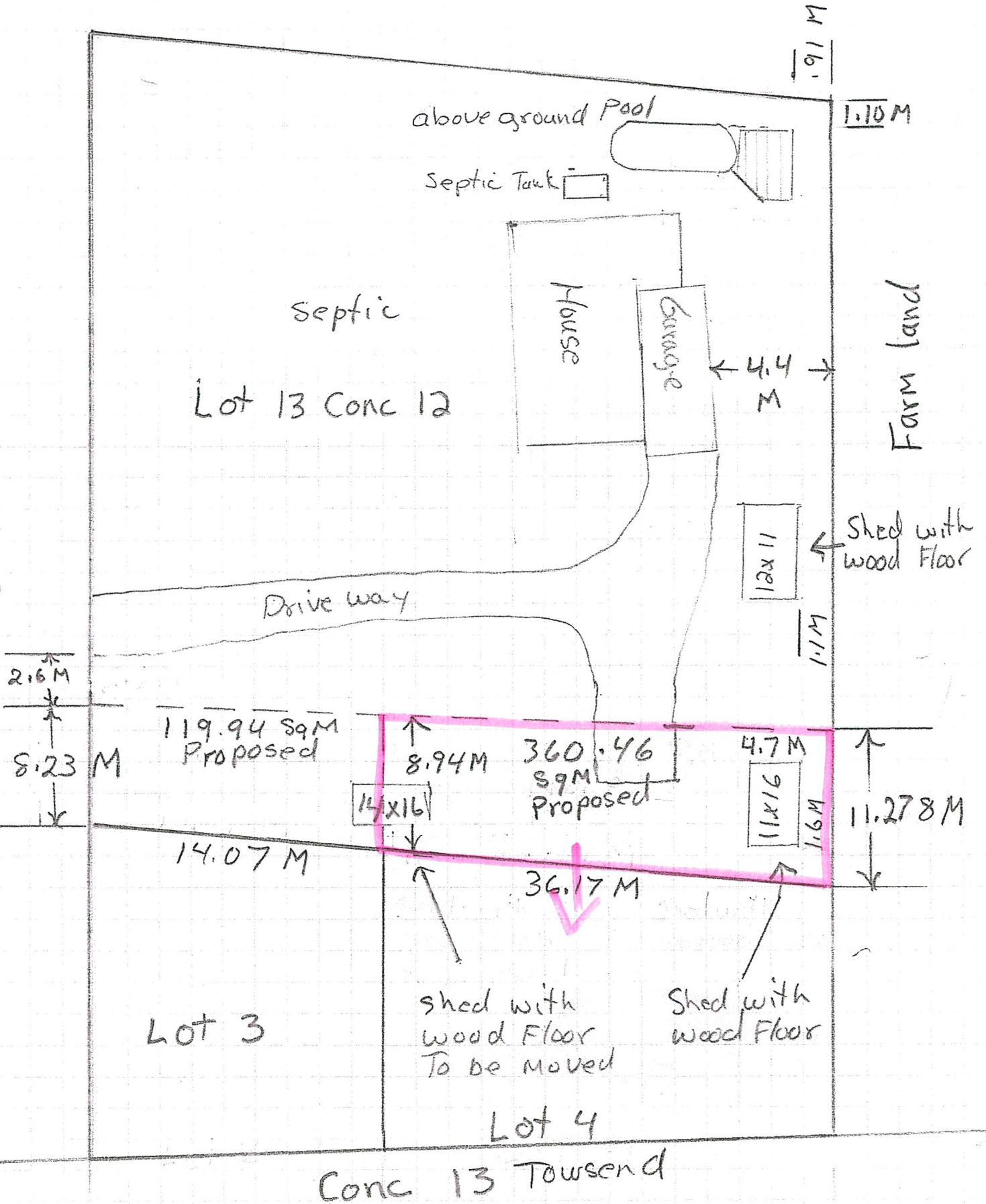

# MAP 1

## File Number: BNPL2017139 & BNPL2017140

Geographic Township of  
**TOWNSEND**

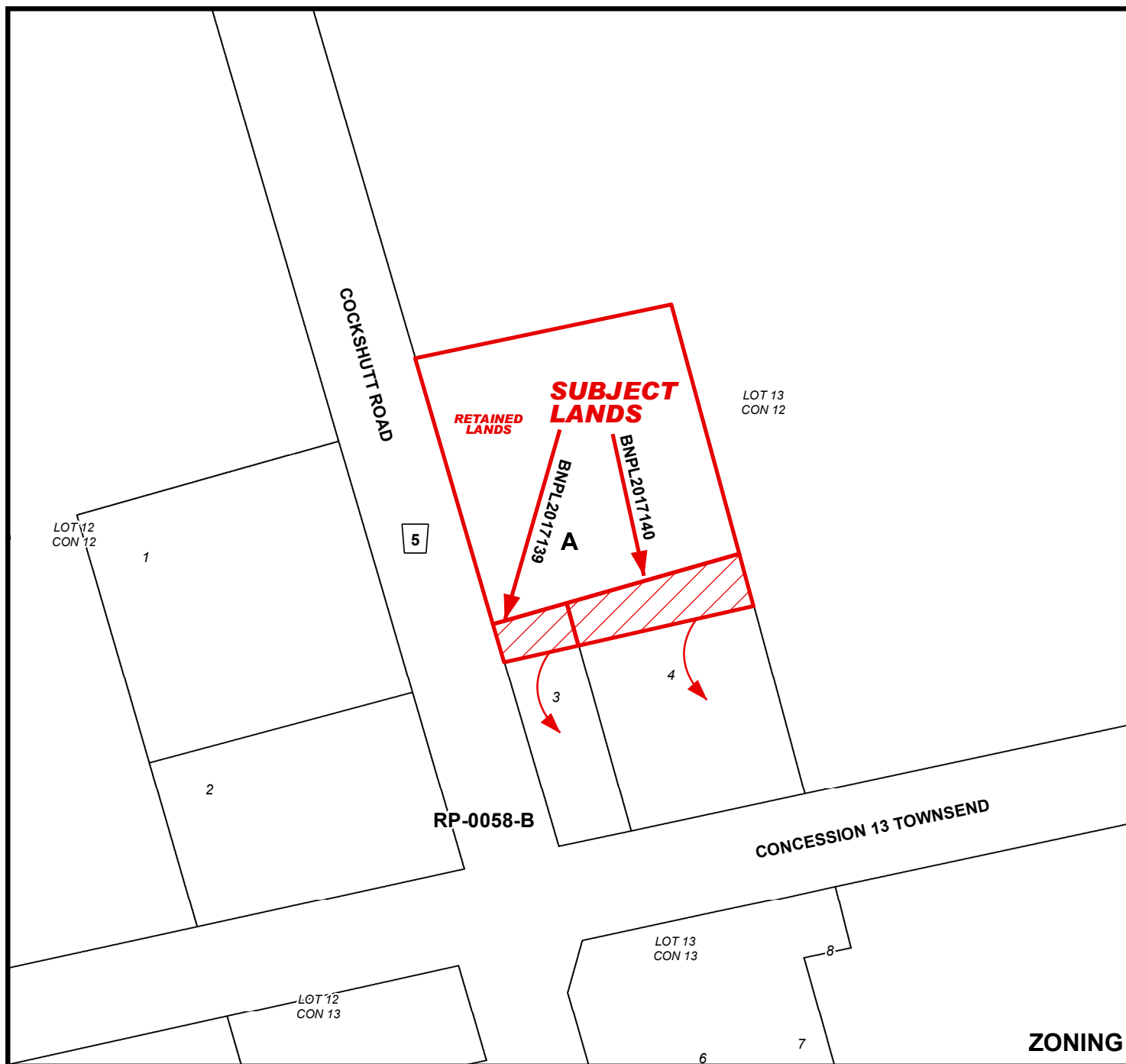
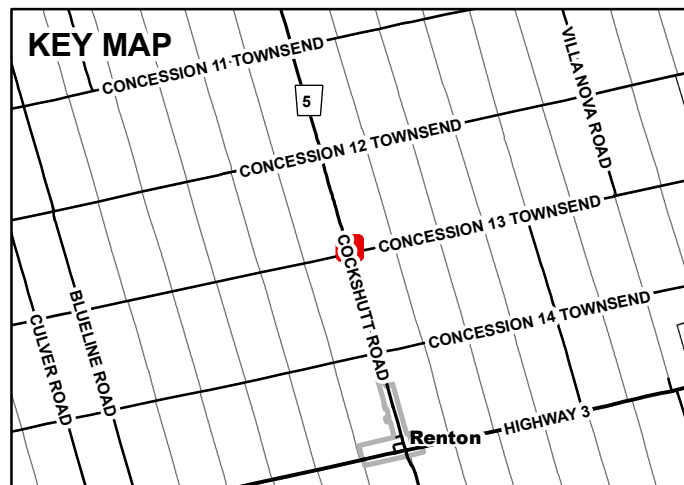
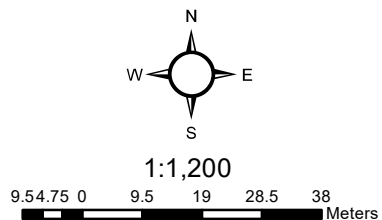

# MAP 2

File Number: BNPL2017139 & BNPL2017140

Geographic Township of TOWNSEND

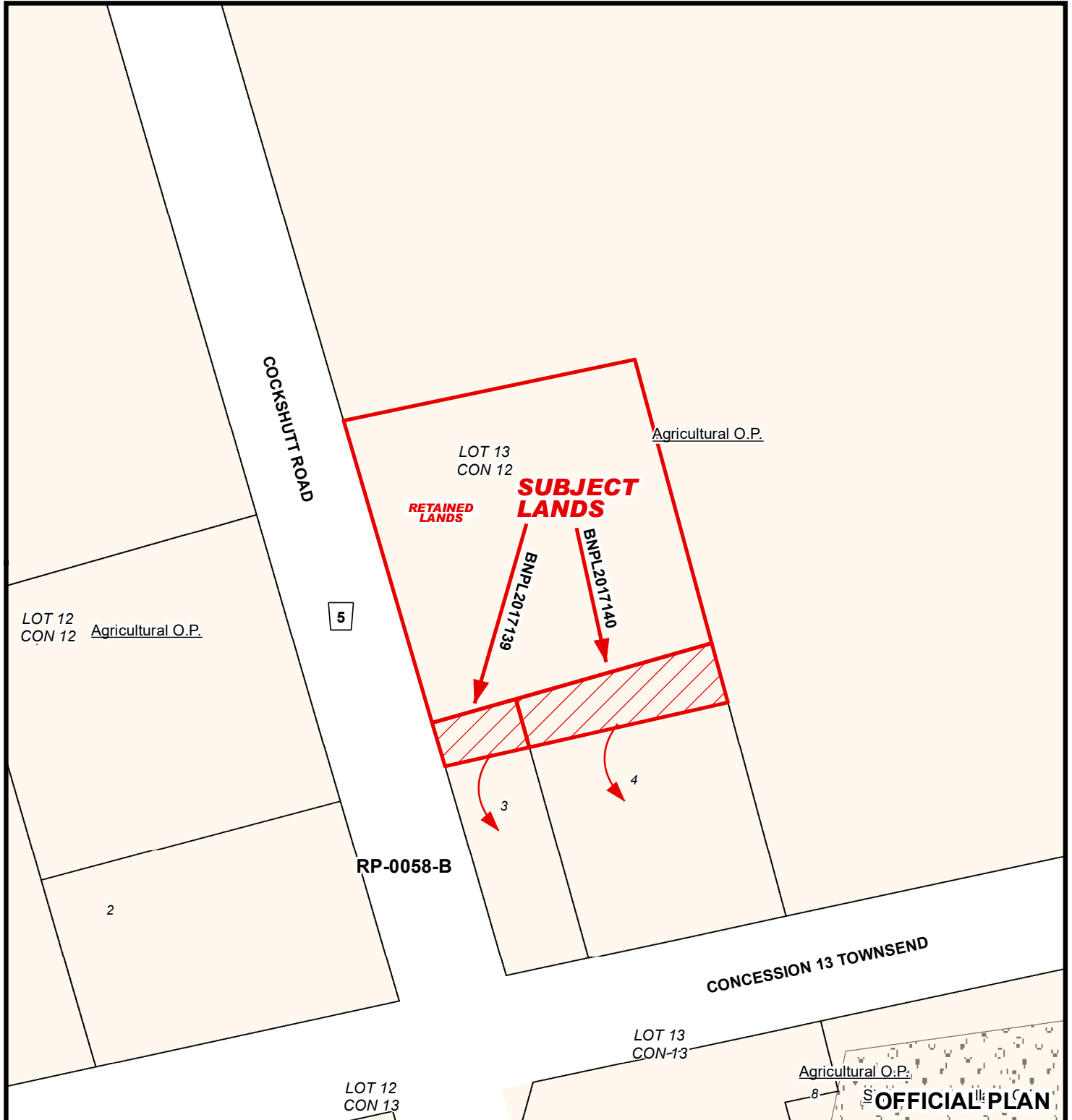
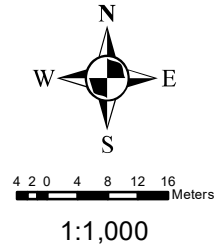



# MAP 3

File Number: BNPL2017139 & BNPL2017140

Geographic Township of TOWNSEND

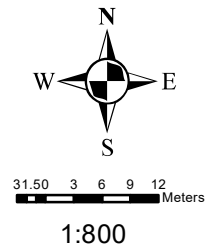

# MAP 4

File Number: BNPL2017139 & BNPL2017140

Geographic Township of TOWNSEND



2.5 2.5 5 7.5 10 Meters

1:700

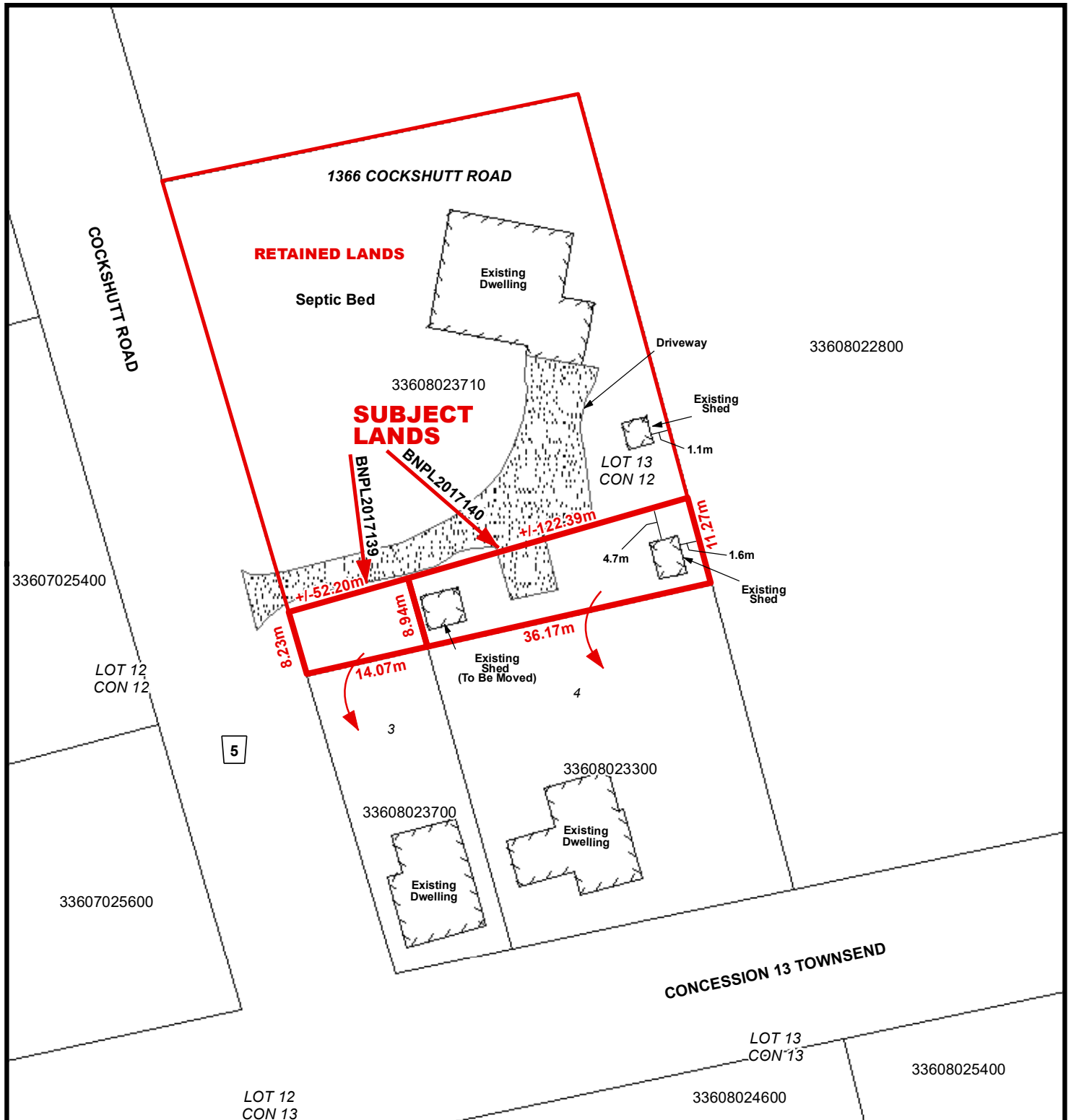



# Geographic Township of TOWNSEND

