

Committee of Adjustment Application for Consent

Complete Application

The application must be completed by the owner or authorized agent. If the application is being submitted by an agent, the owner's written authorization is required. If the lands subject to this application are owned by more than one owner, the authorization of all owners is required. Submission of this application constitutes consent for authorized municipal staff to inspect the subject lands.

It is the responsibility of the applicant to research and evaluate the site and the proposal to ensure that the development will conform to the interests of the health, safety and welfare of future residents. Sufficient studies for the completion of the application should be carried out prior to submission and should be reflected in the application form.

Before the application is submitted

A pre-consultation meeting is not required for Committee of Adjustment applications; however, further information can be provided by Planning Department staff prior to the submission of an application. The purpose of communicating with a planner before you submit your application is: to review the proposal / application, to discuss potential issues; and to determine the required supporting information and materials to be submitted with your application before it can be considered complete by staff.

Online Application Process

All applications must be submitted online via the County's CityView Portal. The portal can be accessed here: [Welcome - CityView Portal](#). The applicant will submit the materials required as part of a complete application. Once the County confirms receipt of a complete application, the applicant will be contacted and provided further direction for payment options.

User Fees

The planning application fee will be determined when the application can be deemed complete according to Norfolk County Community Planning user fees: [User Fees | Norfolk County](#)

Cash, debit, credit or cheque payable to Norfolk County in the amount set out in the user fees By-Law that will be accepted and deposited once the application has been deemed complete.

If the subject lands are located in an area that is regulated by either the Long Point Region Conservation Authority or by the Grand River Conservation Authority an additional fee will



be required if review by the applicable agency is deemed necessary. A separate cheque payable to the Long Point Region Conservation Authority or the Grand River Conservation Authority is required in accordance with their fee schedule at the time of submission.

Grand River Conservation Authority

[Plan Review fees | Grand River Conservation Authority](#)

Long Point Region Conservation Authority

[Planning Fees - Long Point Region Conservation Authority](#)

After the application is submitted

In order for the application to be deemed complete, all of the components noted above are required. The *Planning Act* permits up to 30 days to review and deem an application complete.

Once the application has been deemed complete by the Planning Department, it is then circulated to public agencies and County departments for review and comment. A sign is provided that is required to be posted on the subject lands summarizing the application and identifying the committee meeting date. The comments received from members of the community will be included in the planning report and given consideration.

Additional studies required as part of the complete application shall be at the sole expense of the applicant. Any required peer reviews shall be at the expense of the applicant. The peer reviewer shall be selected by the County.

If the application is withdrawn prior to the circulation to commenting agencies, the entire original fee will be refunded. If withdrawn after the circulation to agencies, half the original fee will be refunded. No refund is available after the public meeting and/or approval of application.

Notification Sign Requirements

Planning Department staff may post a notification sign on your property in advance of the public meeting on your behalf. Please keep this sign posted until you have received a notice in the mail indicating that the Secretary Treasurer received no appeals.

It is the applicant's responsibility to ensure that the sign is correctly posted within the statutory timeframes, according to the *Planning Act*. Failure to post a sign in advance of the public meeting in accordance with statutory requirements will impact the timing of the Committee of Adjustment meeting. Applicants are responsible for removing the sign following the appeal period. The signs are recyclable and can be placed in your blue box.

Contact Us

For additional information or assistance in completing this application, please contact a planner at 519-426-5870 ext. 8159 or coa@norfolkcounty.ca



For Office Use Only:

File Number	_____	Application Fee	_____
Related File Number	_____	Conservation Authority Fee	_____
Pre-consultation Meeting	_____	Well & Septic Info Provided	_____
Application Submitted	_____	Planner	_____
Complete Application	_____	Public Notice Sign	_____

Check the type of planning application(s) you are submitting.

- ☐ Consent/Severance
- ☐ Surplus Farm Dwelling Consent/Severance
- ☐ Boundary Adjustment/Land Conveyance
- ☐ Easement/Right-of-Way Severance

Property Assessment Roll Number: _____

A. Applicant Information

Name of Owner _____

It is the responsibility of the owner or applicant to notify the planner of any changes in ownership within 30 days of such a change.

Address _____

Town and Postal Code _____

Phone Number _____

Cell Number _____

Email _____

Name of Authorized Applicant _____

Address _____

Town and Postal Code _____

Phone Number _____

Cell Number _____

Email _____



Name of Authorized Agent

Address

Town and Postal Code

Phone Number

Cell Number

Email

Please specify to whom all communications should be sent. Unless otherwise directed, all correspondence and notices in respect of this application will be forwarded to the owner and agent noted above.

☐ Owner

☐ Agent

☐ Applicant

Names and addresses of any holder of any mortgages, charges or other encumbrances on the subject lands:

B. Location, Legal Description and Property Information

1. Legal Description (include Geographic Township, Concession Number, Lot Number, Block Number and Urban Area or Hamlet):

Municipal Civic Address: _____

Land acquisition date (if known): _____

Present Official Plan Designation(s): _____

Present Zoning: _____

2. Is there a special provision or site specific zone on the subject lands?

☐ Yes ☐ No

If yes, please specify:

3. Present use of the subject lands:

4. Please describe **all existing and proposed** buildings and structures on the proposed **severed and retained lots** and whether they are to be retained, demolished or removed.

	Severed lot	Retained lot
Number of Existing Buildings/Structures	<hr/>	<hr/>
Number of Storey(s) for Existing Buildings/Structures	<hr/>	<hr/>
Number of Proposed Buildings/Structures	<hr/>	<hr/>
Number of Storey(s) for Proposed Buildings/Structures	<hr/>	<hr/>
Number of Dwelling Units per lot	<hr/>	<hr/>

5. Are any existing buildings on the subject lands designated under the *Ontario Heritage Act* as being architecturally and/or historically significant?

Yes ☐ No ☐

If yes, identify and provide details of the building:

6. If known, the length of time the existing uses have continued on the subject lands:

7. Existing use of abutting properties:

8. Does this proposal require a minor variance application? ☐ Yes ☐ No

9. Are there any easements or restrictive covenants affecting the subject lands?

☐ Yes ☐ No

If yes, describe the easement or restrictive covenant and its effect:

C. Zoning Review (chart must be completed in metric units)

	Zoning By-law Requirement	Proposed	
		Severed lot	Retained lot
Lot area (sq.m.)			
Lot frontage (m)			
Lot depth (m)			
Front Yard Setback (m)			
Left Side Yard Setback (m)			
Right Side Yard Setback (m)			
Rear Yard Setback (m)			
Exterior side yard (if applicable) (m)			
Height (m)			
Lot coverage (%)			
Number of parking spaces			

Number of new lots to be created (not including retained lot): _____

Please provide a separate table if more than one severed lot is being proposed.

i. Boundary Adjustment

1. Proposed final lot size and frontage of the benefitting lot _____

2. Identify the assessment roll number and property owner of the lands to which the lands will be conveyed:



ii. **Easement/Right-of-Way Request(s)**

Width (m)	_____	_____
Depth (m)	_____	_____
Area (sq.m.)	_____	_____
Lot/Part number over which the easement is required (must be identified on sketch)	_____ _____ _____	_____ _____ _____
Purpose of easement	_____ _____	_____ _____

iii. **Surplus Farm Dwelling Severances Only:** List all properties in Norfolk County, which are owned and farmed by the applicant and involved in the farm operation.

Owners Name: _____

Roll Number: _____

Total Acreage: _____

Workable Acreage: _____

Existing Farm Type: (for example: corn, orchard, livestock) _____

Dwelling Present?: ☐ Yes ☐ No If yes, year dwelling built _____

Date of Land Purchase: _____

Owners Name: _____

Roll Number: _____

Total Acreage: _____

Workable Acreage: _____

Existing Farm Type: (for example: corn, orchard, livestock) _____

Dwelling Present?: ☐ Yes ☐ No If yes, year dwelling built _____

Date of Land Purchase: _____



Owners Name: _____
Roll Number: _____
Total Acreage: _____
Workable Acreage: _____
Existing Farm Type: (for example: corn, orchard, livestock) _____
Dwelling Present?: ☐ Yes ☐ No If yes, year dwelling built _____
Date of Land Purchase: _____

Owners Name: _____
Roll Number: _____
Total Acreage: _____
Workable Acreage: _____
Existing Farm Type: (for example: corn, orchard, livestock) _____
Dwelling Present?: ☐ Yes ☐ No If yes, year dwelling built _____
Date of Land Purchase: _____

Owners Name: _____
Roll Number: _____
Total Acreage: _____
Workable Acreage: _____
Existing Farm Type: (for example: corn, orchard, livestock) _____
Dwelling Present?: ☐ Yes ☐ No If yes, year dwelling built _____
Date of Land Purchase: _____

Note: If additional space is needed, please attach a separate sheet.

D. Previous Use of the Property

1. Has there been an industrial or commercial use on the subject lands or adjacent lands?

☐ Yes ☐ No ☐ Unknown

If yes, specify the uses (for example: gas station, or petroleum storage):

2. Is there reason to believe the subject lands may have been contaminated by former uses on the site or adjacent sites?

☐ Yes ☐ No ☐ Unknown

3. If you answered yes to any of the above questions in Section D, a previous use inventory showing all known former uses of the subject lands, or if appropriate, the adjacent lands, is needed. Is the previous use inventory attached?

☐ Yes ☐ No

E. Provincial Policy

1. Is the requested amendment consistent with the Provincial Planning Statements issued under subsection 3(1) of the *Planning Act, R.S.O. 1990, c. P. 13*?

☐ Yes ☐ No

If you answered no, please explain:

2. It is the owner's responsibility to be aware of and comply with all relevant federal or provincial legislation, municipal by-laws or other agency approvals, including the Endangered Species Act, 2007. Have the subject lands been screened to ensure that development or site alteration will not have any impact on the habitat for endangered or threatened species further to the provincial policy statement ?

☐ Yes ☐ No

If you answered no, please explain:

3. Have the subject lands been screened to ensure that development or site alteration will not have any impact on source water protection?

☐ Yes ☐ No

If you answered no, please
explain: _____

4. Are any of the following uses or features on the subject lands or within 500 metres of the subject lands ? Please check boxes, if applicable.

Livestock facility or stockyard

☐ On the subject lands or ☐ within 500 meters – distance _____

Significant Woodland

☐ On the subject lands or ☐ within 500 meters – distance _____

Municipal Landfill

☐ On the subject lands or ☐ within 500 meters – distance _____

Sewage treatment plant or waste stabilization plant

☐ On the subject lands or ☐ within 500 meters – distance _____

Provincially Significant Wetland or other environmental feature

☐ On the subject lands or ☐ within 500 meters – distance _____

Floodplain

☐ On the subject lands or ☐ within 500 meters – distance _____

Rehabilitated mine site

☐ On the subject lands or ☐ within 500 meters – distance _____

Non-operating mine site within one kilometre

☐ On the subject lands or ☐ within 500 meters – distance _____

Active mine site within one kilometre

☐ On the subject lands or ☐ within 500 meters – distance _____

Industrial or commercial use (specify the use(s))

☐ On the subject lands or ☐ within 500 meters – distance _____

Active railway line

☐ On the subject lands or ☐ within 500 meters – distance _____

Seasonal wetness of lands

☐ On the subject lands or ☐ within 500 meters – distance _____

Erosion

☐ On the subject lands or ☐ within 500 meters – distance _____

Abandoned gas wells

☐ On the subject lands or ☐ within 500 meters – distance _____

F. Servicing and Access

Indicate what services are available or proposed:

Water Supply

- | | |
|--|---|
| <input type="checkbox"/> Municipal piped water | <input type="checkbox"/> Communal wells |
| <input type="checkbox"/> Individual wells | <input type="checkbox"/> Other (describe below) |
-

Sewage Treatment

- | | |
|---|---|
| <input type="checkbox"/> Municipal sewers | <input type="checkbox"/> Communal system |
| <input type="checkbox"/> Septic tank and tile bed in good working order | <input type="checkbox"/> Other (describe below) |
-

Storm Drainage

- | | |
|---|---------------------------------------|
| <input type="checkbox"/> Storm sewers | <input type="checkbox"/> Open ditches |
| <input type="checkbox"/> Other (describe below) | |
-

Existing or proposed access to subject lands:

- | | |
|---|---|
| <input type="checkbox"/> Municipal road | <input type="checkbox"/> Provincial highway |
| <input type="checkbox"/> Unopened road | <input type="checkbox"/> Other (describe below) |

Name of road/street:

G. Other Information

Is there any other information that you think may be useful in the review of this application? If so, explain below or attach on a separate page.

H. Supporting Material to be submitted by Applicant

In order for your application to be considered complete, folded hard copies and an electronic version of the site plan drawings, additional plans, studies and reports will be required in addition to a sketch plan in accordance with [Ontario regulation 197/96](#).

i) Sketch in Metric Units

A sketch showing the following, in metric units:

- a) the boundaries and dimensions of any land abutting the subject land that is owned by the owner of the subject land;
- b) the boundaries and dimensions of the subject land, the part that is intended to be severed and the part that is intended to be retained;
- c) the location of all land previously severed from the parcel originally acquired by the current owner of the subject land;
- d) the approximate location, to the best of your knowledge, of all natural and artificial features (*for example, buildings, railways, roads, watercourses, drainage ditches, banks of rivers or streams, wetlands, wooded areas, wells and septic tanks*);
- e) the current uses of land that is adjacent to the subject land (*for example, residential, agricultural or commercial*);
- f) the location, width and name of any roads within or abutting the subject land, indicating whether it is an unopened road allowance, a public travelled road, a private road or a right of way;
- g) the location and nature of any easement affecting the subject land; and
- h) location and setbacks of septic system and well from all existing and proposed lot lines, and all existing and proposed structures.

ii) Technical studies

The following additional plans, studies and reports, including but not limited to, may also be required as part of the complete application submission.

- a) Environmental Impact Study
- b) On-Site Sewage Disposal System Evaluation Form
- c) Geotechnical Study
- d) Hydrogeological Review
- e) Minimum Distance Separation Calculations



Development approvals might be subject to Ministry of Environment Conservation and Parks, Ministry of Transportation or other relevant federal or provincial legislation, municipal by-laws or other agency approvals.



I. Transfers, Easements and Postponement of Interest

The owner acknowledges and agrees that if required it is their solicitor's responsibility on behalf of the owner to undertake the registration of all transfer(s) of land to the County, and/or transfer(s) of easement in favour of the County and/or utilities. The owner further acknowledges and agrees that it is their solicitor's responsibility on behalf of the owner to undertake the registration of postponements of any charges in favour of the County.

Permission to Enter Subject Lands

Permission is hereby granted to Norfolk County officers, employees or agents, to enter the premises subject to this application for the purposes of making inspections associated with this application, during normal and reasonable working hours.

Freedom of Information

For the purposes of the *Municipal Freedom of Information and Protection of Privacy Act*, I authorize and consent to the use by or the disclosure to any person or public body any information that is collected under the authority of the *Planning Act, R.S.O. 1990, c. P. 13* for the purposes of processing this application.

Owner/Applicant/Agent Signature

Date

J. Owner's Authorization

If the authorized applicant/agent is not the registered owner of the lands that is the subject of this application, the owner must complete the authorization set out below.

I/We _____ am/are the registered owner(s) of the lands that is the subject of this application.

I/We authorize _____ to make this application on my/our behalf and to provide any of my/our personal information necessary for the processing of this application. Moreover, this shall be your good and sufficient authorization for so doing.

Owner

Robert Stevenson

Owner

Date

Date

***Note:** If property is owned by an Ontario Ltd. Corporation, Articles of Incorporation are required to be attached to the application.



K. Declaration

I, _____ of _____

solemnly declare that:

all of the above statements and the statements contained in all of the exhibits transmitted herewith are true and I make this solemn declaration conscientiously believing it to be true and knowing that it is of the same force and effect as if made under oath and by virtue of *The Canada Evidence Act*.

Declared before me at:

Owner/Applicant/Agent Signature

In _____

This _____ day of _____

A.D., 20____

A Commissioner, etc.

SKETCH SHOWING
PROPOSED SEVERANCE
OF
LOT 7 & 8, BLOCK A
REGISTERED PLAN 19-B
NORFOLK COUNTY

SCALE: 1 : 200



DECEMBER 10, 2024

LOT 9
PIN 50262 - 0120 (LT)

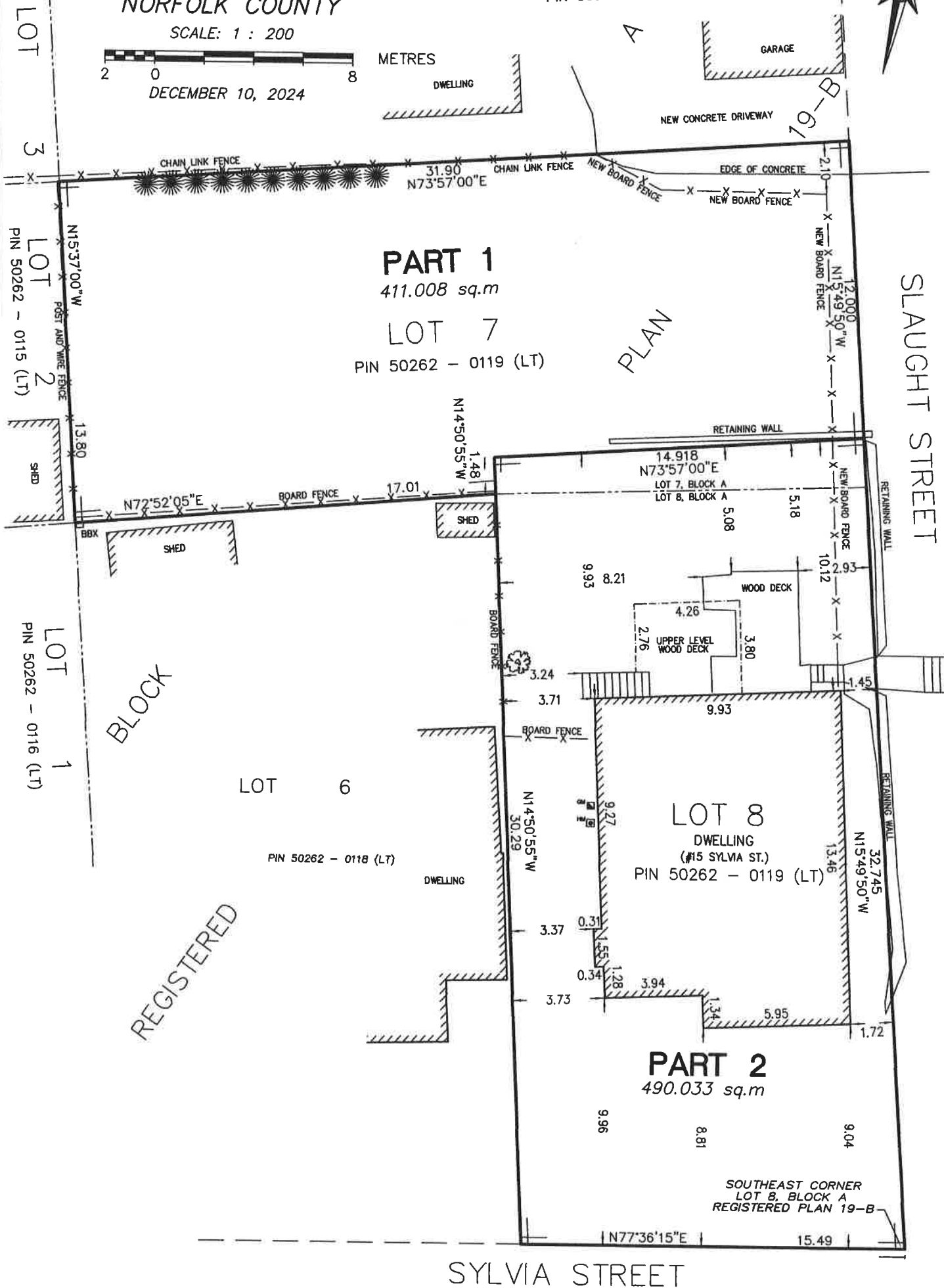

METRIC NOTE:

DISTANCES SHOWN ON THIS PLAN ARE IN METRES AND
CAN BE CONVERTED TO FEET BY DIVIDING BY 0.3048



COPYRIGHT 2024 JEWITT AND DIXON LTD.

THE REPRODUCTION, ALTERATION, OR USE OF
THIS REPORT IN WHOLE OR IN PART WITHOUT
THE WRITTEN PERMISSION OF JEWITT & DIXON LTD.
IS STRICTLY PROHIBITED.

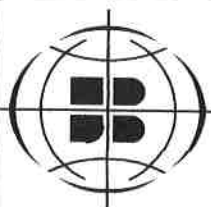

JEWITT AND DIXON

ONTARIO LAND SURVEYORS

A Division of Kim Husted Surveying Ltd.

SURVEYING
MAPPING
GIS

650 Ireland Rd., Simcoe, ON N3Y 4K2
T: (519) 426-0842 www.jdbarnes.com

DRAWN BY:

J.L.M.

CHECKED BY:

K.S.H.

REFERENCE NO.:

24-54-118-00

DATED: DECEMBER 10, 2024

MAP A
CONTEXT MAP
Urban Area of WATERFORD

BNPL2025340



Legend

-  Subject Lands
-  Lands Owned

2020 Air Photo

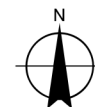

10/31/2025



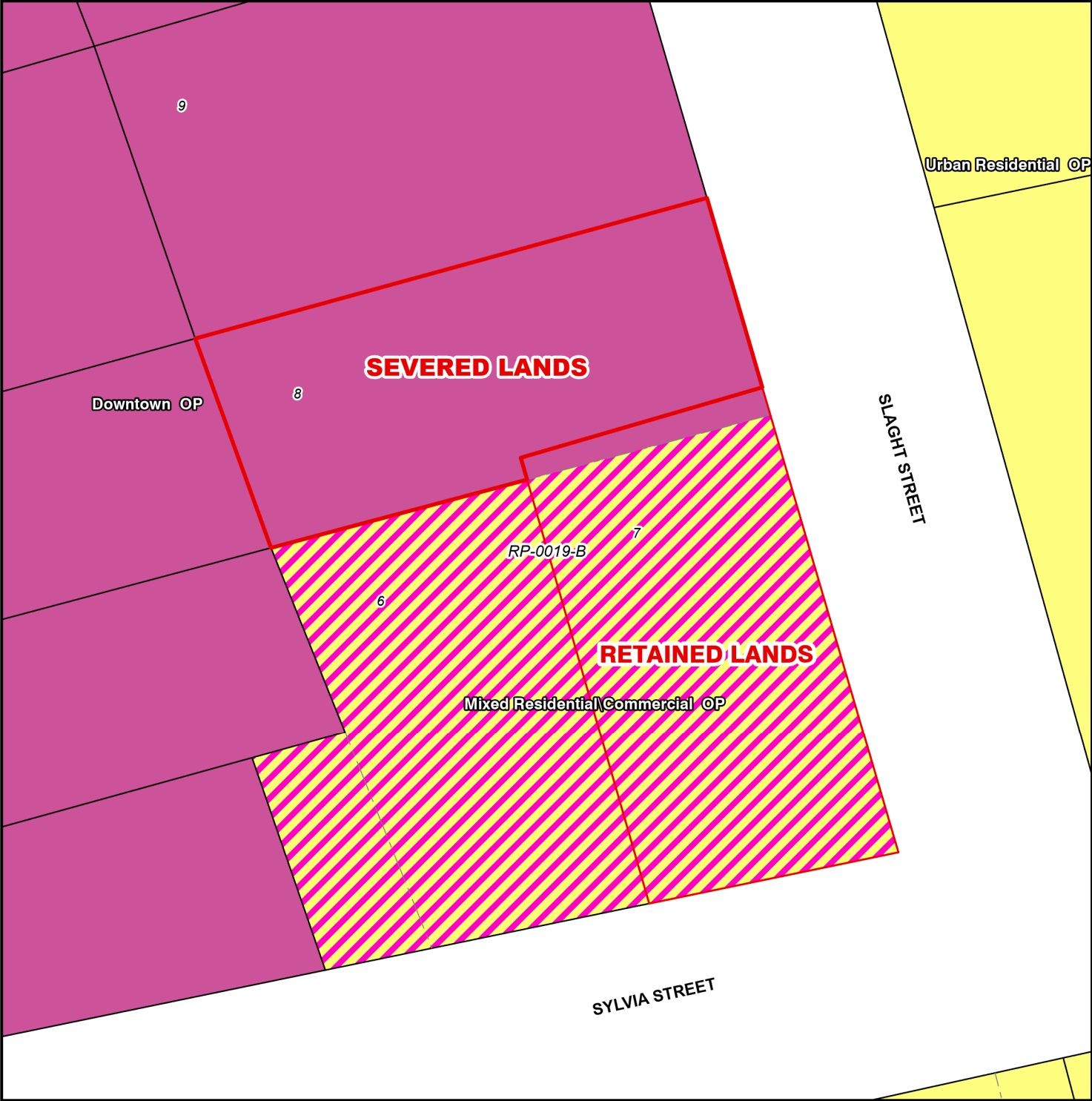



2.5 1.25 0 2.5 5 7.5 10 Meters



Legend

-  Subject Lands
-  Lands Owned

Official Plan Designations

-  Urban Residential
-  Mixed Residential\Commercial
-  Downtown
-  Urban Area Boundary

10/31/2025

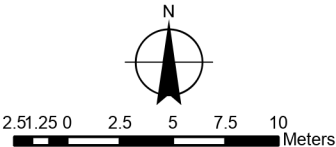

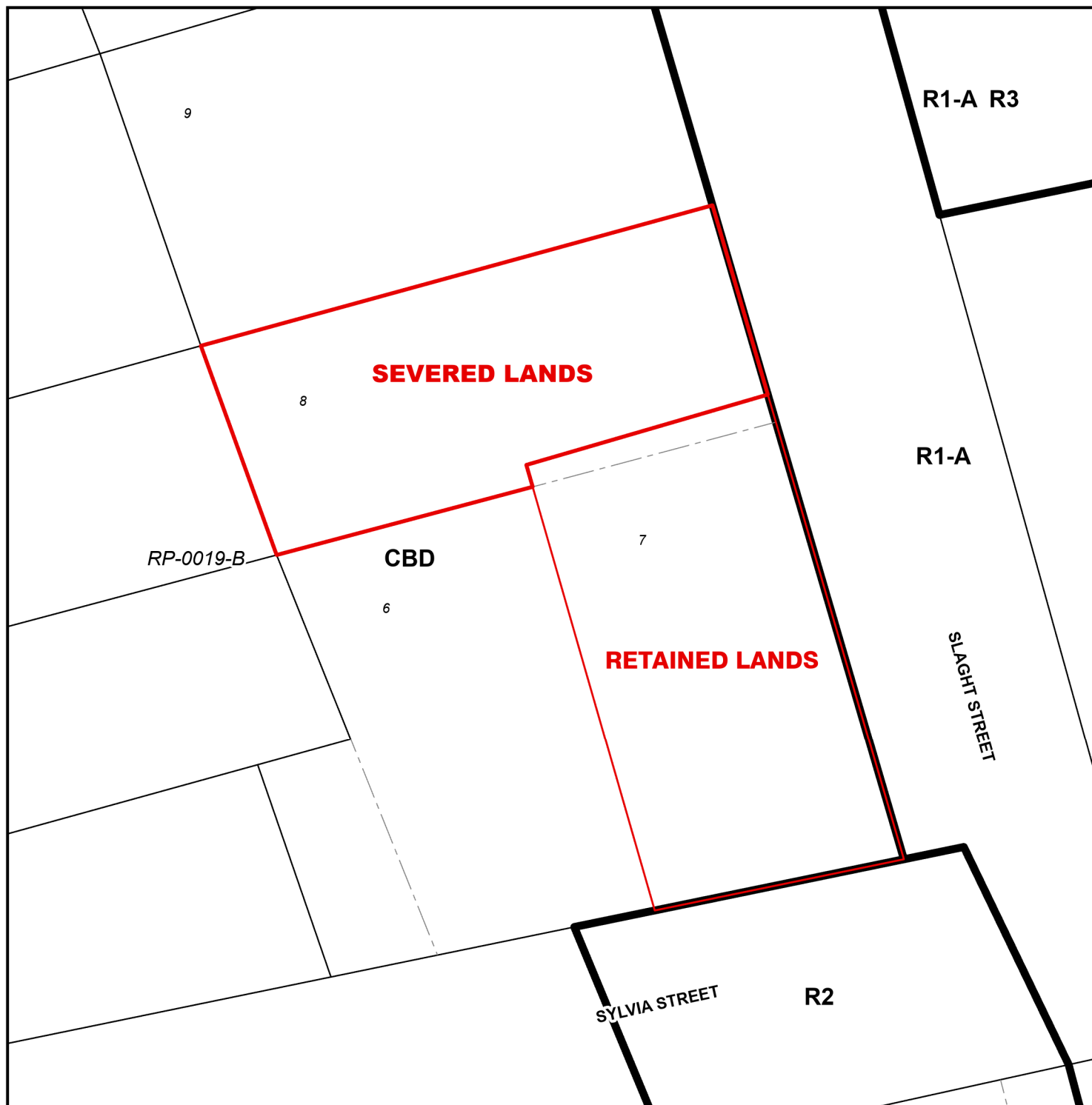

MAP C
ZONING BY-LAW MAP
Urban Area of WATERFORD

BNPL2025340



LEGEND

-  Subject Lands
-  Lands Owned

ZONING BY-LAW 1-Z-2014

10/31/2025

- (H) - Holding
- CBD - Central Business District Zone
- R1-A - Residential R1-A Zone
- R2 - Residential R2 Zone
- R3 - Residential R3 Zone

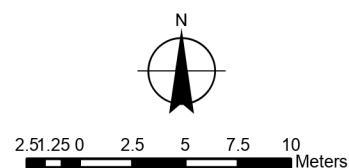

CONCEPTUAL PLAN

Urban Area of WATERFORD

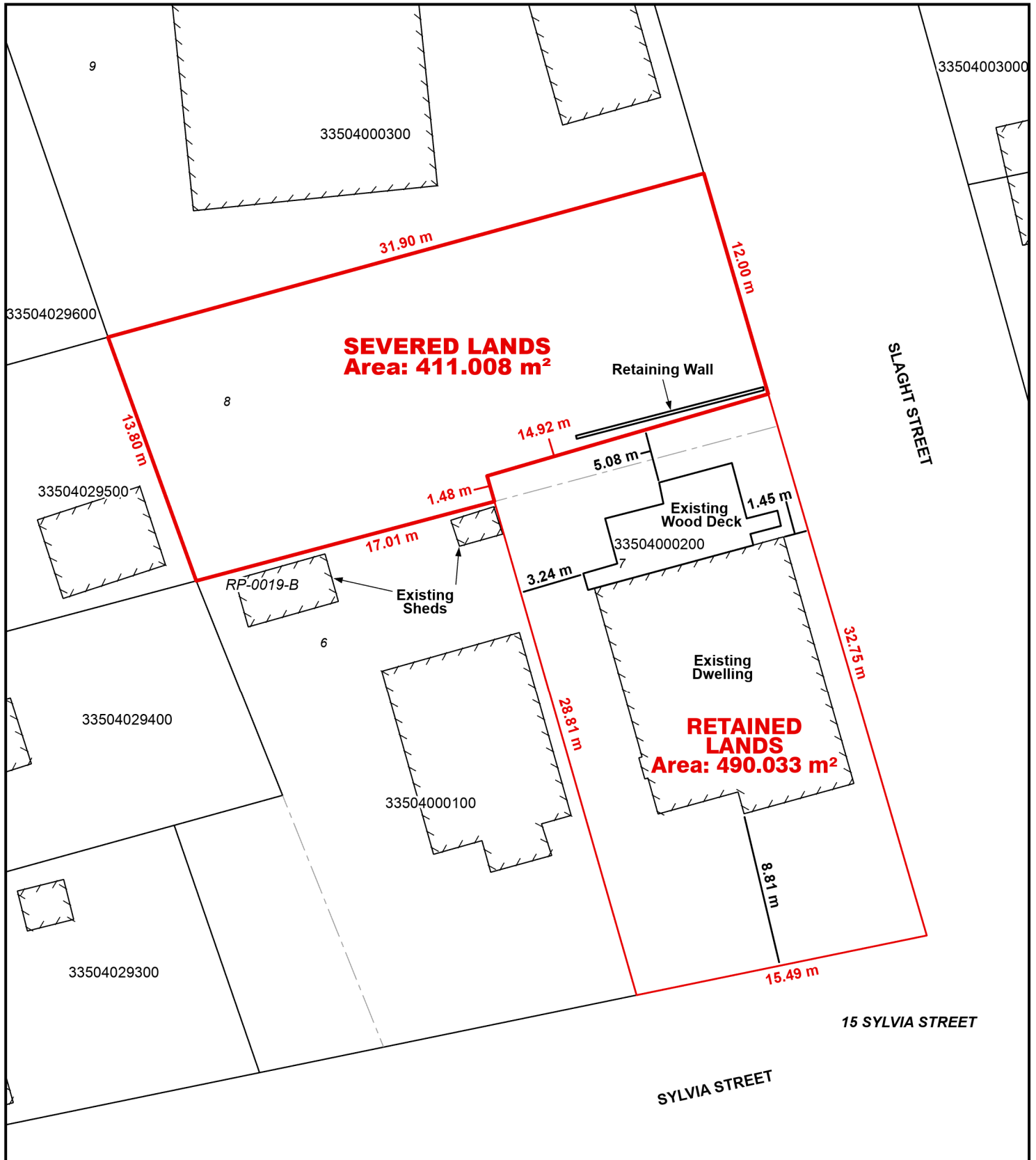

Legend

- Subject Lands
- Lands Owned

10/31/2025

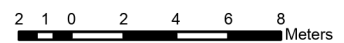
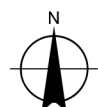

CONCEPTUAL PLAN

Urban Area of WATERFORD

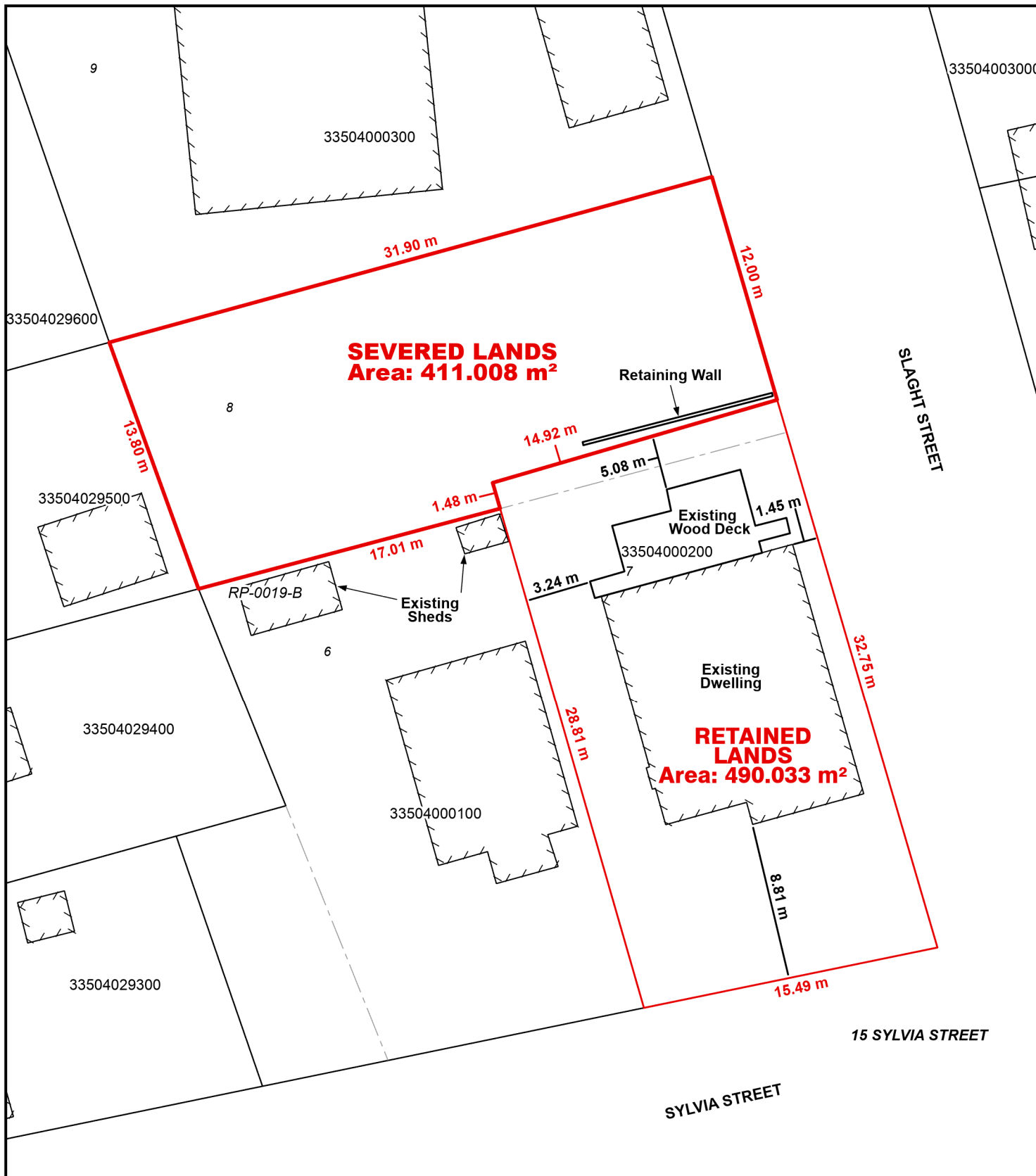

Legend

- Subject Lands
- Lands Owned

10/31/2025

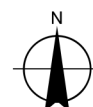

2 1 0 2 4 6 8 Meters