

**For Office Use Only:**

File Number	<u>ZNPL2017118</u>	SPRT Meeting	_____
Related File Number	<u>OPNPL20121804ZNPL2012-181</u>	Application Fee	_____
Pre-consultation Meeting	<u>N/A.</u>	Conservation Authority Fee	_____
Application Submitted	<u>JUNE 16-2017.</u>	OSSD Form Provided	_____
Complete Application	<u>JUNE 19-2017</u>	Planner	_____
Public Notice Sign	<u>N/A.</u>		

**Check the type of planning application(s) you are submitting.**

- |                                     |   |
|-------------------------------------|---|
| <input type="checkbox"/>            | Official Plan Amendment                               |
| <input checked="" type="checkbox"/> | Zoning By-Law Amendment    removal of Holding         |
| <input type="checkbox"/>            | Draft Plan of Subdivision/Vacant Land Condominium     |
| <input type="checkbox"/>            | Condominium Exemption                                 |
| <input type="checkbox"/>            | Site Plan Application                                 |
| <input type="checkbox"/>            | Consent/Severance                                     |
| <input type="checkbox"/>            | Minor Variance  |
| <input type="checkbox"/>            | Extension of a Temporary Use By-law                   |
| <input type="checkbox"/>            | Part Lot Control                                      |
| <input type="checkbox"/>            | Cash-in-Lieu of Parking                               |
| <input type="checkbox"/>            | Renewable Energy Project or Radio Communication Tower |

**Property Assessment Roll Number:** 3310 334 03063300**A. Applicant Information****Name of Owner** Jack Robillard

It is the responsibility of the owner or applicant to notify the planner of any changes in ownership within 30 days of such a change.

**Address** 61 Donjon Blvd.**Town and Postal Code** Port Dover, ON NOA 1N7**Phone Number** 519-774-3461**Cell Number** \_\_\_\_\_**Email** \_\_\_\_\_

<b>Name of Agent</b>	David Roe
<b>Address</b>	599 Larch St.
<b>Town and Postal Code</b>	Delhi, ON N4B 3A7
<b>Phone Number</b>	519-582-1174
<b>Cell Number</b>	
<b>Email</b>	dfrfez@bellnet.ca

Please specify to whom all communications should be sent. Unless otherwise directed, all correspondence, notices, etc., in respect of this application will be forwarded to the agent noted above.

☐ Owner ☒ Agent

Names and addresses of any holder of any mortgagees, charges or other encumbrances on the subject lands: none

## B. Location, Legal Description and Property Information

1. Legal Description (include Geographic Township, Concession Number, Lot Number, Block Number and Urban Area or Hamlet):

Port Dover, Lot 10, Plan 439

Municipal Civic Address: Jaylin Crescent

Present Official Plan Designation(s): Hazard Lands and Urban Residential

Present Zoning: R1-A R1-A(H) and HL

2. Is there a special provision or site specific zone on the subject lands?

☐ Yes ☒ No If yes, please specify:

3. The date the subject lands was acquired by the current owner:

4. Present use of the subject lands: vacant building lot

5. Please describe **all existing** buildings or structures on the subject lands and whether they are to be retained, demolished or removed. If retaining the buildings or structures, please describe the type of buildings or structures, and illustrate the setback, in metric units, from front, rear and side lot lines, ground floor area, gross floor area, lot coverage, number of storeys, width, length, height, etc. on your attached sketch which must be included with your application:

Vacant

6. If known, the date existing buildings or structures were constructed on the subject lands: \_\_\_\_\_
7. If an addition to an existing building is being proposed, please explain what will it be used for (e.g. bedroom, kitchen, bathroom, etc.). If new fixtures are proposed, please describe.
8. Please describe **all proposed** buildings or structures/additions on the subject lands. Describe the type of buildings or structures/additions, and illustrate the setback, in metric units, from front, rear and side lot lines, ground floor area, gross floor area, lot coverage, number of storeys, width, length, height, etc. on your attached sketch which must be included with your application:

Propose to building a new dwelling

9. If known, the date the proposed buildings or structures will be constructed on the subject lands:

2017

10. Are any existing buildings on the subject lands designated under the *Ontario Heritage Act* as being architecturally and/or historically significant? Yes ☐ No ☒

If yes, identify and provide details of the building:

11. If known, the length of time the existing uses have continued on the subject lands:

12. Existing use of abutting properties:

Marina on West side, River on North side, Dwelling on East  
Vacant lot on South side.

13. Are there any easements or restrictive covenants affecting the subject lands?

☐ Yes ☒ No If yes, describe the easement or restrictive covenant and its effect:

---

### C. Purpose of Development Application

Note: Please complete all that apply.

1. Please explain what you propose to do on the subject lands/premises which makes this development application necessary:

Request to remove holding provision

2. Please explain why it is not possible to comply with the provision(s) of the Zoning By-law/and or Official Plan:

By-law 15-Z-2013 outlines requirements to remove holding

3. Does the requested amendment alter all or any part of the boundary of an area of settlement in the municipality or implement a new area of settlement in the municipality? ☐ Yes ☒ No If yes, describe its effect:

4. Does the requested amendment remove the subject land from an area of employment? ☐ Yes ☒ No If yes, describe its effect:

5. Does the requested amendment alter, replace, or delete a policy of the Official Plan? ☐ Yes ☒ No If yes, identify the policy, and also include a proposed text of the policy amendment (if additional space is required, please attach a separate sheet):

6. Description of land intended to be severed in metric units: n / a
- Frontage: \_\_\_\_\_
- Depth: \_\_\_\_\_
- Width: \_\_\_\_\_
- Lot Area: \_\_\_\_\_
- Present Use: \_\_\_\_\_
- Proposed Use: \_\_\_\_\_
- Proposed final lot size (if boundary adjustment): \_\_\_\_\_
- Description of land intended to be retained in metric units: n / a
- Frontage: \_\_\_\_\_
- Depth: \_\_\_\_\_
- Width: \_\_\_\_\_
- Lot Area: \_\_\_\_\_
- Present Use: \_\_\_\_\_
- Proposed Use: \_\_\_\_\_
7. Description of proposed right-of-way/easement: n / a
- Frontage: \_\_\_\_\_
- Depth: \_\_\_\_\_
- Width: \_\_\_\_\_
- Area: \_\_\_\_\_
- Proposed use: \_\_\_\_\_
8. Name of person(s), if known, to whom lands or interest in lands to be transferred, leased or charged (if known):
- \_\_\_\_\_ n / a

**9. Site Information****Existing****Proposed**

Please indicate unit of measurement, i.e. m, m<sup>2</sup> or %, etc.

Lot frontage	30.1m	
Lot depth	54.9m & 60.6m	
Lot width	30.1m	
Lot area	1744m <sup>2</sup>	
Lot coverage		
Front yard		
Rear yard		
Left Interior side yard		
Right Interior side yard		
Exterior side yard (corner lot)		
Landscaped open space		
Entrance access width		
Exit access width		
Size of fencing or screening		
Type of fencing		

**10. Building Size**

Number of storeys		
Building height		
Total ground floor area		
Total gross floor area		
Total useable floor area		

**11. Off Street Parking and Loading Facilities**

Number of off street parking spaces	2	
Number of visitor parking spaces		
Number of accessible parking spaces		
Number of off street loading facilities		

**12. Multiple Family Residential (if applicable)** n/a

Number of buildings existing: \_\_\_\_\_

Number of buildings proposed: \_\_\_\_\_

Is this a conversion or addition to an existing building? ☐ Yes ☐ No

If yes, describe: \_\_\_\_\_

### Type

### Number of Units

### Floor Area per Unit in m<sup>2</sup>

Bachelor	_____	_____
One bedroom	_____	_____
Two bedroom	_____	_____
Three bedroom	_____	_____
Townhouse	_____	_____

Other facilities provided (e.g. play facilities, underground parking, games room, swimming pool etc.):

### 13. Commercial/Industrial Uses (if applicable) n/a

Number of buildings existing: \_\_\_\_\_

Number of buildings proposed: \_\_\_\_\_

Is this a conversion or addition to an existing building? ☐ Yes ☐ No

If yes, describe:

Indicate the gross floor area by the type of use (e.g. office, retail, storage, etc.):

Seating Capacity (for assembly halls, etc.): \_\_\_\_\_

Total number of fixed seats: \_\_\_\_\_

Describe the type of business(es) proposed: \_\_\_\_\_

Total number of staff proposed initially: \_\_\_\_\_

Total number of staff proposed in five years: \_\_\_\_\_

Maximum number of staff on the largest shift: \_\_\_\_\_

Is open storage required: ☐ Yes ☐ No

Is a residential use proposed as part of, or accessory to commercial/industrial use?

☐ Yes ☐ No If yes please describe:

**14. Institutional (if applicable)** n / a

Describe the type of use proposed: \_\_\_\_\_

Seating capacity (if applicable): \_\_\_\_\_

Number of beds (if applicable): \_\_\_\_\_

Total number of staff proposed initially: \_\_\_\_\_

Total number of staff proposed in five years: \_\_\_\_\_

Maximum number of staff on the largest shift: \_\_\_\_\_

Indicate the gross floor area by the type of use (e.g. office, retail, storage, etc.):

**15. Describe Recreational or Other Use(s) (if applicable)** n / a



#### **D. Previous Use of the Property**

1. Has there been an industrial or commercial use on the subject lands or adjacent lands? ☐ Yes ☒ No ☐ Unknown

If yes, specify the uses (example: gas station, petroleum storage, etc.):

2. Has the grading of the subject lands been changed through excavation or the addition of earth or other material? ☐ Yes ☐ No ☒ Unknown
3. Is there reason to believe the subject lands may have been contaminated by former uses on the site or adjacent sites? ☐ Yes ☒ No ☐ Unknown

4. Provide the information you used to determine the answers to the above questions:

knowledge of owner

5. If you answered yes to any of the above questions in Section D, a previous use inventory showing all known former uses of the subject lands, or if appropriate, the adjacent lands, is needed. Is the previous use inventory attached? ☐ Yes ☒ No

## E. Provincial Policy

1. Is the requested amendment consistent with the provincial policy statements issued under subsection 3(1) of the *Planning Act, R.S.O. 1990, c. P. 13*? ☒ Yes ☐ No

If no, please explain:

2. It is owner's responsibility to be aware of and comply with all relevant federal or provincial legislation, municipal by-laws or other agency approvals, including the Endangered Species Act, 2007. Have the subject lands been screened to ensure that development or site alteration will not have any impact on the habitat for endangered or threatened species further to the provincial policy statement subsection 2.1.7? ☐ Yes ☒ No

If no, please explain:

Rezoning of lands took place in 2013

3. Have the subject lands been screened to ensure that development or site alteration will not have any impact on source water protection? ☒ Yes ☐ No

If no, please explain:

Note: If in an area of source water WHPA A, B or C please attach relevant information and approved mitigation measures from the Risk Manager Official.

4. Are any of the following uses or features on the subject lands or within 500 metres of the subject lands, unless otherwise specified? Please check boxes, if applicable.

**Livestock facility or stockyard** (submit MDS Calculation with application)

☐ On the subject lands or ☐ within 500 meters – distance \_\_\_\_\_

**Wooded area**

☐ On the subject lands or ☐ within 500 meters – distance \_\_\_\_\_

**Municipal Landfill**

☐ On the subject lands or ☐ within 500 meters – distance \_\_\_\_\_

**Sewage treatment plant or waste stabilization plant**

☐ On the subject lands or ☐ within 500 meters – distance \_\_\_\_\_

**Provincially significant wetland (class 1, 2 or 3) or other environmental feature**

☐ On the subject lands or ☐ within 500 meters – distance \_\_\_\_\_

**Floodplain**

☐ On the subject lands or ☐ within 500 meters – distance \_\_\_\_\_

**Rehabilitated mine site**

☐ On the subject lands or ☐ within 500 meters – distance \_\_\_\_\_

**Non-operating mine site within one kilometre**

☐ On the subject lands or ☐ within 500 meters – distance \_\_\_\_\_

**Active mine site within one kilometre**

☐ On the subject lands or ☐ within 500 meters – distance \_\_\_\_\_

**Industrial or commercial use (specify the use(s))**

☐ On the subject lands or ☒ within 500 meters – distance marina adj.

**Active railway line**

☐ On the subject lands or ☐ within 500 meters – distance \_\_\_\_\_

**Seasonal wetness of lands**

☐ On the subject lands or ☐ within 500 meters – distance \_\_\_\_\_

**Erosion**

☐ On the subject lands or ☐ within 500 meters – distance \_\_\_\_\_

**Abandoned gas wells**

☐ On the subject lands or ☐ within 500 meters – distance \_\_\_\_\_

## F. Servicing and Access

1. Indicate what services are available or proposed:

### Water Supply

- ☒ Municipal piped water  
☐ Communal wells  
☐ Individual wells  
☐ Other (describe below)
- 

### Sewage Treatment

- ☒ Municipal sewers  
☐ Communal system  
☐ Septic tank and tile bed  
☐ Other (describe below)
- 

### Storm Drainage

- ☒ Storm sewers  
☐ Open ditches  
☐ Other (describe below)
- 

2. Have you consulted with Public Works & Environmental Services concerning storm water management?

☒ Yes ☐ No

3. Has the existing drainage on the subject lands been altered?

☐ Yes ☒ No

4. Does a legal and adequate outlet for storm drainage exist?

☒ Yes ☐ No

5. How many water meters are required? one

6. Existing or proposed access to subject lands:

- ☒ Municipal road                      ☐ Provincial highway  
☐ Unopened road                      ☐ Other (describe below)

Name of road/street:

Jaylin Crescent

---

**G. Other Information**

1. Does the application involve a local business? ☐ Yes ☒ No  
If yes, how many people are employed on the subject lands?
- 

2. Is there any other information that you think may be useful in the review of this application? If so, explain below or attach on a separate page.

Development proposal was set out in OPNPL2012180  
ZNPL2012181 and staff report PED 13-13

By-law 15-Z-2013 set out requirements to remove H zoning

these include: LPRCA permit  
Council approval of revisions to  
Gallagher subdivision agreement for  
grading and SWM plan  
Upgrading of Jaylin Crescent  
Provision of municipal sewer & water  
for house on Lot 9 and new house on Lot 10

The owner is willing to complete agreement to meet these  
conditions as per staff report PED 13-33

## **H. Supporting Material to be submitted by Applicant**

In order for your application to be considered complete, folded hard copies (number of paper copies as directed by the planner) and an **electronic version (PDF) of the site plan drawings, additional plans, studies and reports** will be required, including but not limited to the following details:

1. Concept/Layout Plan
2. All measurements in metric
3. Key map
4. Scale, legend and north arrow
5. Legal description and municipal address
6. Development name
7. Drawing title, number, original date and revision dates
8. Owner's name, address and telephone number
9. Engineer's name, address and telephone number
10. Existing and proposed easements and right of ways
11. Zoning compliance table – required versus proposed
12. Parking space totals – required and proposed
13. Loading spaces, facilities and routes
14. All dimensions of the subject lands
15. Dimensions and setbacks of all buildings and structures
16. Gross, ground and useable floor area
17. Lot coverage
18. Floor area ratio
19. Building entrances and grades
20. Names of adjacent streets
21. Driveways, curbs, drop curbs, pavement markings, widths, radii and traffic directional signs
22. Fire access and routes
23. Location, dimensions and number of parking spaces (including visitor and accessible) and aisles
24. Location of mechanical room
25. Refuse disposal and storage areas including any related screening
26. Winter snow storage location
27. Landscape areas with dimensions
28. Natural features, watercourses and trees
29. Fire hydrants and utilities location
30. Fencing, screening and buffering – size, type and location
31. All hard surface materials
32. Light standards and wall mounted lights

33. Signs
34. Sidewalks and walkways with dimensions
35. Pedestrian access routes into site and around site
36. Bicycle parking
37. Professional engineer's stamp

In addition, the following additional plans, studies and reports, including but not limited to, **may** also be required as part of the complete application submission:

- ☐ Zoning Deficiency Form
- ☐ On-Site Sewage Disposal System Evaluation Form
- ☐ Architectural Plan
- ☐ Buildings Elevation Plan
- ☐ Cut and Fill Plan
- ☐ Erosion and Sediment Control Plan
- ☐ Grading and Drainage Control Plan (around perimeter and within site) (existing and proposed)
- ☐ Landscape Plan
- ☐ Photometric (Lighting) Plan
- ☐ Plan and Profile Drawings
- ☐ Site Servicing Plan
- ☐ Storm water Management Plan
- ☐ Street Sign and Traffic Plan
- ☐ Street Tree Planting Plan
- ☐ Tree Preservation Plan
- ☐ Archaeological Assessment
- ☐ Environmental Impact Study
- ☐ Functional Servicing Report
- ☐ Geotechnical Study / Hydrogeological Review
- ☐ Minimum Distance Separation Schedule
- ☐ Noise or Vibration Study
- ☐ Record of Site Condition
- ☐ Storm water Management Report

- ☐ Traffic Impact Study – please contact the Planner to verify the scope of the study required

Standard condominium exemptions will require the following supporting materials:

- ☐ Plan of standard condominium (2 paper copies and 1 electronic copy)
- ☐ Draft condominium declaration

Your development approval might also be dependent on Ministry of Environment and Climate Change, Ministry of Transportation or other relevant federal or provincial legislation, municipal by-laws or other agency approvals.

**All final plans must include the owner's signature as well as the engineer's signature and seal.**

### **I. Development Agreements**

A development agreement may be required prior to approval for site plan, subdivision and condominium applications. Should this be necessary for your development, you will be contacted by the agreement administrator with further details of the requirements including but not limited to insurance coverage, professional liability for your engineer, additional fees and securities.

### **J. Transfers, Easements and Postponement of Interest**

The owner acknowledges and agrees that if required it is their solicitor's responsibility on behalf of the owner for the registration of all transfer(s) of land to the County, and/or transfer(s) of easement in favour of the County and/or utilities. Also, the owner further acknowledges and agrees that it is their solicitor's responsibility on behalf of the owner for the registration of postponements of any charges in favour of the County.

  
Owner/Applicant Signature

  
Date

### **K. Permission to Enter Subject Lands**

Permission is hereby granted to Norfolk County officers, employees or agents, to enter the premises subject to this application for the purposes of making inspections associated with this application, during normal and reasonable working hours.

  
Owner/Applicant Signature

  
Date



## L. Freedom of Information

For the purposes of the *Municipal Freedom of Information and Protection of Privacy Act*, I authorize and consent to the use by or the disclosure to any person or public body any information that is collected under the authority of the *Planning Act, R.S.O. 1990, c. P. 13* for the purposes of processing this application.

---

Owner/Applicant Signature

---

Date

## M. Owner's Authorization

If the applicant/agent is not the registered owner of the lands that is the subject of this application, the owner must complete the authorization set out below.

I/We Jack Robillard am/are the registered owner(s) of the lands that is the subject of this application for site plan approval.

I/We authorize David Roe to make this application on my/our behalf and to provide any of my/our personal information necessary for the processing of this application. Moreover, this shall be your good and sufficient authorization for so doing.

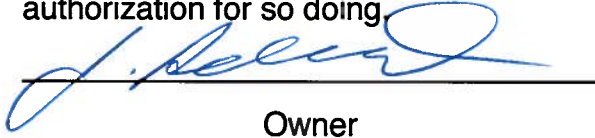
  
Owner

MAY 23/17  
Date

---

Owner

---

Date

## N. Declaration of Applicant and Agent

I hereby apply for development approval and declare that all of the above statements and the statements contained in all of the exhibits transmitted herewith are accurate and true. I understand that site plan approval is required before a building permit can be issued.

  
Applicant Signature

MAY 23/17  
Date

---

Agent Signature

---

Date

**O. Declaration**

I, DAvid Roe of Norfolk County

solemnly declare that:

all of the above statements and the statements contained in all of the exhibits transmitted herewith are true and I make this solemn declaration conscientiously believing it to be true and knowing that it is of the same force and effect as if made under oath and by virtue of *The Canada Evidence Act*.

Declared before me at:

County Administration Building

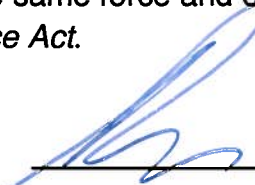

Owner/Applicant Signature

In Simcoe

This 6 day of June

Shannon Nichole Van Dalen, a  
Commissioner, etc., Province of Ontario,  
for the Corporation of Norfolk County.  
Expires November 5, 2018.

A.D., 20 17.

  
A Commissioner, etc.

# MAP NORFOLK - Community Web Map

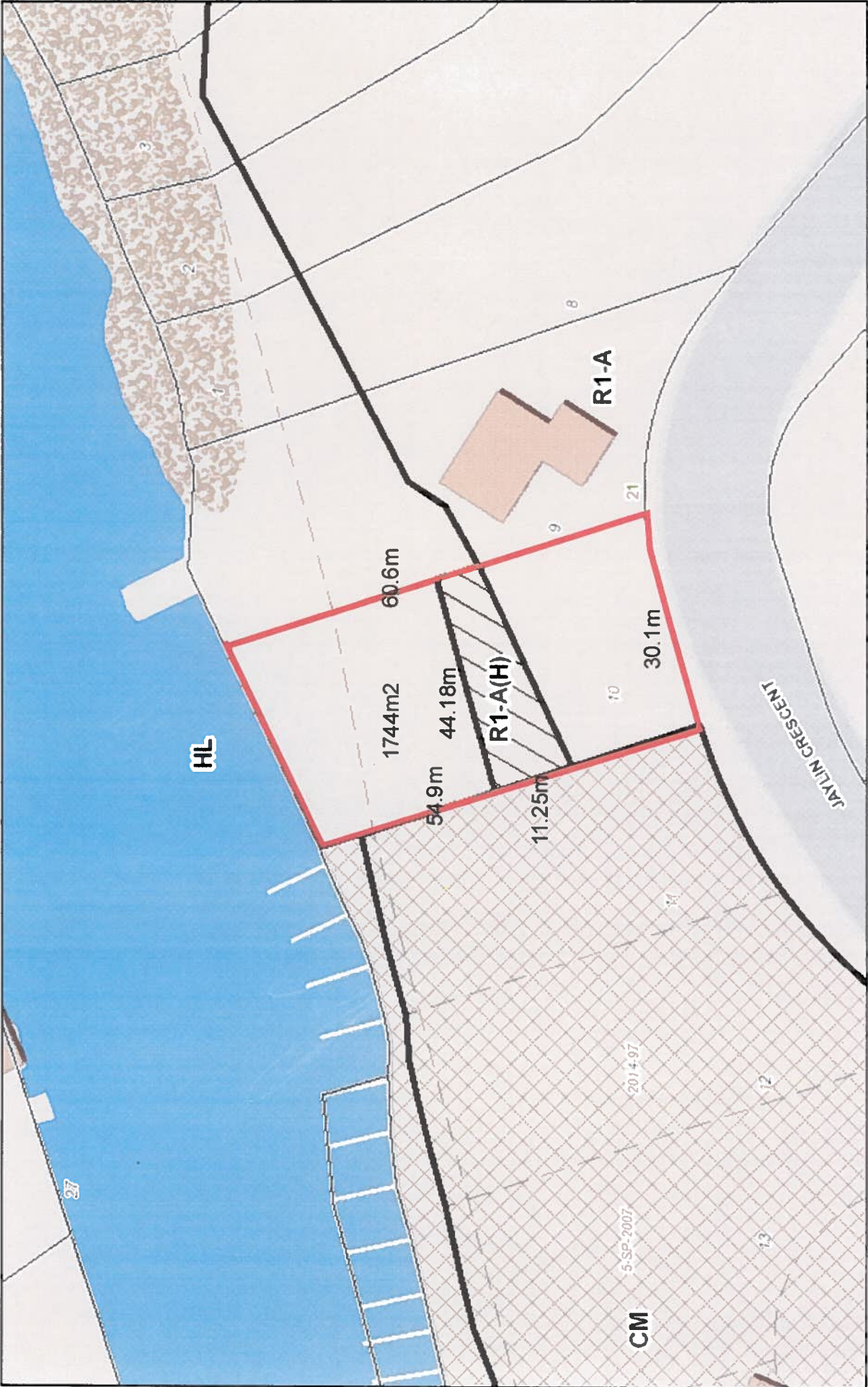

May 17, 2017

Zones 1-Z-2014



Special Provisions



Land Parcels



Plan Lines

1:750

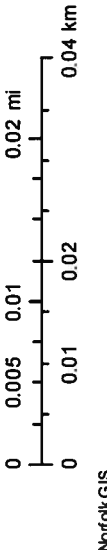



**MAP 1**  
**File Number: ZNPL2017118**  
Urban Area of  
**PORT DOVER**

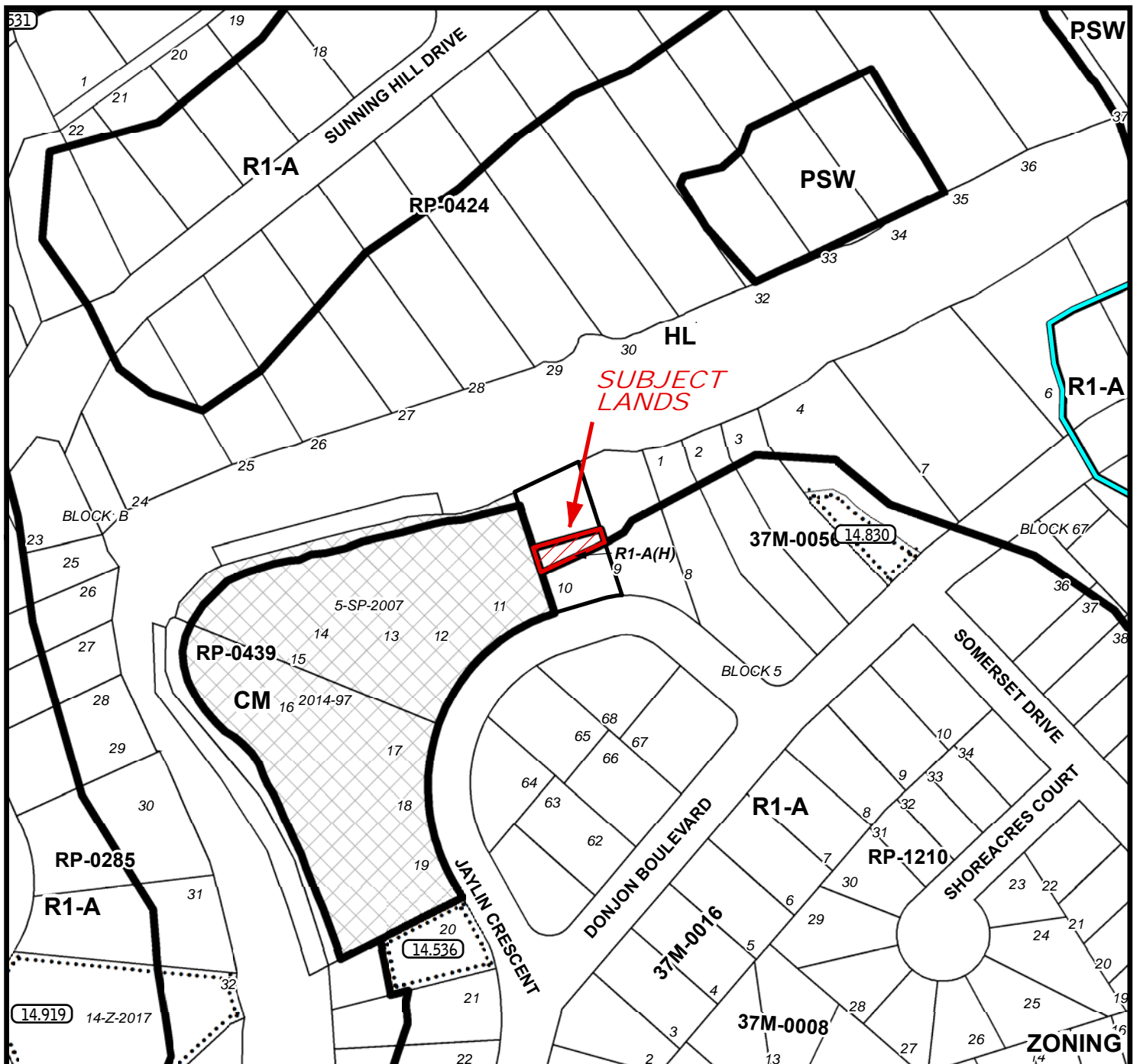
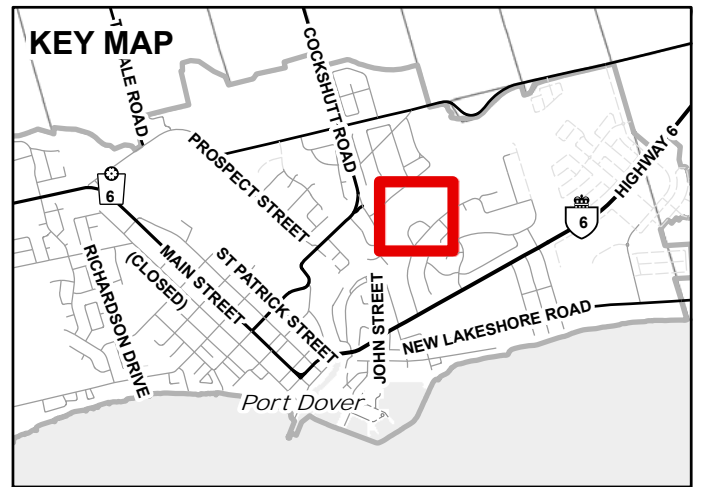
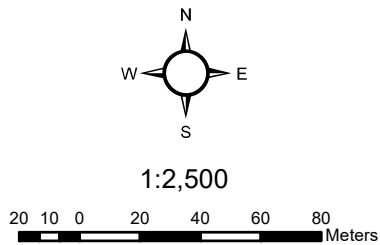

# MAP 2

File Number: ZNPL2017118

Urban Area of PORT DOVER

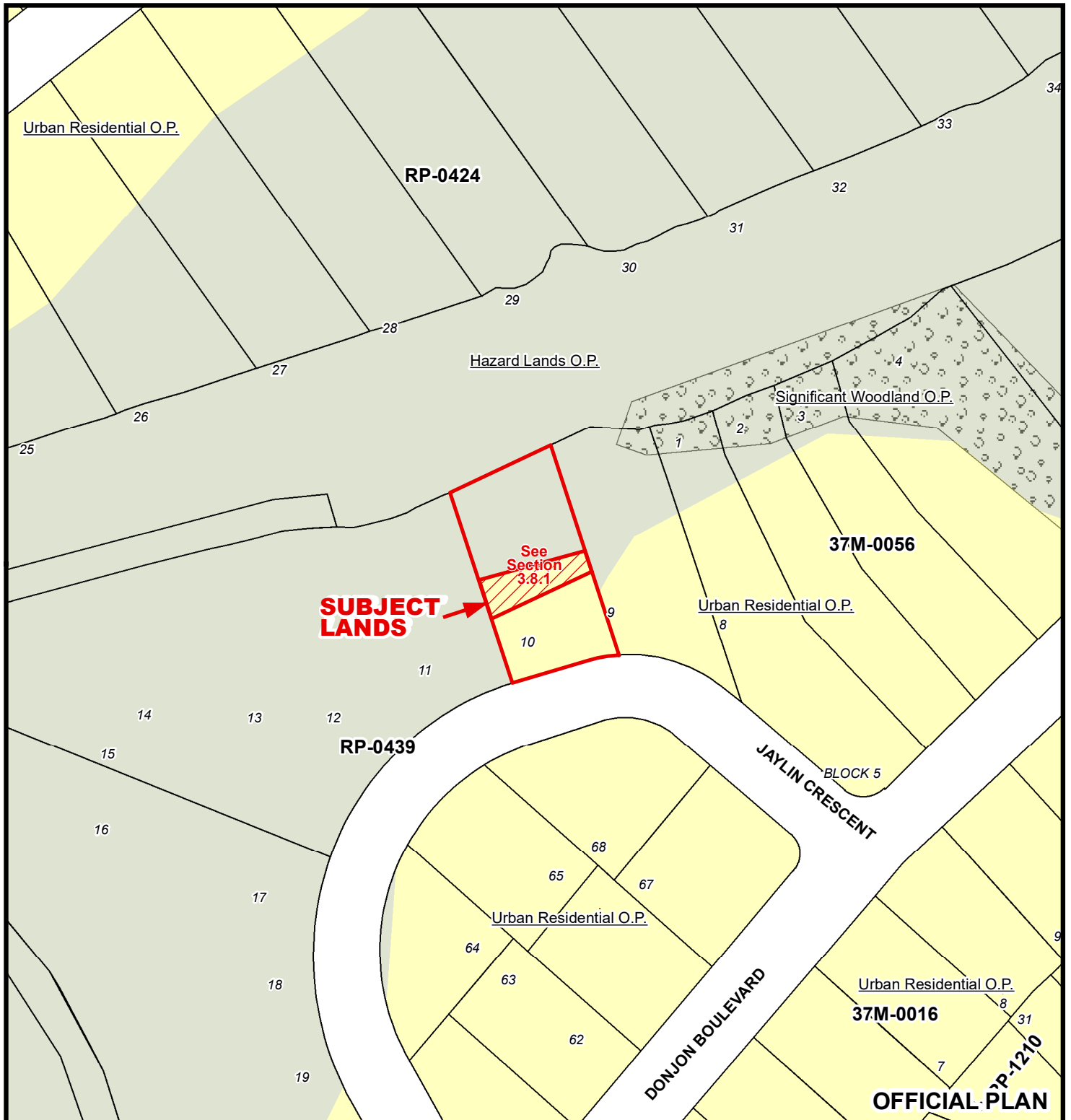
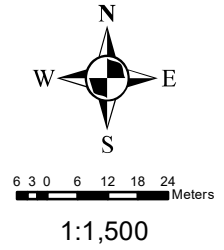



# MAP 3

File Number: ZNPL2017118

Urban Area of PORT DOVER

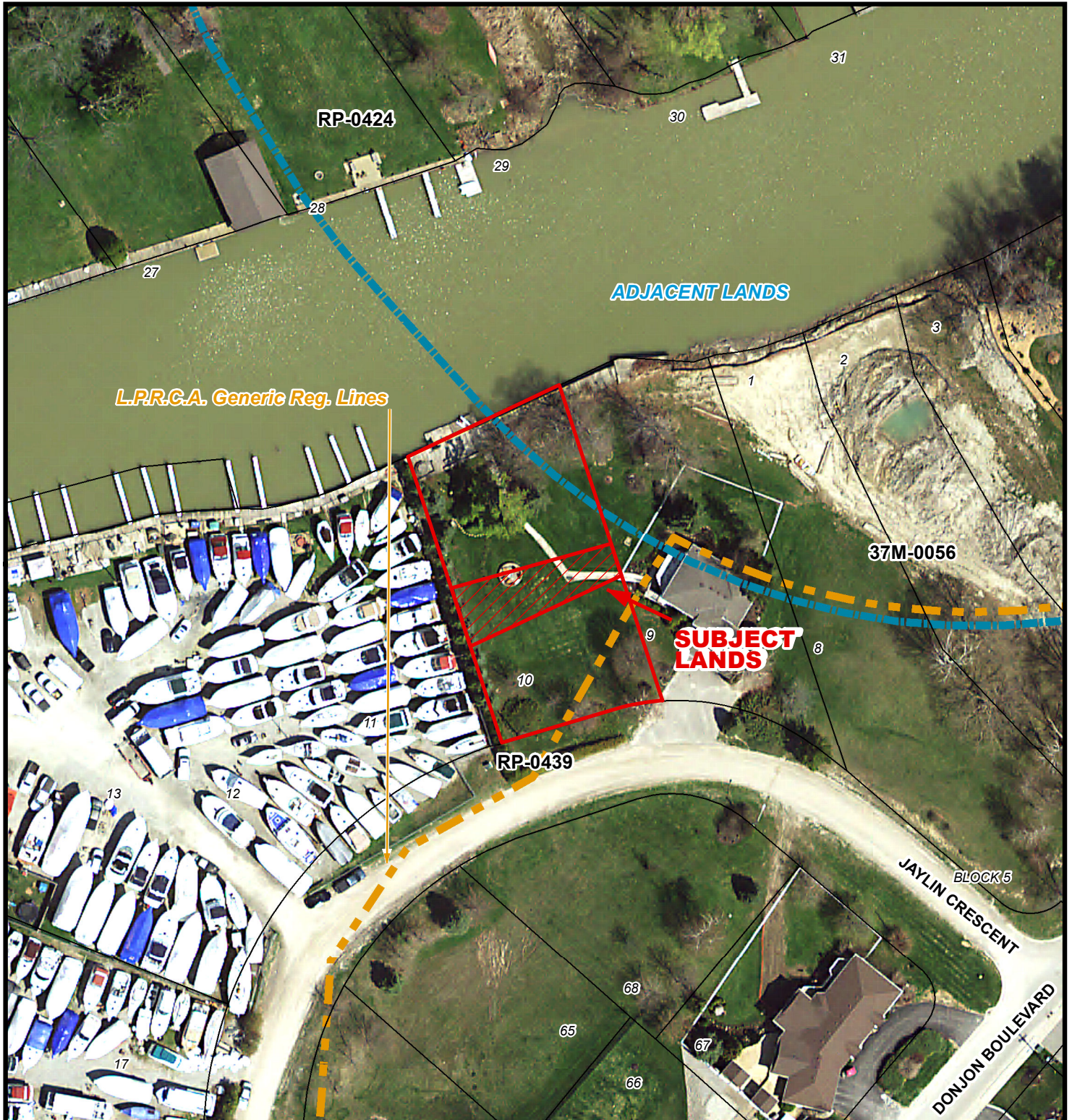
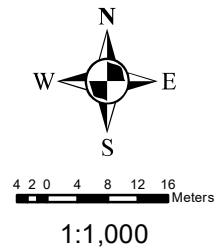



# MAP 4

File Number: ZNPL2017118

Urban Area of PORT DOVER

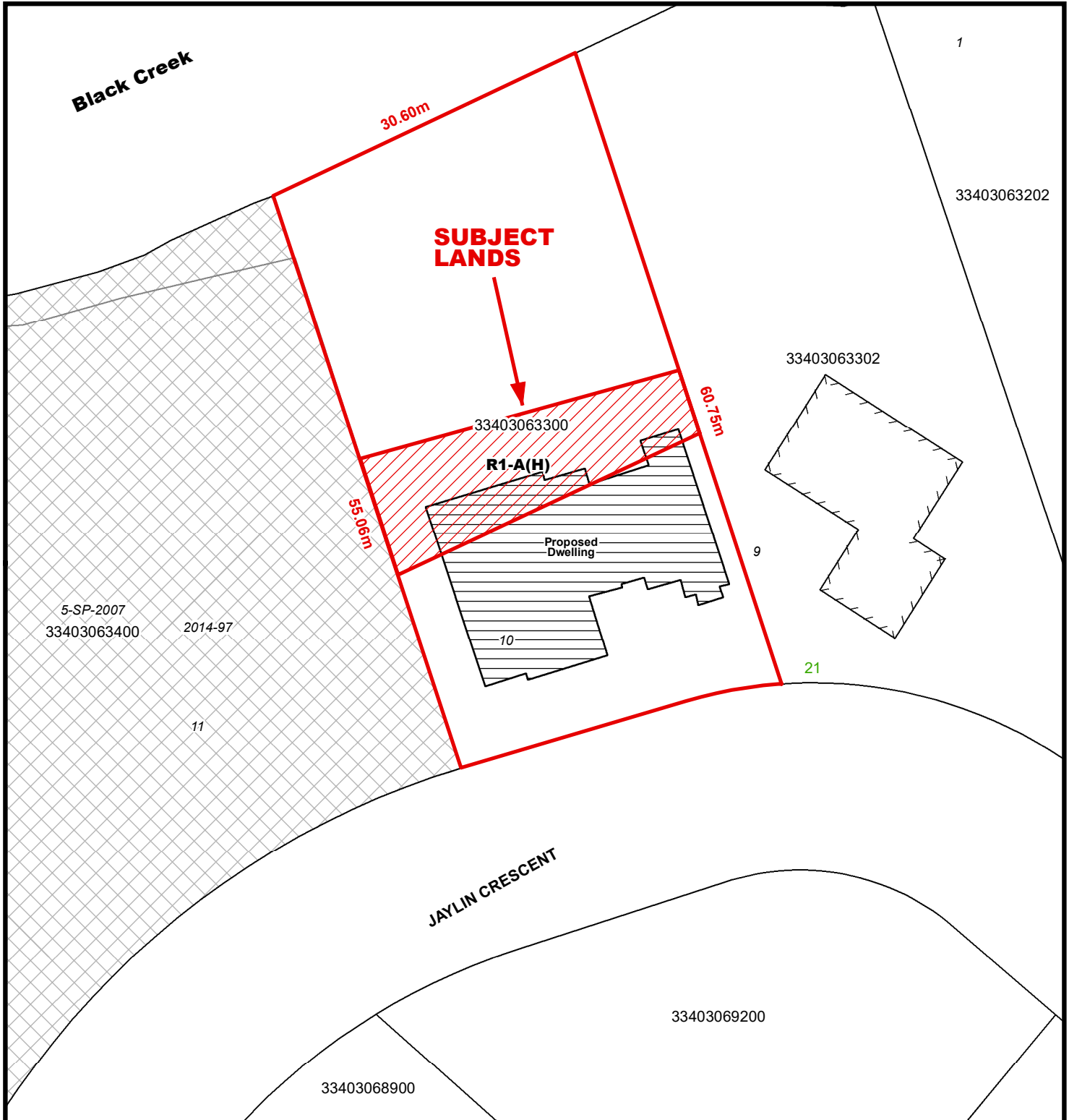
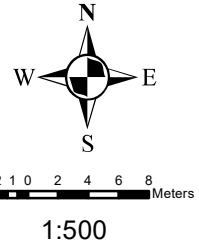

# LOCATION OF LANDS AFFECTED

File Number: ZNPL2017118

Urban Area of PORT DOVER

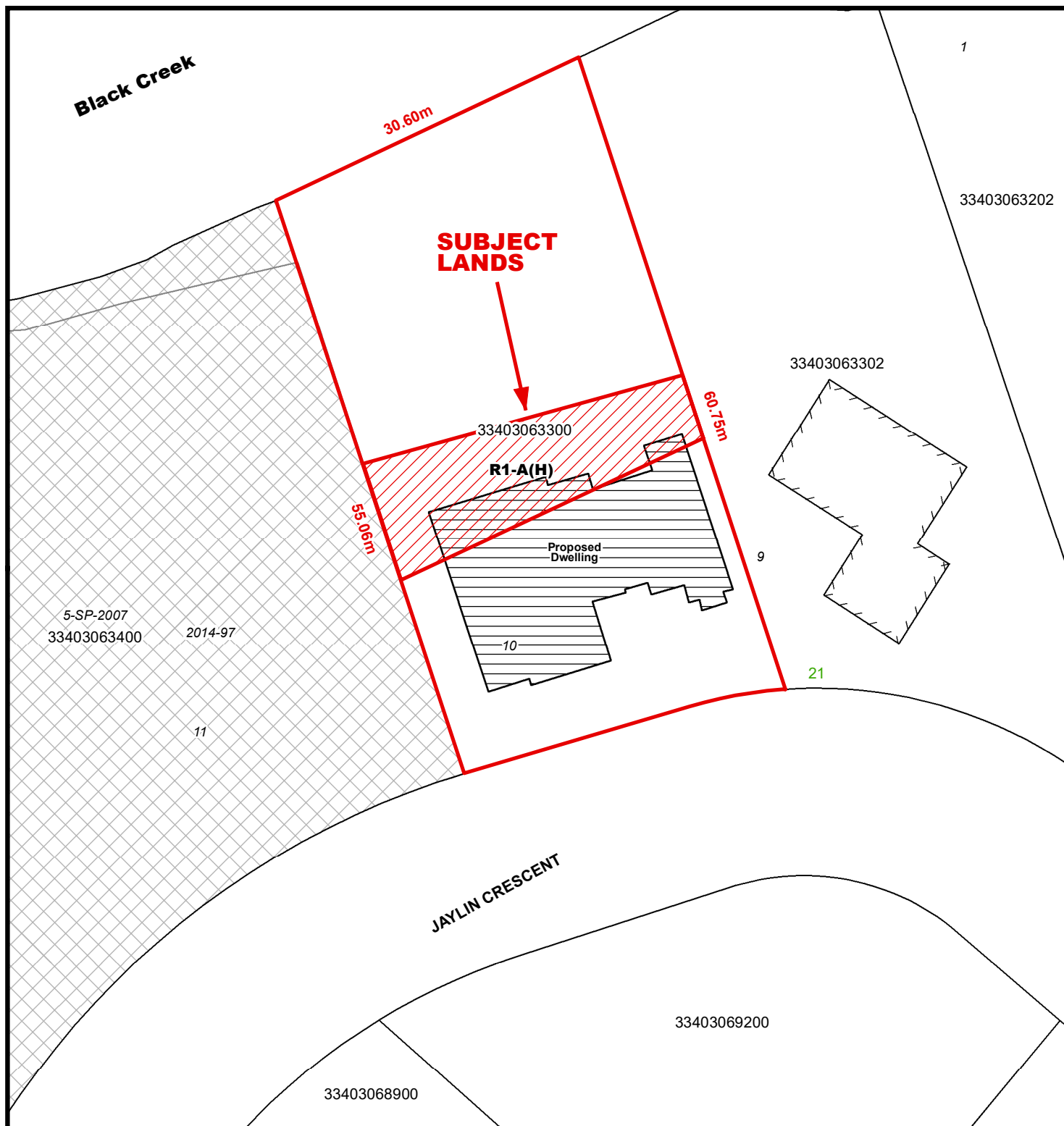
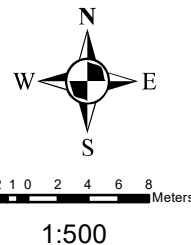



# Norfolk County

## Urban Area of Port Dover

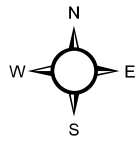

1:750

9 4.5 0 9 18 27 36 Meters

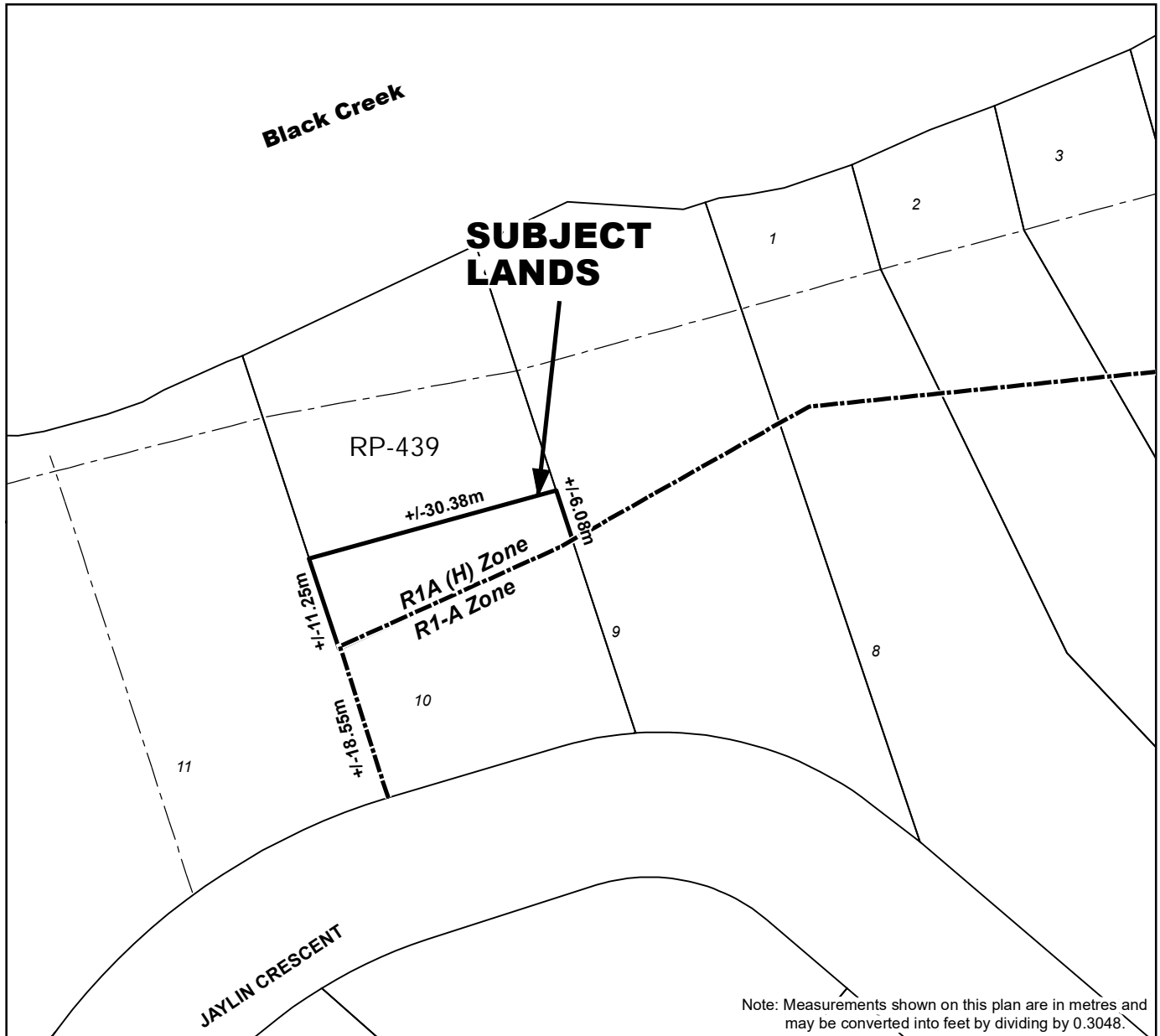
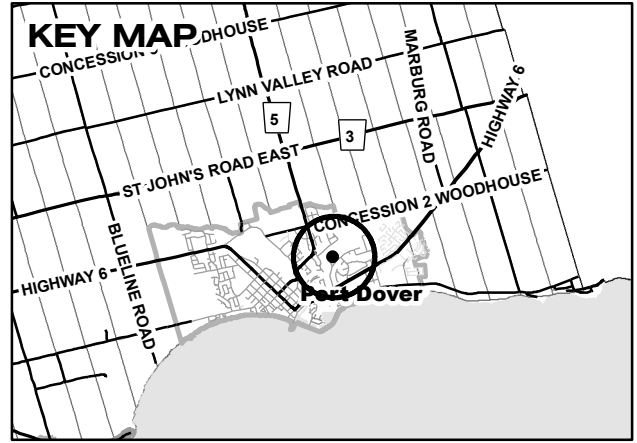

This is Map A to Zoning By-law \_\_\_\_\_ Passed the \_\_\_\_\_ day of \_\_\_\_\_ 2017.

MAYOR

CLERK